

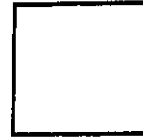

Type

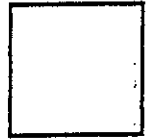

Docs



Plans

2PE10-0012

Building Permit Number

1

Street Number

COUNTYWIDE

Street Name

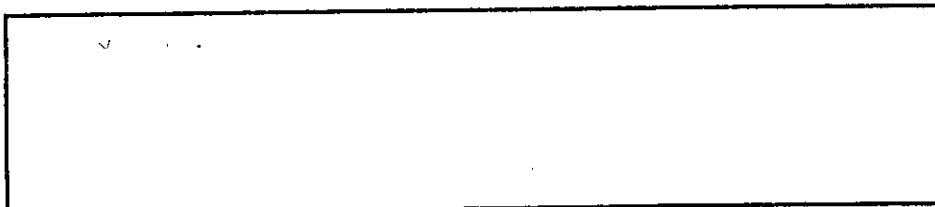

Community Code

000-000-001

APN

COUNTY OF SONOMA
PERMIT AND RESOURCE MANAGEMENT DEPARTMENT
2550 VENTURA AVENUE, SANTA ROSA, CA 95403-2829
(707) 565-1900 FAX (707) 565-1103

PCAS # 6146

Application Fees / Invoice for: ZPE10-0012

Project Address: 1 COUNTYWIDE COU

Cross Street:

APN: 000-000-001

Description: SPECIAL EVENT ZONING PERMIT

Printed: Friday, April 09, 2010
Initialized by: AWINGFIE
Activity Type: B-ZPE 901
PCAS #:

Owner: PUBLIC JOHN Q
111 MAIN ST
ANYWHERE CA

Applicant: PEREZ CARLOS
PO BOX 5318
SANTA ROSA CA
95402
707 478 9034

Fees:

Item#	Description	Account Code	Tot Fee	Prev. Pmts	Cur. Pmts
334	EH REVIEW PUB SEW & WAT	025015-3355	181.00	.00	.00
1052	ENV REV CEQA EXEMPT DET	025015-3811	33.00	.00	.00
1160	ZONING PERMITS W/POSTING	025015-3830	1,126.00	.00	.00
			\$1,340.00	\$0.00	

Total Fees: \$1,340.00

Total Paid: \$0.00

Balance Due: \$1,340.00

Refunds will not be authorized unless circumstances
comply with established PRMD refund policy provisions.

When validated below, this is your receipt.

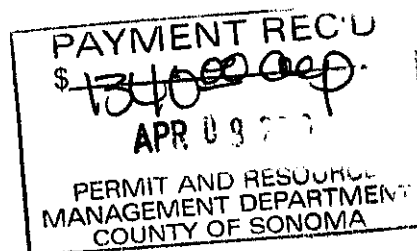

Zoning Permit Application

PJR-004

- ☐ Ag. Employee Dwelling Unit
☐ Biotic Resource
☐ Confined Livestock
☐ Daycare-Large Family
☐ Home Occupation
☐ Horse Boarding

- ☐ Landmarks Commission
☐ Minor Timberland Conversion
☐ Mobile Home
☐ Non-conforming Uses
☐ Second Units
☐ Setback Averaging/Reduction

- ☒ Special Events
☐ Telecommunications Facility
☐ Other _____

File#: 2PE10-0012

Applicant (Contact Person):

Name Carlos Perez
Mailing Address PO Box 5318
City/Town Santa Rosa State CA Zip 954012
Phone 707.478.9034 Fax 707.540.6210
Email LOS@BikeMonkey.net
Signature [Signature] Date 1/16/2010

Owner, if other than Applicant:

Name _____
Mailing Address _____
City/Town _____ State _____ Zip _____
Phone _____ Fax _____
Email See indemnification agreements
Signature _____ Date _____

Other Persons to be Notified: (Specify: Agent, Lender, Architect or Engineer)

Name	Name	Name
Mailing Address	Mailing Address	Mailing Address
City/Town State Zip	City/Town State Zip	City/Town State Zip
Title	Title	Title
Phone Fax	Phone Fax	Phone Fax
Email	Email	Email

Project Information:

Address(es) See attached route map City/Town CAZADERO
Assessor's Parcel Number(s) 109-260-021 + 106-090-011
Project Description: GRAN FONDO Bike Race on October 9, 2010
(Please attach additional sheet(s) if needed)

Site Served by Public Water? ☐ Yes ☒ No Site Served by Public Sewer? ☐ Yes ☒ No

I/we agree to comply with the attached performance standards/conditions.

Signature of Applicant [Signature]

Date 1/10/2010

DO NOT WRITE BELOW THIS LINE - To Be Completed by PRMD Staff

Zoning permit approved by:

Signature of Planner S

Date BR.F1.SR

Planning Area: _____ Supervisorial District: S Current Zoning: TP B6-240ac / LC General Plan Land Use: RRD 240 / LC

Specific Plan: _____ S.P. Land Use: _____ Needs CEQA Review? ☐ yes ☒ no

Violation? ☐ yes ☒ no; Application resolve planning violation? ☐ yes ☐ no; Penalty applicable? ☐ yes ☐ no; Civil Penalty Factor N/A

Previous Files: _____

Application accepted by Amy Wingler

Date Jan 19, 2010

Sonoma County Permit and Resource Management Department

2550 Ventura Avenue • Santa Rosa, CA • 95403-2829 • (707) 565-1900 • Fax (707) 565-1103

Zoning Permit Application

PJR-004

- ☐ Ag. Employee Dwelling Unit
☐ Biotic Resource
☐ Confined Livestock
☐ Daycare-Large Family
☐ Home Occupation
☐ Horse Boarding

- ☐ Landmarks Commission
☐ Minor Timberland Conversion
☐ Mobile Home
☐ Non-conforming Uses
☐ Second Units
☐ Setback Averaging/Reduction

- ☐ Special Events
☐ Telecommunications Facility
☐ Other _____

File#: ZPE.10-0012

Applicant (Contact Person):

Name Carlos Perez - Pike Monkey
 Mailing Address PO Box 5318
Santa Rosa CA 95402
 City/Town 707-478-9034 State CA Zip 95402
 Phone 707-640-6210 Fax 540
 Email los@pikemonkey.net
 Signature [Signature] Date 2 June 2010

Owner, if other than Applicant:

Name Russian River Poles Assoc.
 Mailing Address PO Box 103
Duncans Mills CA 95430
 City/Town 707-632-5715 State CA Zip 95430
 Phone just@polemountainoutdoors.com Fax 707-632-5715
 Email Justine Anderson Date 2 June 2010
 Signature _____ Date _____

Other Persons to be Notified: (Specify: Agent, Lender, Architect or Engineer)

Name _____	Name _____	Name _____
Mailing Address _____	Mailing Address _____	Mailing Address _____
City/Town _____ State _____ Zip _____	City/Town _____ State _____ Zip _____	City/Town _____ State _____ Zip _____
Title _____	Title _____	Title _____
Phone _____ Fax _____	Phone _____ Fax _____	Phone _____ Fax _____
Email _____	Email _____	Email _____

Project Information:

County-wide
 Address(es) 0916-170-006
 Assessor's Parcel Number(s) _____
 City/Town _____
 Acreage _____

Project Description: (Please attach additional sheets if needed)

Len Leiphemers King Ridge Gran Fondo

Site Served by Public Water? ☒ Yes ☐ No Site Served by Public Sewer? ☐ Yes ☐ No

I/we agree to comply with the attached performance standards/conditions.

Signature of Applicant _____ Date 2 June 2010

DO NOT WRITE BELOW THIS LINE - To Be Completed by PRMD Staff U

Zoning permit approved by: _____ Signature of Planner _____ Date _____

Planning Area: _____ Supervisorial District: _____ Current Zoning: _____ General Plan Land Use: _____

Specific Plan: _____ S.P. Land Use: _____ Needs CEQA Review? ☐ yes ☐ no

Violation? ☐ yes ☐ no; Application resolve planning violation? ☐ yes ☐ no; Penalty applicable? ☐ yes ☐ no; Civil Penalty Factor _____

Previous Files: _____ Date _____

Application accepted by _____ Date _____

Sonoma County Permit and Resource Management Department
 2550 Ventura Avenue ♦ Santa Rosa, CA ♦ 95403-2829 ♦ (707) 565-1900 ♦ Fax (707) 565-1103

FAX 707-540-6210

Indemnification Agreement

PJR-011

"As part of this application, applicant agrees to defend, indemnify, release and hold harmless the County, its agents, officers, attorneys, employees, boards and commissions from any claim, action or proceeding brought against any of the foregoing individuals or entities, the purpose of which is to attack, set aside, void or annul the approval of this application or the adoption of the environmental document which accompanies it. This indemnification shall include, but not be limited to, damages, costs, expenses, attorney fees or expert witness fees that may be asserted by any person or entity, including the applicant, arising out of or in conjunction with the approval of this application, whether or not there is concurrent passive or active negligence on the part of the County. If, for any reason any portion of this indemnification agreement is held to be void or unenforceable by a court of competent jurisdiction, the remainder of the agreement shall remain in full force and effect."

Applicant Name

Applicant Signature

Owner Name

Owner Signature

Date

File No.

NOTE: The purpose of the Indemnification Agreement is to allow the County to be held harmless in terms of potential legal costs and liabilities in conjunction with permit processing and approval.

Sonoma County Permit and Resource Management Department

2550 Ventura Avenue ♦ Santa Rosa, CA ♦ 95403-2829 ♦ (707) 565-1900 ♦ Fax (707) 565-1103

Indemnification Agreement

PJR-011

"As part of this application, applicant agrees to defend, indemnify, release and hold harmless the County, its agents, officers, attorneys, employees, boards and commissions from any claim, action or proceeding brought against any of the foregoing individuals or entities, the purpose of which is to attack, set aside, void or annul the approval of this application or the adoption of the environmental document which accompanies it. This indemnification shall include, but not be limited to, damages, costs, expenses, attorney fees or expert witness fees that may be asserted by any person or entity, including the applicant, arising out of or in conjunction with the approval of this application, whether or not there is concurrent passive or active negligence on the part of the County. If, for any reason any portion of this indemnification agreement is held to be void or unenforceable by a court of competent jurisdiction, the remainder of the agreement shall remain in full force and effect."

Carlos Perez
Applicant Name

[Signature]
Applicant Signature

Ellen A Richardson Epperson
Owner Name

Ellen A Richardson Epperson
Owner Signature

1/10/2010
Date

ZPE 10-0012
File No.

NOTE: The purpose of the Indemnification Agreement is to allow the County to be held harmless in terms of potential legal costs and liabilities in conjunction with permit processing and approval.

Indemnification Agreement

PJR-011

"As part of this application, applicant agrees to defend, indemnify, release and hold harmless the County, its agents, officers, attorneys, employees, boards and commissions from any claim, action or proceeding brought against any of the foregoing individuals or entities, the purpose of which is to attack, set aside, void or annul the approval of this application or the adoption of the environmental document which accompanies it. This indemnification shall include, but not be limited to, damages, costs, expenses, attorney fees or expert witness fees that may be asserted by any person or entity, including the applicant, arising out of or in conjunction with the approval of this application, whether or not there is concurrent passive or active negligence on the part of the County. If, for any reason any portion of this indemnification agreement is held to be void or unenforceable by a court of competent jurisdiction, the remainder of the agreement shall remain in full force and effect."

Carlos Perez
Applicant Name

Applicant Signature

Donald L. Berry
Owner Name

DONALD L. BERRY
Owner Signature

1/10/2010
Date

70763-0012
File No.

NOTE: The purpose of the Indemnification Agreement is to allow the County to be held harmless in terms of potential legal costs and liabilities in conjunction with permit processing and approval.

Indemnification Agreement

PJR-011

"As part of this application, applicant agrees to defend, indemnify, release and hold harmless the County, its agents, officers, attorneys, employees, boards and commissions from any claim, action or proceeding brought against any of the foregoing individuals or entities, the purpose of which is to attack, set aside, void or annul the approval of this application or the adoption of the environmental document which accompanies it. This indemnification shall include, but not be limited to, damages, costs, expenses, attorney fees or expert witness fees that may be asserted by any person or entity, including the applicant, arising out of or in conjunction with the approval of this application, whether or not there is concurrent passive or active negligence on the part of the County. If, for any reason any portion of this indemnification agreement is held to be void or unenforceable by a court of competent jurisdiction, the remainder of the agreement shall remain in full force and effect."

Carlos Perez

Applicant Name

[Signature]

Applicant Signature

FOR DUNCANS MILLS TRADING CO.

[Signature]

Owner Name

DAVID J. FERREIRA

Owner Signature

1/10/2010

Date

PRE 10-0012

File No.

NOTE: The purpose of the Indemnification Agreement is to allow the County to be held harmless in terms of potential legal costs and liabilities in conjunction with permit processing and approval.

Special Events/Cultural Events - Agency Approvals

PJR-025

Valo Street Inc.
 Applicant
Ken Leiphman's King Ridge Gran Fondo
 Event Title or type of event
Bicycling
 Activities included in event(s)

SPR 10-0012
 File No.
October 9th 2010 8^{AM}-6^{PM}
 Event(s) date(s) and hours
6,000
 Attendance at each event

Signatures from the following departments/agencies must be obtained prior to issuance of a Special/Cultural Event by the Permit and Resource Management Department (PRMD). If the application is approved, PRMD will issue a zoning permit specifying all conditions of approval. The applicant must comply with all conditions of approval.

PRMD Building Inspection 2550 Ventura Avenue Santa Rosa, CA 95403 TEL (707) 565-1900 FAX (707) 565-1972	Condition(s): <u>N/A</u> Signature _____ Date _____
PRMD Project Review Health Specialist (Porta-toilets, trash containers, noise) 2550 Ventura Avenue Santa Rosa, CA 95403 TEL (707) 565-1683 FAX (707) 565-1103	Condition(s): <u>See the attached conditions</u> <u>Jonathan Tracy</u> <u>2-24-10</u> Signature _____ Date _____
PRMD Encroachment Section (Public right-of-way) 2550 Ventura Avenue Santa Rosa, CA 95403 TEL (707) 565-3626 or 585-3845 FAX (707) 565-3313	Condition(s): <u>SEE SPR 10-0001</u> <u>SEE CAP FOR TRAFFIC CONTROL</u> <u>John Tracy</u> <u>1-19-10</u> Signature _____ Date _____
Sonoma County Environmental Health (Food preparation, service, handling) 475 Aviation Blvd., #220 Santa Rosa, CA 95403 TEL (707) 566-6565 FAX (707) 566-6525	Condition(s): <u>See attached conditions</u> <u>C. Ben</u> <u>3/5/10</u> Signature _____ Date _____
Fire Services/Local Fire District (Emergency Services) 2300 County Center Dr, Suite A221 Santa Rosa, CA 95403 TEL (707) 565-1152 FAX (707) 565-1172	Condition(s): <u>COMPLY W/ FIRE CODE REGULATIONS AND LOCAL CONDITIONS NOTED ON FIRE CODE PERMIT.</u> <u>R. M.</u> <u>2/25/2010</u> Signature _____ Date _____
Sonoma County Sheriff (Traffic, safety) 2796 Ventura Avenue Santa Rosa, CA 95403 TEL (707) 585-2511 FAX (707) 526-0403	Condition(s): <u>104 days 707.565.7396 2.25.10</u> Signature _____ Date _____
California Highway Patrol 8100 Labath Avenue Rohnert Park, CA 94928 TEL (707) 588-1400 FAX No FAX # 588-1404 Sgt. Mike	Condition(s): <u>REIMBURSABLE SERVICES</u> <u>AGREEMENT NEEDED</u> <u>[Signature]</u> <u>3/18/10</u> Signature _____ Date _____

Sonoma County Permit and Resource Management Department
 2550 Ventura Avenue ♦ Santa Rosa, CA ♦ 95403-2829 ♦ (707) 565-1900 ♦ Fax (707) 565-1103
 Sue Weisman S:\Handouts\PRMD\PJR-025 Special Events_Cultural Events_Agency Approvals.wpd Rev 04/25/06

Special Events/Cultural Events - Agency Approvals

PJR-025

Applicant <u>VeloStreet Inc.</u> Event Title or type of event <u>Ben Liphymen's King Ridge Gran Fondo</u> <u>Bicycling</u> Activities included in event(s)	File No. <u>SPC 10-0012</u> Event(s) date(s) and hours <u>October 9th 2010 8^{AM}-6^{PM}</u> Attendance at each event <u>6,000</u>
--	---

Signatures from the following departments/agencies must be obtained prior to issuance of a Special/Cultural Event by the Permit and Resource Management Department (PRMD). If the application is approved, PRMD will issue a zoning permit specifying all conditions of approval. The applicant must comply with all conditions of approval.

PRMD Building Inspection 2550 Ventura Avenue Santa Rosa, CA 95403 TEL (707) 565-1900 FAX (707) 565-1972	Condition(s): _____ <div style="text-align: center; font-size: 2em;">N/A</div> Signature _____ Date _____
PRMD Project Review Health Specialist (Porta-toilets, trash containers, noise) 2550 Ventura Avenue Santa Rosa, CA 95403 TEL (707) 565-1683 FAX (707) 565-1103	Condition(s): <u>See the attached conditions</u> Signature <u>Jonathan Tracy</u> Date <u>2-24-10</u>
PRMD Encroachment Section (Public right-of-way) 2550 Ventura Avenue Santa Rosa, CA 95403 TEL (707) 565-3626 or 565-3645 FAX (707) 565-3313	Condition(s): <u>SEE SPC 10-0001</u> <u>SEE CAP FOR TRAFFIC CONTROL</u> Signature <u>[Signature]</u> Date <u>1-19-10</u>
Sonoma County Environmental Health (Food preparation, service, handling) 475 Aviation Blvd., #220 Santa Rosa, CA 95403 TEL (707) 565-6565 FAX (707) 565-6525	Condition(s): <u>See attached conditions</u> Signature <u>[Signature]</u> Date <u>3/5/10</u>
Fire Services/Local Fire District (Emergency Services) 2300 County Center Dr, Suite A221 Santa Rosa, CA 95403 TEL (707) 565-1152 FAX (707) 565-1172	Condition(s): <u>COMPLY W/FIRE CODE REGULATIONS AND LOCAL CONDITIONS NOTED ON FIRE CODE PERMIT.</u> Signature <u>[Signature]</u> Date <u>2/24/2010</u>
Sonoma County Sheriff (Traffic, safety) 2796 Ventura Avenue Santa Rosa, CA 95403 TEL (707) 565-2511 FAX (707) 526-0403	Condition(s): _____ Signature <u>[Signature]</u> Date <u>2.25.10</u>
California Highway Patrol 6100 Labath Avenue Rohnert Park, CA 94928 TEL (707) 588-1400 FAX No FAX # <u>588-1404 Sgt Mark</u>	Condition(s): _____ Signature _____ Date _____



COUNTY OF SONOMA
DEPARTMENT OF HEALTH SERVICES

Rita Scardaci, PHN, MPH - Director
Ruth Lincoln, PHN, MA - Assistant Director
Benita McLarin, MS, MHA - Assistant Director

Environmental Health Division
Walter L. Kruse - Director

CONDITIONS FOR PLANNING DEPARTMENT
SPECIAL EVENT/CULTURAL EVENT
Permit Application

EVENT NAME Levi Leipheimer's King Ridge Gran Fondo
EVENT LOCATION County wide - see attached maps
EVENT DATES Oct 9, 2010
ORGANIZATION NAME Velo Street, Inc / Bike Monkey
CONTACT NAME Cheryl Wallace
CONTACT TELEPHONE 707-480-2137
CATERER NAME TBD - will have multiple caterers

CONDITIONS:

1. All food vendors must have a valid Sonoma County Retail Food Industry Permit for events of two or more consecutive days. Food Permits must be received at least **two weeks prior to the event**.
2. Food vendors are required to follow the food-handling guidelines that have been provided to the event organizer.
3. Safe, potable water supply shall be provided at each event.
4. For events of **two or more consecutive days**, the event organizer shall obtain a Special Event Organizer Permit from this office at least **two weeks prior to the event**.

Note: Attach copy of Special Event/Cultural Event permit application and zoning permit

(For division approval)

C Baranov
Christine Baranov, REHS
Environmental Health Specialist

3/5/10
Date Approved



COUNTY OF SONOMA PERMIT AND RESOURCE MANAGEMENT DEPARTMENT

2550 Ventura Avenue, Santa Rosa, CA 95403-2829
(707) 565-1900 FAX (707) 565-1103

CONDITIONS FOR PLANNING DEPARTMENT PERMIT APPLICATION SPECIAL EVENTS

EVENT: Bicycling.

NAME OF ORGANIZATION: VeloStreet Inc.

LOCATION OF EVENT: Santa Rosa-Occidental-Duncan Mills-Cazadero-Sea Ranch-Coast Hwy.

DATES OF EVENT: October 9, 2010, from 8:00 AM to 6:00 PM.

1. Provide at least 1 portable toilet per 100 people and as specified in policy 9-2-31 on the PRMD website. Portable toilets must be serviced by a licensed company. Portable toilets shall be equipped with hand washing sinks. Accessible portable toilets shall be provided at a rate of 5% (but not less than one) at each location that portable toilets are placed.

**NOTE: ANY EXISTING SEPTIC SYSTEM CANNOT BE USED FOR THESE EVENTS
UNLESS IT HAS BEEN THOROUGHLY REVIEWED BY THE WELL & SEPTIC
DISTRICT SPECIALIST AND HAS THE CAPACITY TO ACCOMMODATE THE
INCREASED LOADING FROM THE EVENTS AND THE EXISTING USES.**

2. The applicant shall provide an adequate number of solid waste receptacles and provide for daily litter pick-up. Containers shall be designed to prevent spillage and the entry of rodents, birds, cats or dogs. Provision for recycling and waste reduction is required, call the Eco-Desk at 565-3375 or visit the web site at www.recyclenow.org and click on Special Events under Businesses.

3. Noise shall be controlled in accordance with the Table NE-2 (Attached) of the Noise Element of the Sonoma County General Plan.

4. Other: (a) **Pay Project Review-Health fee of \$181.00** at time of submittal to Planning.
(b) Comply with conditions of Environmental Health, Consumer Protection regarding food and beverage service. Catering services must be used.
(c) If any complaints are received regarding this event, the applicant may have to cease this activity based upon investigation by this Department.

JONATHAN TRACY, R.E.H.S., M.S.
Senior Environmental Health Specialist, Project Review

2-24-10
DATE

Zoning Permit ZPE10-0012

Rest stops for Levi Leipheimer's King Ridge GranFondo on October 9, 2010

The Cazadero Rest Stop at 6150 Cazadero Hwy. in Cazadero will accommodate 3000 riders between the hours of 10:00 am and 1:00pm with approximately 100 riders using the rest stop at any given time. The rest stop will include food and water for the riders, along with a bike rack area and 20 restrooms (see map for location of restrooms). There will not be any music, alcohol or security. There will be volunteers assisting in keeping the roadway clear and assisting the riders. The road will be open to traffic.

The King Ridge Rest Stop at 33515 Tin Barn Rd. at the intersection of King Ridge Rd., Tin Barn Rd. and Hauser Bridge Rd. will accommodate 3000 riders between the hours of 11:00 am and 4:00pm with approximately 100 riders using the rest stop at any given time. The rest stop will include food and water for the riders, along with a bike rack area and 20 restrooms (see map for location of restrooms). There will not be any music, alcohol or security. There will be volunteers assisting in keeping the roadway clear and assisting the riders. The road will be open to traffic.

The Duncans Mills Rest Stop at 25385 Steelhead Blvd. in Duncans Mills will accommodate 2000 riders between the hours of 9:30 am and 12:00 pm with approximately 250 riders using the rest stop at any given time. The rest stop will include food and water for the riders, along with a bike rack area and 20 restrooms (see map for location of restrooms). There will not be any music, alcohol or security. There will be volunteers assisting in keeping the roadway clear and assisting the riders. The road will be open to traffic.

Revised 5-6-10

Zoning Permit ZPE10-0012

Rest stops for Levi Leipheimer's King Ridge GranFondo on October 9, 2010

The Cazadero Rest Stop at 6150 Cazadero Hwy. in Cazadero will accommodate 3000 riders between the hours of 10:00 am and 1:00pm with approximately 100 riders using the rest stop at any given time. The rest stop will include food and water for the riders, along with a bike rack area and 20 restrooms (see map for location of restrooms). There will not be any music, alcohol or security. There will be volunteers assisting in keeping the roadway clear and assisting the riders. The road will be open to traffic.

The King Ridge Rest Stop at 33515 Tin Barn Rd. at the intersection of King Ridge Rd., Tin Barn Rd. and Hauser Bridge Rd. will accommodate 3000 riders between the hours of 11:00 am and 4:00pm with approximately 100 riders using the rest stop at any given time. The rest stop will include food and water for the riders, along with a bike rack area and 20 restrooms (see map for location of restrooms). There will not be any music, alcohol or security. There will be volunteers assisting in keeping the roadway clear and assisting the riders. The road will be open to traffic.

*superseded
5/6/10*



CHP



Course

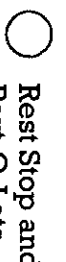

Rest Stop and
Port-O-Lets



EMT



Transport Vehicle

GranFondo Route

Start at Finley Center
Head southeast on Stony Point Rd
Turn right at W 3rd St
Continue on Hall Rd
Turn left at Sanford Rd
Turn right at Occidental Rd
Turn right at Mill Station Rd
Turn left at Dyer Ave
Turn left at Sullivan Rd
Turn left to stay on Graton Rd
Turn right at Bohemian Hwy
Turn left at CA-116

Turn right at Cazadero Hwy
Slight right at King Ridge Rd
Turn right at Hauser Bridge Rd
Turn left at Seaview Rd
Slight left at Fort Ross Rd
Continue on Meyers Grade Rd
Turn left at CA-1/Coast Hwy
Turn right to stay on CA-1/Coast Hwy
Turn right at Coleman Valley Rd
Turn left to stay on Graton Rd
Turn right at Bohemian Hwy
Turn right at Sullivan Rd
Turn left at Dyer Ave
Turn right at Mill Station Rd
Turn left at Occidental Rd
Turn left at Sanford Rd
Turn right at Hall Rd
Turn left at Willowside Rd
Continue on Creek Path to Stony Point Rd
Turn left and then immediately right onto
Stony Point Rd
End at Finley Center

MedioFondo Route

Start at Finley Center
Head southeast on Stony Point Rd
Turn right at W 3rd St
Continue on Hall Rd
Turn left at Sanford Rd
Turn right at Occidental Rd
Turn right at Mill Station Rd
Turn left at Dyer Ave
Turn right at Sullivan Rd
Turn left to stay on Graton Rd
Turn right at Bohemian Hwy
Turn left at Moscow Rd
Turn left at CA-116
Turn left at Coleman Valley Rd
Turn left to stay on Coleman Valley Rd
Turn left at Bohemian Hwy
Turn right at Graton Rd
Turn left at Occidental Rd
Turn right at Graton Rd
Turn right at Graton Rd
Turn right at Graton Rd
Turn left at Dyer Ave
Turn right at Mill Station Rd
Turn left at Occidental Rd
Turn left at Sanford Rd
Turn right at Hall Rd
Turn left at Willowside Rd
Continue on Creek Path to Stony Point Rd
Turn left and then immediately right onto
Stony Point Rd
End at Finley Center

PiccoloFondo Route

Start at Finley Center
Head southeast on Stony Point Rd
Turn right at W 3rd St
Continue on Hall Rd
Turn left at Sanford Rd
Turn right at Occidental Rd
Turn right at Mill Station Rd
Turn left at Dyer Ave
Turn right at Sullivan Rd
Turn left to stay on Graton Rd
Turn right at Bohemian Hwy
Turn left into Community Center
Return from Community Center
Turn right at Graton Rd
Turn left at Graton Rd
Turn left at Dyer Ave
Turn right at Mill Station Rd
Turn left at Occidental Rd
Turn left at Sanford Rd
Turn right at Hall Rd
Turn left at Willowside Rd
Continue on Creek Path to Stony Point Rd
Turn left and then immediately right onto
Stony Point Rd
End at Finley Center

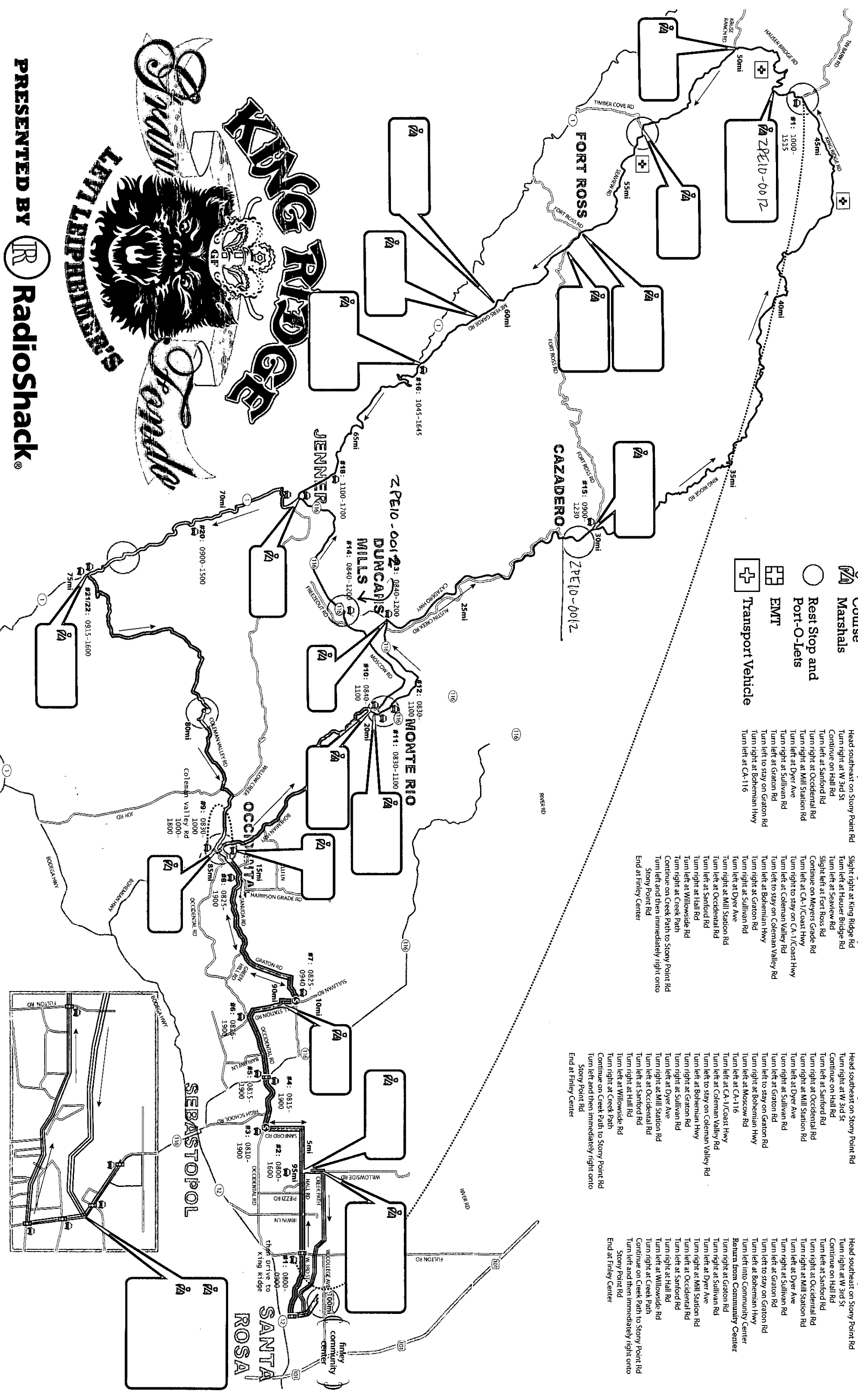

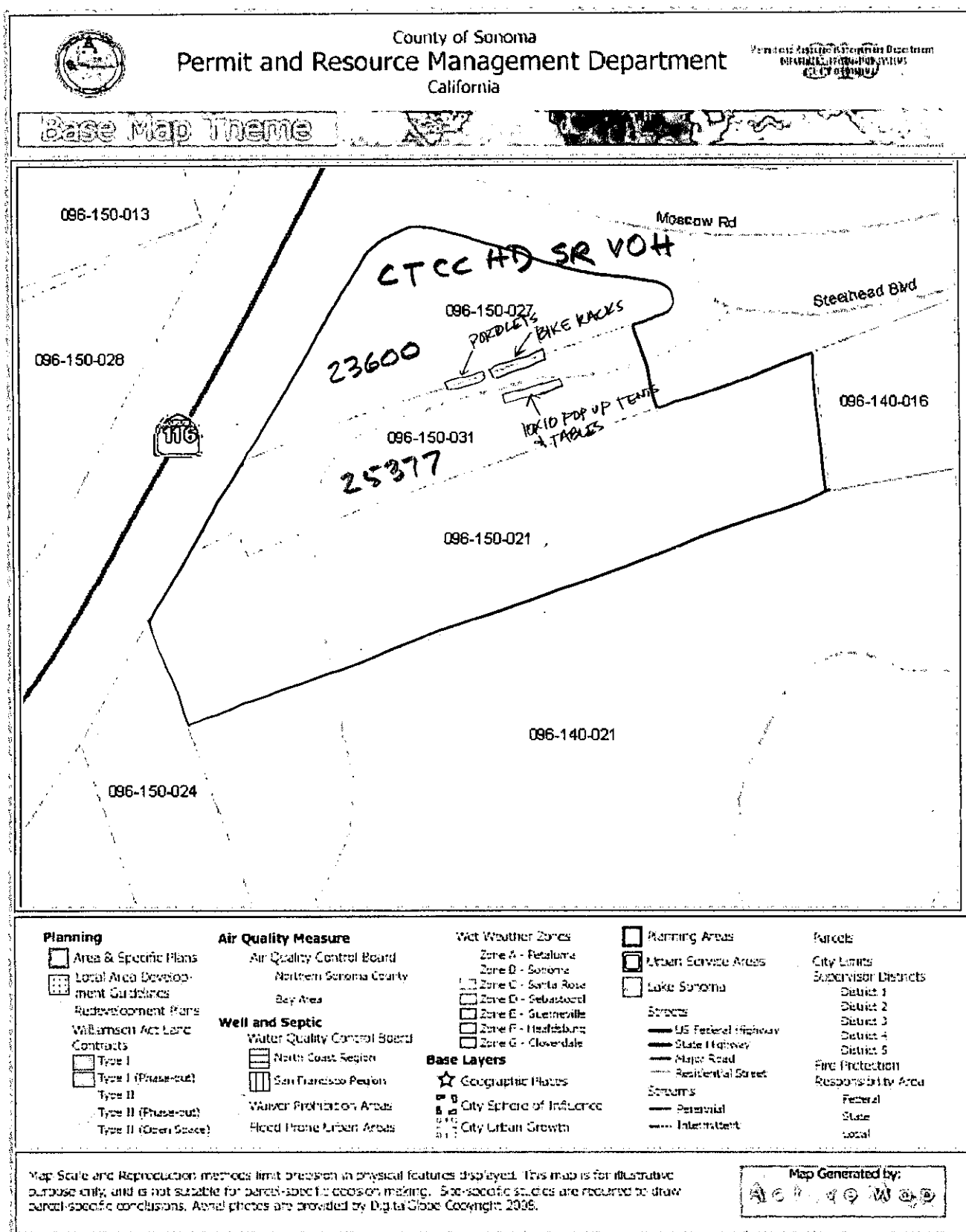

PROPERTY OWNER: DAVID FERRIERA
25385 STEELHEAD BLVD.
DUNCAN'S MILLS CA 95430

MAILING ADDRESS: DUNCAN'S MILLS TRADING CO.
PO BOX 57
DUNCAN'S MILLS CA 95430

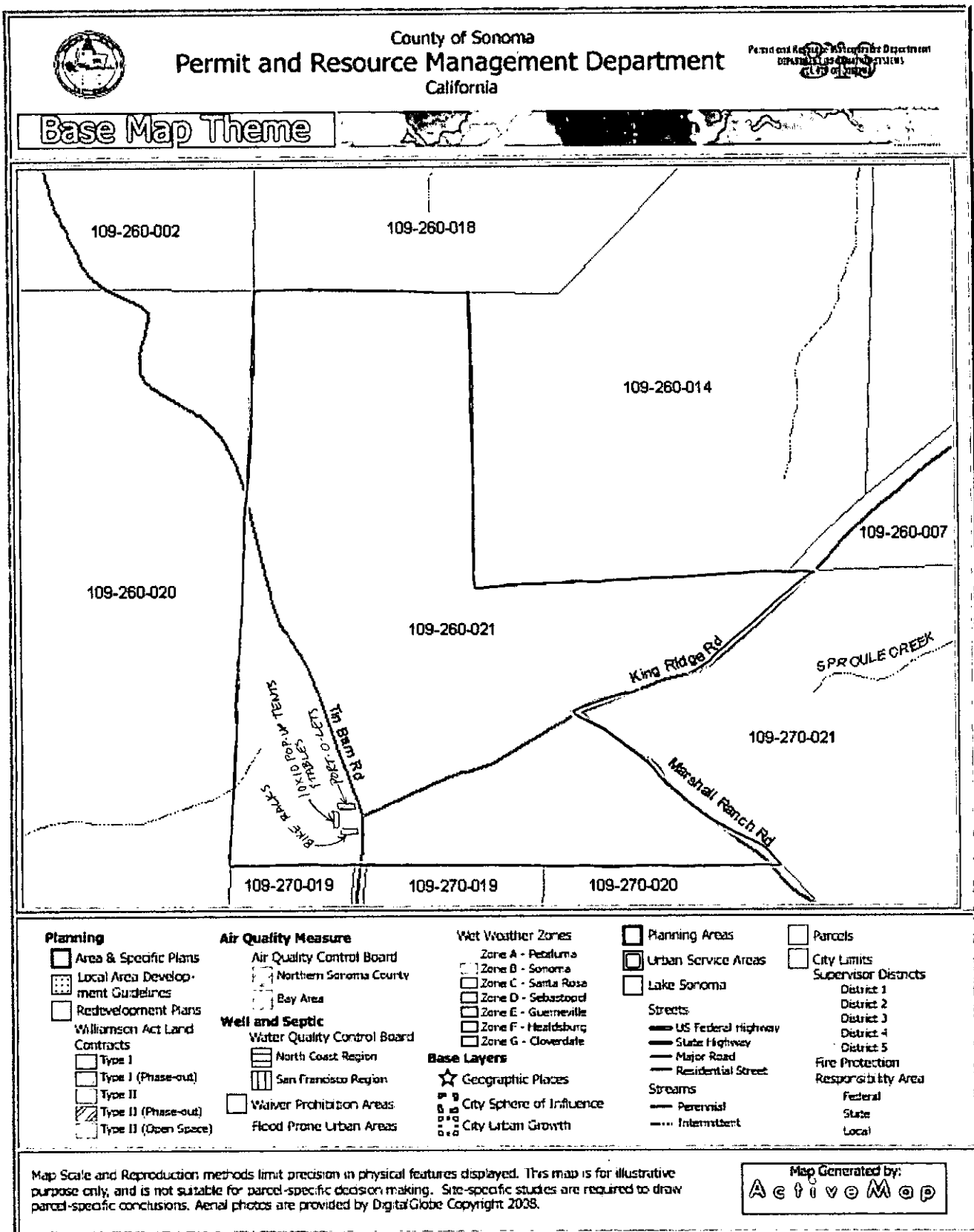

PROPERTY OWNER - ELLEN A. RICHARDSON EPPERSON
33515 TIN BARN RD
CAZADERO CA 95421-9612



County of Sonoma
Permit and Resource Management Department
California

Permit and Resource Management Department
SPECIAL SERVICES DIVISION
2010-2011

Base Map Theme

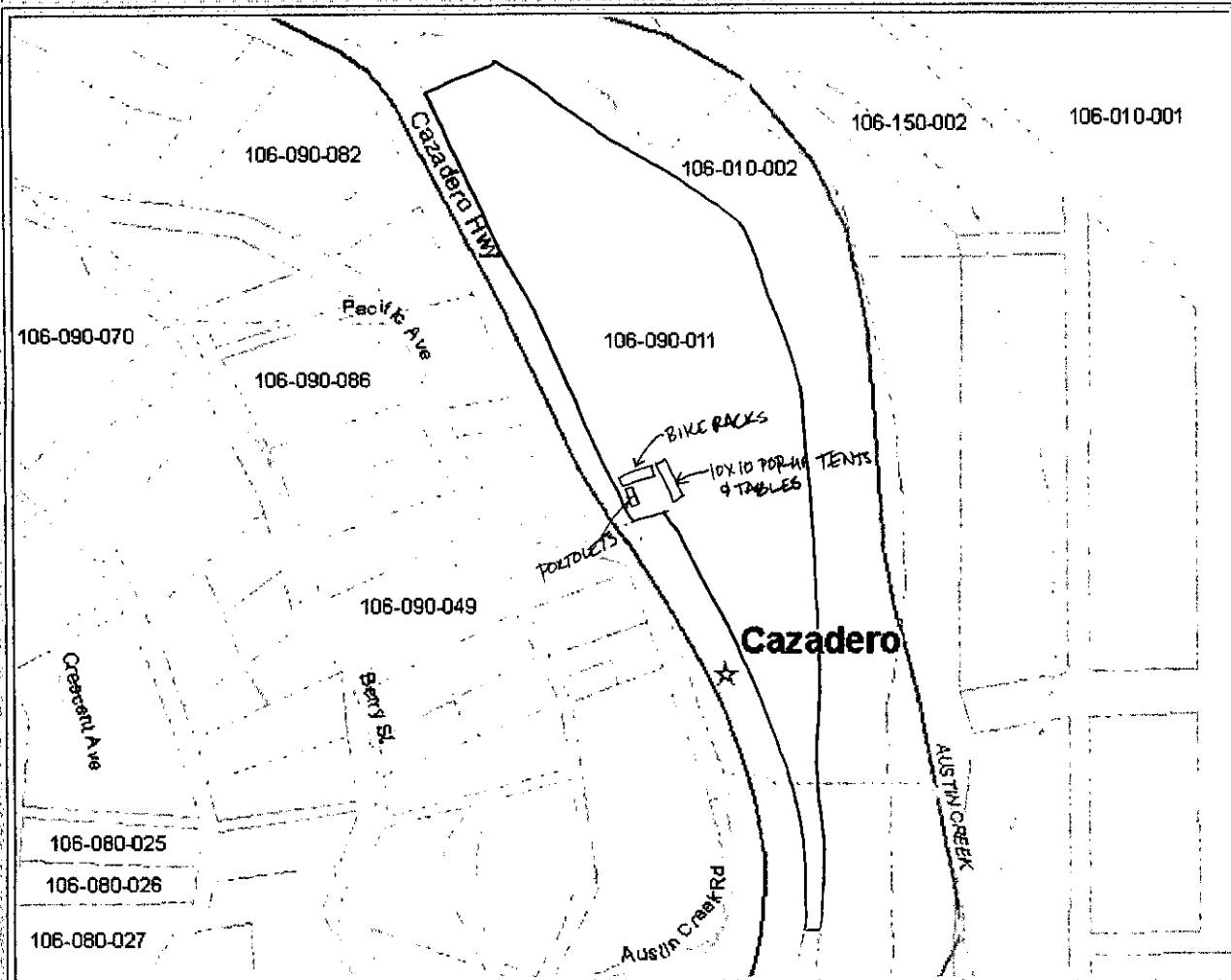

Planning

- ☐ Area & Specific Plans
- ☐ Local Area Development Guidelines
- ☐ Redevelopment Plans
- ☐ Williamson Act Land Contracts
- ☐ Type I
- ☐ Type I (Phase-out)
- ☐ Type II
- ☐ Type II (Phase-out)
- ☐ Type II (Open Space)

Air Quality Measure

- ☐ Air Quality Control Board
- ☐ Northern Sonoma County
- ☐ Bay Area

Well and Septic

- ☐ Water Quality Control Board
- ☐ North Coast Region
- ☐ San Francisco Region
- ☐ Voluntary Protection Areas
- ☐ Flood Prone Urban Areas

Wet Weather Zones

- ☐ Zone A - Petaluma
- ☐ Zone B - Sonoma
- ☐ Zone C - Santa Rosa
- ☐ Zone D - Sebastopol
- ☐ Zone E - Guerneville
- ☐ Zone F - Healdsburg
- ☐ Zone G - Cloverdale

Base Layers

- ☐ Geographic Places
- ☐ City Sphere of Influence
- ☐ City Urban Growth

Planning Areas

- ☐ Urban Service Areas
- ☐ Lake Sonoma
- ☐ Streets
- ☐ US Federal Highway
- ☐ State Highway
- ☐ Major Road
- ☐ Residential Street
- ☐ Streams
- ☐ Perennial
- ☐ Intermittent

Parade

- ☐ City Limits
- ☐ Supervisor Districts
- ☐ District 1
- ☐ District 2
- ☐ District 3
- ☐ District 4
- ☐ District 5
- ☐ Fire Protection Responsibility Area
- ☐ Federal
- ☐ State
- ☐ Local

Map Scale and Reproduction methods limit precision in physical features displayed. This map is for illustrative purpose only, and is not suitable for parcel-specific decision making. Site-specific studies are required to draw parcel-specific conclusions. Aerial photos are provided by DigitalGlobe Copyright 2005.

Map Generated by:
ActiveMap

PROPERTY OWNER - DONALD BERRY
6150 CAZADERO HWY.
CAZADERO CA 95421

COUNTY ASSESSOR'S PARCEL MAP

TAX RATE AREA
125-007

106-09

REVISED
03-02-95=83 - LSL
02-19-97=84 - LSL
11-05-03=85 - RL
08-31-06=86 - MH
09-28-06=87 - MH

T 8N
R 11W

SCALE: 1" = 100'

Old Depot Grounds -
(UNIMPROVED)

11

106-15

106-16

106-17

106-18

106-19

106-20

106-21

106-22

106-23

106-24

106-25

106-26

106-27

106-28

106-29

106-30

106-31

106-32

106-33

106-34

106-35

106-36

106-37

106-38

106-39

106-40

106-41

106-42

106-43

106-44

106-45

106-46

106-47

106-48

106-49

106-50

106-51

106-52

106-53

106-54

106-55

106-56

106-57

106-58

106-59

106-60

106-61

106-62

106-63

106-64

106-65

106-66

106-67

106-68

106-69

106-70

106-71

106-72

106-73

106-74

106-75

106-76

106-77

106-78

106-79

106-80

106-81

106-82

106-83

106-84

106-85

106-86

106-87

106-88

106-89

106-90

106-91

106-92

106-93

106-94

106-95

106-96

106-97

106-98

106-99

106-100

106-101

106-102

106-103

106-104

106-105

106-106

106-107

106-108

106-109

106-110

106-111

106-112

106-113

106-114

106-115

106-116

106-117

106-118

106-119

106-120

106-121

106-122

106-123

106-124

106-125

106-126

106-127

106-128

106-129

106-130

106-131

106-132

106-133

106-134

106-135

106-136

106-137

106-138

106-139

106-140

106-141

106-142

106-143

106-144

106-145

106-146

106-147

106-148

106-149

106-150

106-151

106-152

106-153

106-154

106-155

106-156

106-157

106-158

106-159

106-160

106-161

106-162

106-163

106-164

106-165

106-166

106-167

106-168

106-169

106-170

106-171

106-172

106-173

106-174

106-175

106-176

106-177

106-178

106-179

106-180

106-181

106-182

106-183

106-184

106-185

106-186

106-187

106-188

106-189

106-190

106-191

106-192

106-193

106-194

106-195

106-196

106-197

106-198

106-199

106-200

106-201

106-202

106-203

106-204

106-205

106-206

106-207

106-208

106-209

106-210

106-211

106-212

106-213

106-214

106-215

106-216

106-217

106-218

106-219

106-220

106-221

106-222

106-223

106-224

106-225

106-226

106-227

106-228

106-229

106-230

106-231

106-232

106-233

106-234

106-235

106-236

106-237

106-238

106-239

106-240

106-241

106-242

106-243

106-244

106-245

106-246

106-247

106-248

106-249

106-250

106-251

106-252

106-253

106-254

106-255

106-256

106-257

106-258

106-259

106-260

106-261

106-262

106-263

106-264

106-265

106-266

106-267

106-268

106-269

106-270

106-271

106-272

106-273

106-274

106-275

106-276

106-277

106-278

106-279

106-280

106-281

106-282

106-283

106-284

106-285

106-286

106-287

NOTE: Assessor's parcels do not necessarily constitute legal lots. To verify legal parcel status, check with the appropriate city or county community development or planning division.

REVISED:
1-11-79=19
02-29-84=21
LSL 1-18-07=90
MH 5-10-07=R/S

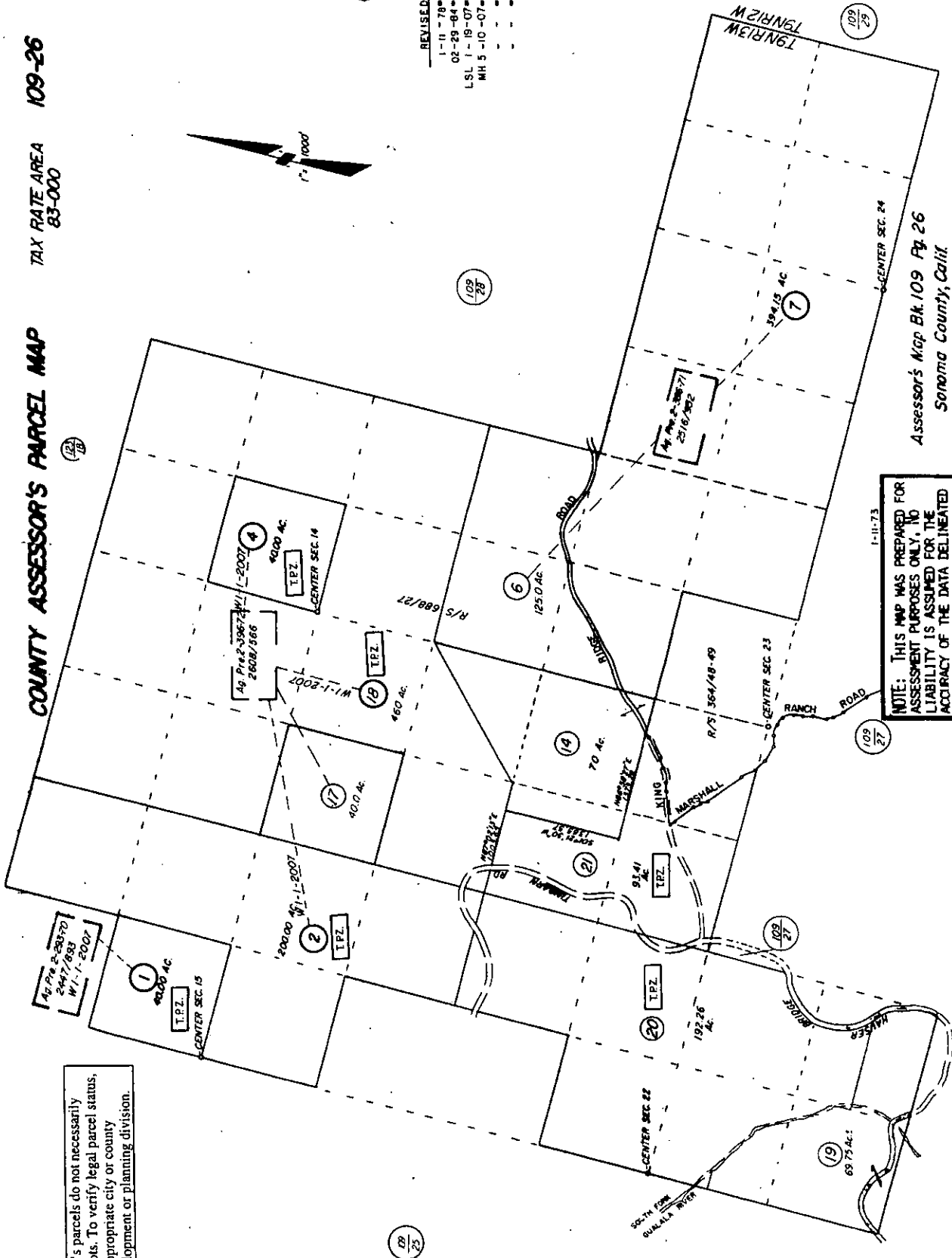

NOTE: THIS MAP WAS PREPARED FOR ASSESSMENT PURPOSES ONLY. NO LIABILITY IS ASSUMED FOR THE ACCURACY OF THE DATA DELINEATED HEREON.

Assessor's Map Bk 109 Pg 26
Sonoma County, Calif.



COUNTY OF SONOMA
PERMIT AND RESOURCE MANAGEMENT DEPARTMENT

2550 Ventura Avenue, Santa Rosa, CA 95403
(707) 565-1900 FAX (707) 565-1103

June 22, 2010

Carlos Perez - Bike Monkey
Levi Leipheimer's King Ridge Gran Fondo
PO Box 5318
Santa Rosa, CA 95402

Re: File # ZPE10-0012; 23450 and/or 23600 Moscow Road
6150 Cazadero Hwy.
33515 Tin Barn Road
25377 Steelhead Blvd.

The Sonoma County Permit and Resource Management Department hereby grants the request for a Zoning Permit for the cultural/special event for off-street rest stops providing refreshments and portable toilets for the riders on the Levi Leipheimer's King Ridge Gran Fondo on October 9, 2010, from 8 a.m. to 6 pm, at the various locations on the route as set forth in the application.

Approval and conditions have been received from PRMD Building Inspection, Project Review Health Specialist and Encroachment Section, in addition to Sonoma County Environmental Health, Fire Services, Sheriff and the California Highway Patrol. All of the conditions imposed by these Divisions are attached and shall be adhered to.

It is the determination of the Permit and Resource Management Department that the project is Categorically Exempt from the provisions of the California Environmental Quality Act pursuant to the Provisions of Title 14 of the California Administrative Code, Section 15304(e).

This Zoning Permit is limited to the use as described on the application form, the proposal statement and the site plan submitted to this department. Any modifications of the use, expansion or alteration shall be submitted for review and approval of the Permit and Resource Management Department in advance of the proposed change and may, at the discretion of the department, require a new Zoning Permit.

If you have any questions, feel free to contact me at (707) 565-1924. Please refer to your file number (ZPE10-0012) when making inquiries.

Sincerely,

David Hardy
Project Planner

cc: File # ZPE10-0012
George Parmeter
Donald Berry
Ellen A. Richardson Epperson
Duncans Mills Trading Co.

att.