

B

Type

18

Docs

Plans

BLD04-7395

Building Permit Number (List all associated with these documents)

400

Street Number

DUTTON AVE

Street Name

ROS

Community Code

125-162-027

APN

Please Print Your Name: **JESSE GLADMAN** Date Applied: **12/30/04**

INFORMATION WITHIN HEAVY LINE TO BE COMPLETED BY APPLICANT

SITE LOCATION INFORMATION - PRINT CLEARLY

Site Address: **400 OUTTON AVE** City: **SANTA ROSA** ZIP: **95407**
 Cross-Street: **SEBASTOPOL AVE** APN: **125-162-027** Project Phone #: ()
 Directions: Subd. Name: Unit #: Lot #:
 Describe Project: **INTERIOR REMODEL 4400 sq ft** Living Area: **all interior** Garage: **no change to footprint** Contract Price: **200,000**

OWNER NAME AND ADDRESS Name: **EXCHANGE BANK**
 Mailing Address: **444 AVIATION BLVD**
 City: **SANTA ROSA** State: **CA** ZIP: **95403**
 Day Ph: **(707) 524-3289** Fax: **(707) 521-5131**

APPLICANT NAME AND ADDRESS Name: **JESSE GLADMAN**
 Mailing Address: **464 KENWOOD CT, SUITE B**
 City: **SANTA ROSA** State: **CA** ZIP: **95407**
 Day Ph: **(707) 576-7337** Fax: **(707) 576-7173**

CONTRACTOR INFORMATION

Company Name: **JIM MURPHY & ASSOCIATES** Name: **DISRAD & ASSOCIATES**
 Address: **464 KENWOOD CT, SUITE B** Address: **1207 UINE ST**
 City: **SANTA ROSA** State: **CA** ZIP: **95407** City: **HEALDSBURGH** State: **CA** ZIP: **95448**
 Day Ph: **(707) 576-7337** Fax: **(707) 576-7173** Day Ph: **(707) 433-2330** Fax: **(707) 433-0708**

WORKER'S COMPENSATION DECLARATION

I hereby affirm under penalty of perjury one of the following declarations:
 I have and will maintain a certificate of consent to self-insure for worker's compensation, as provided for by Section 3700 of the Labor Code, for the performance of the work for which this permit is issued.
 I have and will maintain worker's compensation insurance, as required by Section 3700 of the Labor Code, for the performance of the work for which this permit is issued. My worker's compensation insurance carrier and policy number are:
 Carrier: **STATE FUND**
 Policy No: **6473504**
 (This section need not be completed if the permit is for one hundred dollars (\$100) or less.)
 I certify that in the performance of the work for which this permit is issued, I shall not employ any person in any manner so as to become subject to the worker's compensation laws of California, and agree that if I should become subject to the worker's compensation provisions of Section 3700 of the Labor Code, I sh all forthwith comply with those provisions.
 Exp. Date: **10/1/05** Applicant: *[Signature]*

CONSTRUCTION LENDING DECLARATION

I hereby affirm under penalty of perjury that there is a construction lending agency for the performance of the work for which this permit is issued. (Sec. 3097, Civ. C.)
 Lenders Name: _____
 Lenders Address: _____

WARNING: FAILURE TO SECURE WORKER'S COMPENSATION COVERAGE IS UNLAWFUL, AND SHALL SUBJECT AN EMPLOYER TO CRIMINAL PENALTIES AND CIVIL FINES UP TO ONE HUNDRED THOUSAND DOLLARS (\$100,000) IN ADDITION TO THE COST OF COMPENSATION, DAMAGES AS PROVIDED FOR IN SECTION 3706 OF THE LABOR CODE, INTEREST, AND ATTORNEY'S FEES.

OWNER-BUILDER DECLARATION

I hereby affirm under penalty of perjury that I am exempt from the Contractor's License Law for the following reason (Sec. 7031.5, Business and Professions Code: Any city or county which requires a permit to construct, alter, improve, demolish, or repair any structure, prior to its issuance, also requires the applicant for such permit to file a signed statement that he or she is licensed pursuant to the provisions of the Contractor's License Law (Chapter 9 (commencing with Section 7000) of Division 3 of the Business and Professions Code) or that he or she is exempt therefrom and the basis for the alleged exemption. Any violation of Section 7031.5 by any applicant for a permit subjects the applicant to a civil penalty of not more than five hundred dollars (\$500).):
 I, as owner of the property, or my employees with wages as their sole compensation, will do the work, and the structure is not intended or offered for sale (Sec. 7044 Business and Professions Code: The Contractor's License Law does not apply to an owner of property who builds or improves thereon, and who does such work himself or herself or through his or her own employees, provided that such improvements are not intended or offered for sale. If, however, the building or improvement is sold within one year of completion, the owner-builder will have the burden of proving that he or she did not build or improve for the purpose of sale.)
 I, as owner of the property, am exclusively contracting with licensed contractors to construct the project (Sec. 7044, Business and Professions Code: The Contractor's License Law does not apply to an owner of property who builds or improves thereon, and who contracts for such projects with a contractor(s) licensed pursuant to the Contractor's License Law.)
 I am exempt under Sec. _____ B & P.C. for this reason _____
 Date: _____ Owner: _____

FOR DEPARTMENT USE

Zoning _____ File No. _____ Acres _____
 Existing Use/Structures _____
 Proposed Use/Structures _____
 Zoning Min. Yard Requirements: Front _____ Left _____ Right _____ Back _____
 NOTE: Fire Safe Standards require all parcels greater than 1 Acre to have a min. 30' setback unless mitigated. Mitigation Required Address subject to change
 Approval for Permit Issuance: _____ Approval for Occupancy: _____
 By: _____ Date: _____
 Conditions: _____

LICENSED CONTRACTOR'S DECLARATION

I hereby affirm under penalty of perjury that I am licensed under provisions of Chapter 9 (commencing with Section 7000) of Division 3 of the Business and Professions Code, and my license is in full force and effect.
 Lic. Class: **B** Lic. No.: **505531**
 Exp. Date: **2/28/05** Contractor: **JIM MURPHY & ASSOCIATES**

Sewer Connection: Available Fees Paid
 Approved by: *[Signature]* Date: **12/30/04**
 Road Encroachment: Fees Paid
 Approved by: _____ Date: _____

ASBESTOS DECLARATION

Written asbestos notification pursuant to Part 61 of Title 40 of the Code of Federal Regulations is required when asbestos exists in buildings, or portions thereof, undergoing demolition. I hereby declare that demolition authorized by this permit is from construction that (does) (does not) contain asbestos, or that no demolition is authorized by this permit.

Septic System Permit/Clearance # _____
 Approved by: _____ Date: _____
 Flood Zone: Yes No 100 Year Flood Elevation: _____
 Site Review: **on 03/24/05**
 Drainage Review: _____
 Approved by: _____ Date: _____

I certify that I have read this application and affirm under penalty of perjury that the above information is correct. I agree to comply with all local Ordinances and State laws relating to building construction. I hereby authorize representatives of the County of Sonoma to enter upon the above-mentioned property for inspection purposes. If, after making the Certificate of Exemption for the Worker's Compensation provision of the Labor Code I should become subject to such provisions, I will forthwith comply. In the event I do not comply with the Workman's Compensation law, this permit shall be deemed revoked.
 PERMITTEE SIGNATURE: *[Signature]*
 ADDRESS: **same** CITY: _____ ZIP: _____
 Contractor Owner Other Licensed Professional

Fire: **SREB (92)** Date: **RECALCULATED 2/22/05**
 Approved by: _____ Date: _____
 Code Enforcement Violation Yes No Violation # _____
 This permit is limited to _____ days.

Work Authorized: **interior remodel**

Plans Approved Post FIRM Alquist Priolo Report Available
 No Plans Subject to Field Inspection Pre FIRM Geotechnical report Available
 Plans Check Prepared By: *[Signature]* Date: **1-26-05** Type of Construction: **TIN B** Occupancy: **1** No. of Stories: **1** No. of Bedrooms: _____
 Permit Cleared for Issuance By: *[Signature]* Date: **12/30/04** Auto. Fire Sprinklers Req'd: **yes** No. of Units: _____ Certificate of Occupancy: _____
 Machine Space for Permit Fee

PAYMENT RECEIPT
 \$ **2733.87**
 MURPHY
 FEB 20 2005

Final Date: _____ Inspector: _____

THIS PERMIT SHALL EXPIRE IN THREE(3) YEARS FROM DATE FEES ARE PAID UNLESS OTHERWISE NOTED BY CODE ENFORCEMENT

JOB ADDRESS: **400 Outton Ave**
 PERMIT NUMBER: **B2004-7395**
 INSPECTION AREA: **10**

131)	SPECIAL INSPECTION REQUIRED	<input type="checkbox"/> YES	<input checked="" type="checkbox"/> NO	IF YES, SEE ADDITIONAL SHEET
	INSPECTION RECORD	DATE	NAME	REMARKS
101)	ROUGH GRADING			
103)	FOUNDATION			"Work not ready" 4/12/05
	FORMS/SETBACK			
	FOOTING			
	WALLS			
106)	UFER GROUND #			8/31/04
104)	CAISSONS/PIERS			Review West Exit Door Landing for accessibility requirements and fall
105)	SLAB	3/22/05	AW	Sup of project to contact Architect at record for compliance.
107)	UNDERGROUND UTILITIES			
110)	MASONRY			
109)	RETAINING WALLS			
113)	FIREPLACE			
	FOOTING			
	HEARTH/PROTECTION			
	THROAT			
114)	CHIMNEY			
120)	UNDERFLOOR/UNDERSLAB			
115)	HYDRONICS			
116)	U/F ELECTRICAL			
117)	U/F MECHANICAL			
118)	U/F PLUMBING	3/21/05	AW	
119)	U/F FRAMING			
139)	U/F INSULATION			
126)	SHEAR WALLS			
	<input type="checkbox"/> INTERIOR			<input type="checkbox"/> EXTERIOR
127)	DIAPHRAGMS			
	<input type="checkbox"/> ROOF			<input type="checkbox"/> FLOOR
134)	SIDING/SHEATHING			
125)	HOLD DOWNS			
132)	CLOSE-IN	5/9/05	AW	K1327 PH I OK AW 3/22/05
122)	ROUGH ELECTRICAL			K1327 Partial frame @ rest rm and
123)	ROUGH MECHANICAL			Vanitors closet women's rest rm ok
124)	ROUGH PLUMBING			4/13/05 DF
128)	ROUGH FRAME			4/15/05 (142) Partial see drawings on site 4/15/05
160)	SMOKE DETECTORS			L 1427 Partial see drawings for a/c
139)	INSULATION			
142)	WALLBOARD	5/11/05	AW	K142) PH I OK AW 3/25/05 DF
143)	FIREWALLS			
135)	STUCCO/PLASTER			K1327 FRAME AT NEW (3) WINDOWS - METS
	<input type="checkbox"/> LATH			<input type="checkbox"/> SCRATCH
137)	ROOFING			
130)	TUB/SHOWER PAN			
162)	FIRE DAMPERS/DOORS			ALIGY I SEE COIL ROLL CHANNEL AT
164)	SUSPENDED CEILING			FINAL IN SMALL OFFICE AT
	<input type="checkbox"/> ROUGH ELEC.			<input type="checkbox"/> ROUGH MECH.
165)	EXITING - RAMPS/STAIRS			
163)	HANDRAILS/GUARDRAILS			
	CORRIDORS/DOORS			
166)	ACCESSIBILITY COMPLIANCE	11-21-05	P	Note: Extend all J Boats
144)	WATER TANKS			
	<input type="checkbox"/> SLAB			<input type="checkbox"/> WALLS
170)	TEMPORARY OCCUPANCY			
171)	TEMPORARY ELECTRICAL			
172)	TEMPORARY GAS			
174)	ELECTRIC METER AUTHORIZATION			
152)	PANEL BOARDS/SERVICE			
189)	SEPTIC ELECTRIC FINAL			
175)	GAS METER AUTHORIZATION			
153)	GAS PRESSURE TEST			
	HOUSE			YARD
190)	MANUF. HOME FOUNDATION			
191)	MANUF. HOME INSTALLATION			
	CONTINUITY			
	STAIRS/SKIRTS			
	RIDGE BOLTING			
193)	MANUF. HOME COND. FINAL			
	SWIMMING POOLS			
194)	PRE-GUNITE			
195)	PRE-DECK			
196)	PRE-PLASTER/FENCE			
197)	VINYL/FIBERGLASS POOL EXCAVATION			
102)	GRADING FINAL			
176)	ELECTRICAL FINAL			
177)	MECHANICAL FINAL			
178)	PLUMBING FINAL			
199)	FINAL			
	OCCUPANCY (OK TO OCCUPY)			
				PLAN RETENTION REQUIRED?
				<input checked="" type="checkbox"/> Yes <input type="checkbox"/> No

PERMIT #

COUNTY OF SONOMA
PERMIT AND RESOURCE MANAGEMENT DEPARTMENT
 2550 VENTURA AVENUE, SANTA ROSA, CA 95403-2829
 (707) 565-1900 FAX (707) 565-1103

Building Permit Invoice: BLD04-7395

Project Address: 400 DUTTON AVE ROS
Cross Street:
APN: 125-162-027

Status: **ISSUED**
Printed: April 05, 2005
Initialized by: BDAVIS
Activity Type: B-BLD 401:

Description: INTERIOR TENANT IMPROVEMENT

Res/Com: C
Std/Quick: S
Fire District: ROSELAND FIRE GENERAL (S.R.)

Insp Area: 10
Site Review File #:
Site Review Fees Paid: \$0.00

Owner: EXCHANGE BANK
 C/O ACCOUNTING DEPT
 DBA EXCHANGE BANK DEPT # 104
 PO BOX 403

Applicant: JIM MURPHY & ASSOCIATES
 464 KENWOOD CT STE B
 SANTA ROSA CA
 95407-0000
 707 576 7337

Valuation:

Occupancy	Type	Factor	Sq Feet	Valuation
	Additional Amount...			200,000.00
	Totals...			\$200,000.00*

Fees:

Item#	Description	Account Code	Tot Fee	Prev. Pmts	Cur. Pmts
51	S.M.I.P. COMMERCIAL	327023-4040	42.00	42.00	.00
60	BLDG PERM PLAN CHECK FEE	025015-1341	1,428.31	1,428.31	.00
62	ADDITIONAL PLANCHECK FEE	025015-1341	51.00	.00	.00
119	FIRE COMMERCIAL REVIEW	649103-3661	-210.00	.00	.00
122	ELECTRICAL FEE	025015-1341	143.98	143.98	.00
124	PLUMBING FEE	025015-1341	56.10	56.10	.00
132	BUILDING PERMIT FEE	025015-1341	2,197.40	2,197.40	.00
140	TECH ENHANCEMENT FEE	025015-4040	64.30	30.09	.00
735	NPDES - BUILDING	025015-1341	175.79	.00	.00
1165	ZONING PERMITS W/O D.R.	025015-3829	75.00	75.00	.00
			\$4,023.88	\$3,972.88	

REVISION

Total Fees: \$4,023.88
Total Paid: \$3,972.88

Balance Due: \$51.00

Refunds are regulated by the California Building Code (CBC) which reads: "Under Section 107.6, CBC, the building official may authorize refunding of not more than 80 percent of the plan review fee paid when an application is withdrawn or canceled before any plan reviewing is done. The building official may authorize refunding of not more than 80 percent of the permit fee paid when no work has been done under the permit. There shall be no refunding of any fee paid except on written application filed by the original permittee not later than 180 days after the date of fee payment."

When validated below, this is your receipt.
 This Building Permit shall EXPIRE 02/28/2008

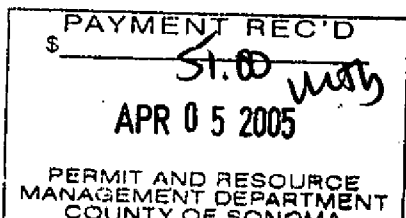

COUNTY OF SONOMA
PERMIT AND RESOURCE MANAGEMENT DEPARTMENT

2550 VENTURA AVENUE, SANTA ROSA, CA 95403-2829
 (707) 565-1900 FAX (707) 565-1103

Building Permit Invoice: BLD04-7395

Project Address: 400 DUTTON AVE ROS
Cross Street:

APN: 125-162-027

Description: INTERIOR TENANT IMPROVEMENT

Res/Com: C
Std/Quick: S
Fire District: ROSELAND FIRE GENERAL (S.R.)

Status: **PREISSUE**

Printed: February 25, 2005

Initialized by: BDAVIS

Activity Type: B-BLD 401

Insp Area: 10

Site Review File #:

Site Review Fees Paid: \$0.00

Owner: EXCHANGE BANK
 C/O ACCOUNTING DEPT
 DBA EXCHANGE BANK DEPT # 104
 PO BOX 403

Applicant: JIM MURPHY & ASSOCIATES
 464 KENWOOD CT STE B
 SANTA ROSA CA
 95407-0000
 707 576 7337

Valuation:

Occupancy	Type	Factor	Sq Feet	Valuation
	Additional Amount...			200,000.00
	Totals...			\$200,000.00*

Fees:

Item#	Description	Account Code	Tot Fee	Prev. Pmts	Cur. Pmts
51	S.M.I.P. COMMERCIAL	327023-4040	42.00	.00	.00
60	BLDG PERM PLAN CHECK FEE	025015-1341	1,428.31	1,428.31	.00
119	FIRE COMMERCIAL REVIEW	649103-3661	210.00	210.00	.00
122	ELECTRICAL FEE	025015-1341	143.98	.00	.00
124	PLUMBING FEE	025015-1341	56.10	.00	.00
132	BUILDING PERMIT FEE	025015-1341	2,197.40	.00	.00
140	TECH ENHANCEMENT FEE	025015-4040	64.30	25.70	.00
735	NPDES - BUILDING	025015-1341	175.79	.00	.00
1165	ZONING PERMITS W/O D.R.	025015-3829	75.00	75.00	.00
			\$3,972.88	\$1,739.01	

Total Fees: \$3,972.88

Total Paid: \$1,739.01

Balance Due: \$2,233.87

Refunds are regulated by the California Building Code (CBC) which reads: "Under Section 107.6, CBC, the building official may authorize refunding of not more than 80 percent of the plan review fee paid when an application is withdrawn or canceled before any plan reviewing is done. The building official may authorize refunding of not more than 80 percent of the permit fee paid when no work has been done under the permit. There shall be no refunding of any fee paid except on written application filed by the original permittee not later than 180 days after the date of fee payment."

PAYMENT REC'D \$ <u>2233.87</u> FEB 28 2005 PERMIT AND RESOURCE MANAGEMENT DEPARTMENT COUNTY OF SONOMA

When validated below, this is your receipt.
 This Building Permit shall EXPIRE

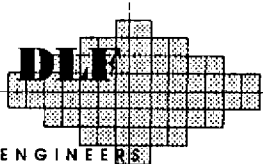

ENGINEERING CALCULATION SHEET

P.O. Box 717, Windsor, CA 95492 • (707) 838-1505 • FAX # (707) 838-1970 • email: dlfbeng@msn.com

ENGINEERS
& CONSTRUCTORS INC.

CUSTOMER _____

LOCATION _____

SHEET NO. 1012

JOB NO. 1101

DATE 2/2/05

BY JR CHK'D _____

WINDOWS

BL004-7395

FILE COPY

REVISION

400 DUTTON AVE

Exchange Bank
Redwood
Duffer Branch
Santa Rosa, CA

JR
JHA

★ APPROVED ★

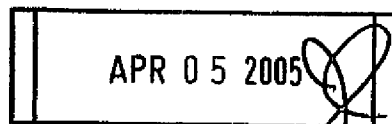

PERMIT AND RESOURCE
MANAGEMENT DEPARTMENT

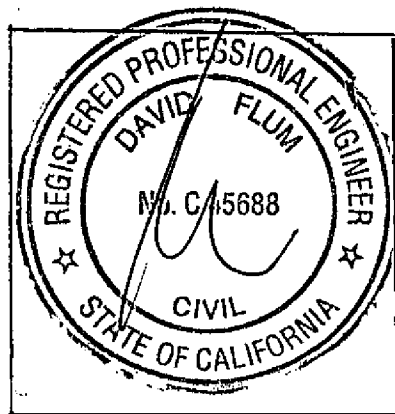

STAMP

CONTRACTS

SUBS

1000

1-6

1000

1001

Exp 12-31-06
SUBS 1-6
1001

CUSTOMER Exchange Fund
 LOCATION _____

SHEET NO. 1 of 6
 JOB NO. 14124
 DATE 3-5-05
 BY DLP CHK'D _____

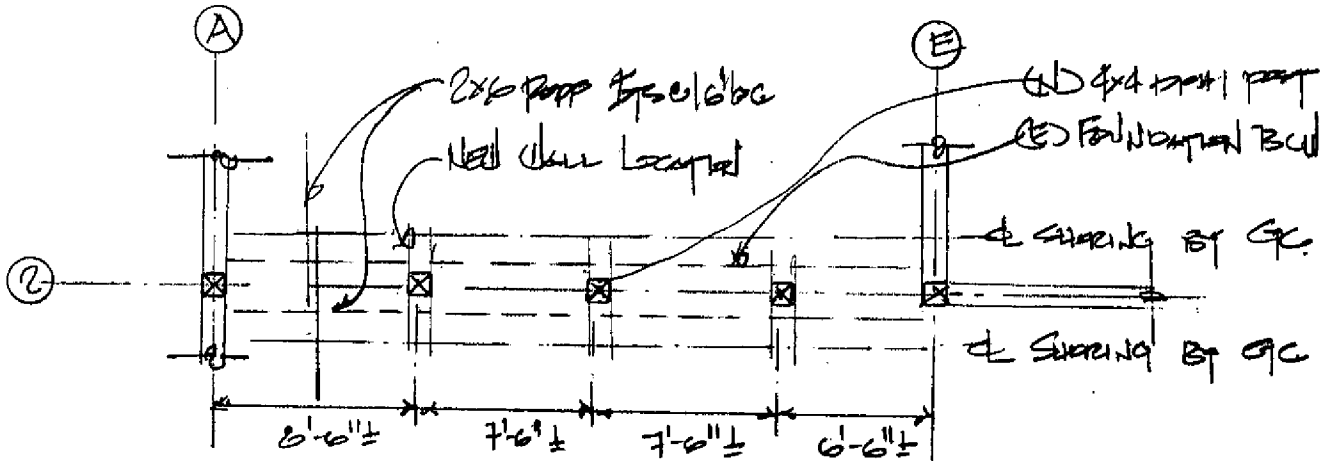
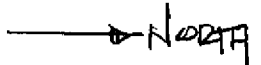

Need BM

PUL
 $16' \times 16'$

$U_D = 12(15) = 180 \text{ PLF}$
 $U_L = 12(20) = 240 \text{ PLF}$

Use 3/4" x 11 7/8" PUL

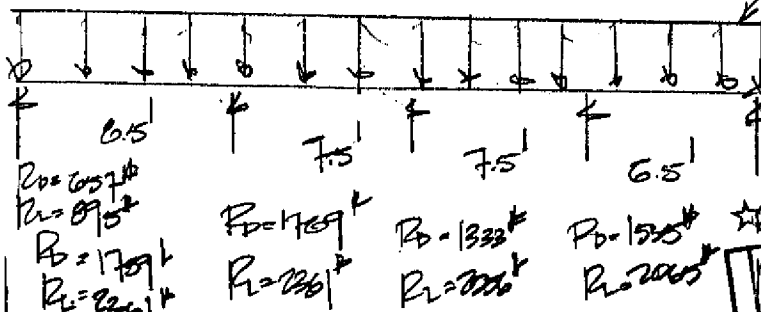

APPROVED ★
 APR 05 2005
 PERMIT AND RESOURCE
 MANAGEMENT DEPARTMENT

Need Purl

Column (E) FTG

9.0'

$A_c = 2.0651$
 $F_T = 40 \text{ ksi}$
 $F_{Tc} = 1.2568$

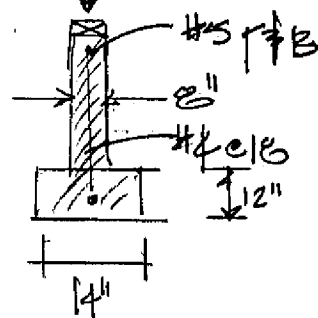

(E) FTG
OK

Use 4x4 12x12 BRG

216

WoodWorks® Sizer

SOFTWARE FOR WOOD DESIGN

Beam1.wbc

WoodWorks® Sizer 2004a

Mar. 5, 2005 08:58:06

COMPANY	PROJECT
DLP Engineers and Constructors, Inc. POB 717, Windsor, CA 95492 Phone 707-838-1505 Fax 707-838-1970	Exchange Bank Dutton Branch Santa Rosa DLF 141404

DESIGN CHECK - NDS 2001

Beam DESIGN DATA:

Material: PSL
Lateral support: top= 16.00 bottom= at supports; (in)
Total length: 30.00 (ft)
Load combinations: ICBO-UBC;

LOADS: (force-lbs, pressure-psf, udl-plf, location-ft)
>>Self-weight automatically included<<

Load	Type	Distribution	Magnitude		Location		Pat-tern
			Start	End	Start	End	
Load1	Dead	Full UDL	180.0				No
Load2	Live	Full UDL	240.0				Yes

MAXIMUM REACTIONS and BEARING LENGTHS (force-lbs, length-in)

	8.50	7.50	7.50	6.50	ft
Dead	657	1789	1333	1535	474
Live	895	2361	2056	2065	713
Total	1552	4151	3390	3600	1187
LC number	7	13	8	15	12
B.Length	1	1.21	1	1	1
Cb	1	1.31	1.41	1.38	1

DESIGN SECTION: 2.0E, 2900FB, 3.5x11.875 @12.988 plf
This section PASSES the design code check.

SECTION vs. DESIGN CODE (force-lbs, moment-lbs-ft, deflection-in)

Criterion	Analysis Value	Design Value	Analysis/Design
Shear	Fv = 65	Fv' = 285	Fv/Fv' = 0.23
Bending(+)	Fb = 406	Fb' = 2891	Fb/Fb' = 0.14
Bending(-)	Fb = 477	Fb' = 2886	Fb/Fb' = 0.17
Dead Defl'n	0.01 = <L/999		
Live Defl'n	0.02 = <L/999	0.28 = L/360	0.07
Total Defl'n	0.03 = <L/999	0.41 = L/240	0.08

FACTORS:	F	CD	CM	Ct	CL	CV	Cfu	Cr	Cfrc	Ci	Cn	LC#
Fb'+	2900	1.00	-	1.00	0.996	1.00	-	1.00	1.00	-	-	7
Fb'-	2900	1.00	-	1.00	0.994	1.00	-	1.00	1.00	-	-	13
Fv'	285	1.00	-	1.00	-	-	-	1.00	-	-	1.00	5
Fcp'	750	-	-	1.00	-	-	-	-	1.00	-	-	-
E'	2.0 million	-	-	1.00	-	-	-	-	1.00	-	-	7

Custom duration factor for Wind load = 1.33

ADDITIONAL DATA

Bending(+): LC# 7 = D+L (pattern: L L _), M = 2783 lbs-ft
Bending(-): LC#13 = D+L (pattern: L L _), M = 3269 lbs-ft
Shear: LC# 5 = D+L (pattern: L L _), V = 2220, V design = 1792 lbs
Deflection: LC# 7 = D+L (pattern: L L _), EI = 977e06 lb-in²
Total Deflection = 1.00(Dead Load Deflection) + Live Load Deflection.
(D=dead L=live S=snow W=wind I=impact C=construction CLd=concentrated)
(All LC's are listed in the Analysis output)
(Load Pattern: s=S/2, X=L+S or L+C, _=no pattern load in this span)

DESIGN NOTES:

- Please verify that the default deflection limits are appropriate for your application.
- SCL-BEAMS (Structural Composite Lumber): the attached SCL selection is for preliminary design only. For final member design contact your local SCL manufacturer.
- Size factors vary from one manufacturer to another for SCL materials. They can be changed in the database editor.

★ APPROVED ★
APR 05 2005
PERMIT AND RESOURCE
MANAGEMENT DEPARTMENT

316

WoodWorks® Sizer

SOFTWARE FOR WOOD DESIGN

Column1.wcc

WoodWorks® Sizer 2004a

Mar. 5, 2005 08:57:26

COMPANY	PROJECT
DLP Engineers and Constructors, Inc. POB 717, Windsor, CA 95492 Phone 707-838-1505 Fax 707-838-1970	Exchange Bank Dutton Branch Santa Rosa DLF 141404

DESIGN CHECK - NDS 2001

Column DESIGN DATA:

```

Type:          Pinned base; Loadface = width(b);
Material:      Lumber Post
Ke x Lb:       1.00 x 9.00= 9.00 [ft];
Ke x Ld:       1.00 x 9.00= 9.00 [ft];
Total length:  9.00 [ft]
Load combinations: ICBO-UBC;

```

LOADS: (force=lbs, pressure=psf, udl=plf, location=ft)
 >>Self-weight automatically included<<

Load	Type	Distribution	Magnitude		Location		Pat-tern
			Start	End	Start	End	
Load1	Dead	Axial	1789		(Eccentricity = 0.00 in)		
Load2	Live	Axial	2361		(Eccentricity = 0.00 in)		

DESIGN SECTION: D.Fir-L, No.1, 4x4 @ 2.910 plf

This section PASSES the design code check.

SECTION vs. DESIGN CODE (stress=psi, deflection=in)

Criterion	Analysis Value	Design Value	Analysis/Design
Axial	fc = 341	Fc' = 496	fc/Fc' = 0.69
Axial Bearing	fc = 341	Fc* = 1725	fc/Fc* = 0.20

FACTORS: F CD CM Ct CL/CP CP Cfu Cr Cft Ci LCN

Fc'	1500	1.00	1.00	1.00	0.288	1.150	-	-	1.00	1.00	2
Fc*	1500	1.00	1.00	1.00	-	1.350	-	-	1.00	1.00	2

Custom duration factor for Wind load = 1.33

ADDITIONAL DATA

Axial : LCN 2 = D+L, P = 4176 lbs
 (D=dead L=live S=snow W=wind I=impact C=construction CLD=concentrated)
 (All LC's are listed in the Analysis output)

DESIGN NOTES:

1. Please verify that the default deflection limits are appropriate for your application.

★ APPROVED ★

APR 05 2005

PERMIT AND RESOURCE
MANAGEMENT DEPARTMENT

4/10

Company Info		Project Info	
DLF Engineers & Constructors Inc. 123 West North Street Healdsburg, CA, 95448 Phone: (707) 838-1505 Fax: (707) 838-1970 E-mail: dave@dlfengineers.com		Project: Exchange Bank Location: Dutton Branch Santa Rosa, CA 95928-7051 Client: JMA Job No.: 141404 Footing Id: F1	

FOUNDATION PARAMETERS

Material Properties:

	Conc. Strength f'c, psi	Conc. Type	Bot. Steel Cover, in.	Top Steel Cover, in.	Steel Yield Fy, ksi
Section: 1	2,000	HardRock	3.00	2.00	40

Footing Section Geometry, (Stiffnesses based on computed effective stiffness, Ie):

	Length, ft.	Width, ft.	Depth, inches
Section: 1	30.00	1.17	12.00

Column & Wall Data:

	Type	Center ft.	Length in.	Width in.	Col-f'c psi	Col-Fy ksi	Dowel Bars No. & Size
Column : 2	Other	1.00	3.50	3.50	n/a	n/a	n/a
Column : 3	Other	8.50	3.50	3.50	n/a	n/a	n/a
Column : 4	Other	16.00	3.50	3.50	n/a	n/a	n/a
Column : 5	Other	23.50	3.50	3.50	n/a	n/a	n/a
Column : 6	Other	29.00	3.50	3.50	n/a	n/a	n/a

	Type	Center ft.	Length ft.	Width in.	Height ft.	Density pcf	Use Stiffness?
Wall : 1	Conc.	15.00	30.00	8.00	2.00	150	Yes

Soil Bearing Results, psf (actual / allowable):

	Gravity Case	Wind Case	Seismic Case
Section: 1	724 / 1,000	724 / 1,330	724 / 1,330

Beam Shear Stresses:

Section: 1 Low Stress or Beam Shear suppressed under column/wall

Punching Shear Stresses:

Wall : 1	0.00 psi
Column : 2	3.47 psi
Column : 3	12.98 psi
Column : 4	10.29 psi
Column : 5	10.98 psi
Column : 6	2.05 psi

Reinforcing Standards per ASTM-A615

Reinforcing Requirements per ACI Ultimate Strength Methods:

Footing Sections:	Top Steel in ² , Design	Bottom Steel in ² , Design	Transverse in ² /ft, Spacing	Stirrups in ² , Spacing Not Req'd...
Section: 1	Strength:.. 0.00	0-#5	0.07	1-#5
Walls:				
Wall: 1	Strength:.. 0.00	0-#5		

Note: Strength = Steel Required for Strength..

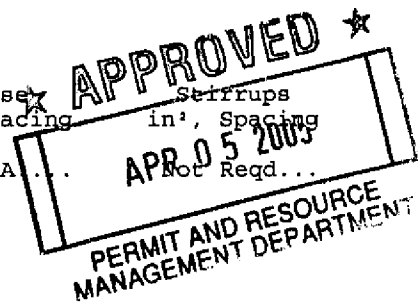

5/6

Loading Parameters:

Concrete Design Ultimate Strength Load Cases Considered:

1.4DL	1.4DL + 1.7LL	1.4DL + 1.7LL + 1.7SL
1.05DL + 1.275LL + 1.275WL	0.9DL + 1.3WL	1.05DL + 1.275LL + 1.0EQ
0.9DL + 1.0EQ		

Soil Load Cases Considered:

1.0DL	1.0DL + 1.0LL	1.0DL + 1.0LL + 1.0SL
1.0DL + 1.0LL + 1.0WL	0.667DL + 1.0WL	1.0DL + 1.0LL + 1.0EQ
0.667DL + 1.0EQ		

Un-Factored Loads, ft-kips:

	Dead Load		Live Load		Wind Load		Seismic Load		Other Load	
	FY	MZ	FY	MZ	FY	MZ	FY	MZ	FY	MZ
Wall :1	0.00	0.00	0.00	0.00	0.00	0.00	0.00	0.00	0.00	0.00
Column:2	0.66	0.00	0.90	0.00	0.00	0.00	0.00	0.00	0.00	0.00
Column:3	1.77	0.00	2.36	0.00	0.00	0.00	0.00	0.00	0.00	0.00
Column:4	1.33	0.00	2.06	0.00	0.00	0.00	0.00	0.00	0.00	0.00
Column:5	1.54	0.00	2.07	0.00	0.00	0.00	0.00	0.00	0.00	0.00
Column:6	0.47	0.00	0.71	0.00	0.00	0.00	0.00	0.00	0.00	0.00

Total Vertical Contact Forces:

1.0DL	= 17.019 kips
1.0DL + 1.0LL	= 25.109 kips
1.0DL + 1.0LL + 1.0SL	= 25.109 kips
1.0DL + 1.0LL + 1.0WL	= 25.109 kips
0.667DL + 1.0WL	= 15.099 kips
1.0DL + 1.0LL + 1.0EQ	= 25.109 kips
0.667DL + 1.0EQ	= 15.099 kips
Envelope Case	= 25.109 kips

☆ APPROVED ☆
 APR 05 2005
 PERMIT AND RESOURCE
 MANAGEMENT DEPARTMENT

6/6

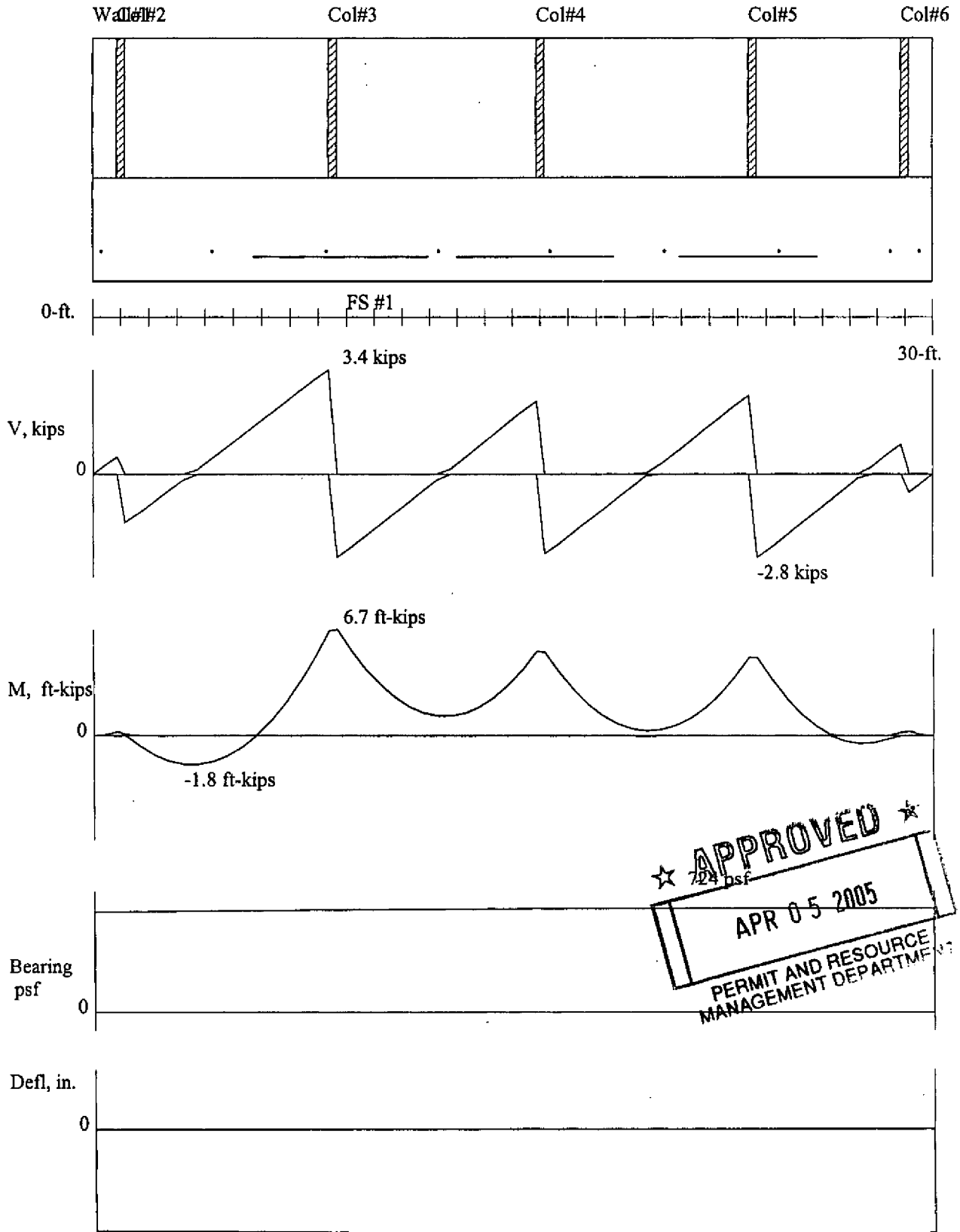

★ APPROVED ★
APR 05 2005
PERMIT AND RESOURCE
MANAGEMENT DEPARTMENT

0.241"

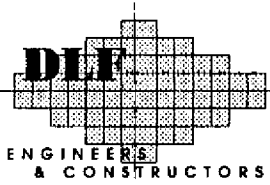

ENGINEERING CALCULATION SHEET

P.O. Box 717, Windsor, CA 95492 • (707) 838-1505 • FAX # (707) 838-1970 • email: difeng@msn.com

ENGINEERS & CONSTRUCTORS INC.

CUSTOMER Exchange Bank - Redwood
 LOCATION Cliffed Ranch

SHEET NO. 50004 | 90
 JOB NO. 14402
 DATE 3-3-02
 BY DF CHK'D _____

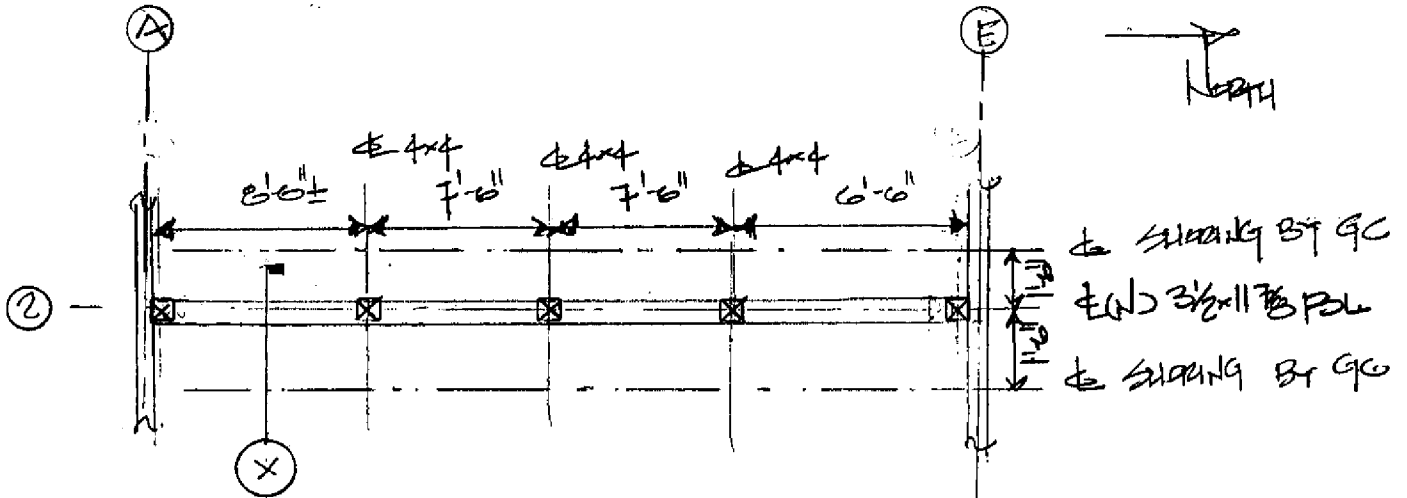

Plan View

1/8" = 1'-0"

END 3/4" PSL

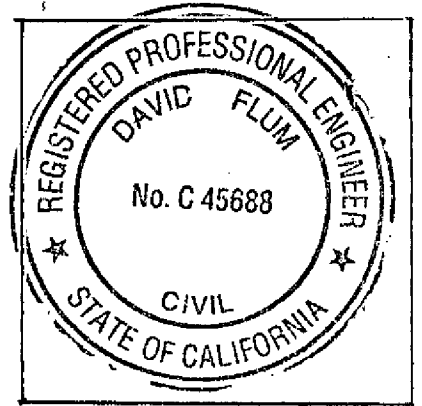

STAMP EXP 12-31-02

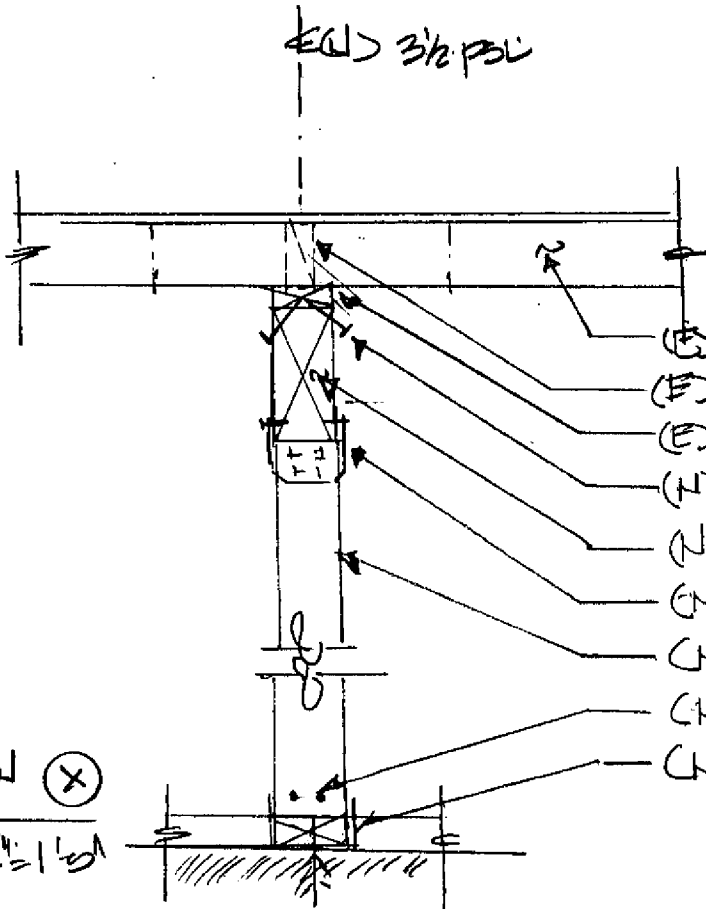

- (E) 2x6 Roof Joist
- (E) 2x6 Rafter (INSTALL)
- (E) 2x6 TOP TO ROWIN
- (N) 20d TAB NAIL (BY (E) FE)
- (N) STAPLING AND RESOURCES + MANAGEMENT DEPARTMENT
- (N) PC4 POST CAP
- (N) 4x4 DF#1 POST
- (N) (B) Ed TOE TO UCLAS FE (IF UCLAS)
- (N) 4x4 1/2" x 6 EXP BOLT TO (E) FOUND

SECTIONED (X)
 1/8" = 1'-0"

ENGINEERING CALCULATION SHEET

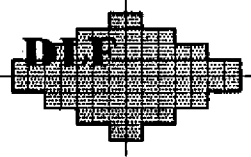

**ENGINEERS
& CONSTRUCTORS INC.**

P.O. Box 717, Windsor, CA 95492
(707) 838-1505 · FAX # (707) 838-1970

CUSTOMER EXCHANGE BANK

SHEET NO. 1 OF 4

JOB NO. 141404

DATE 12-09-04

LOCATION 400 DUTTON AVE

BY TMN CHK'D DLF

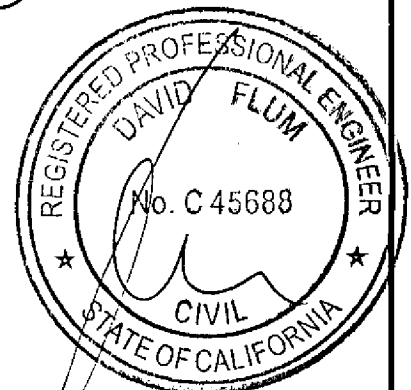
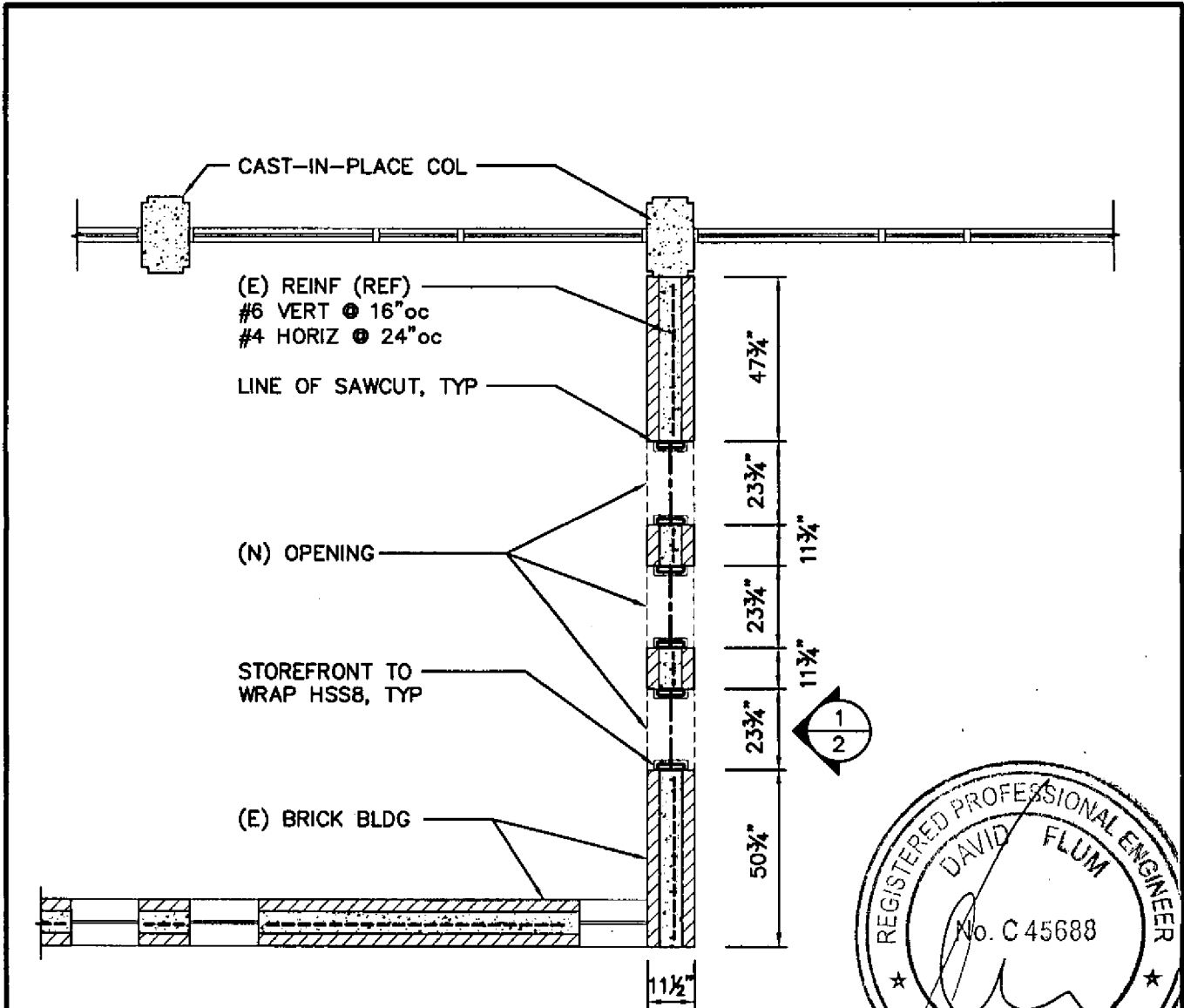

SUB 14

★ APPROVED ★ *Exp 12 31-06*

1	(N) OPENING IN (E) BRICK WALL	APR 05 2005	1
1/4" = 1'-0"		PERMIT AND RESOURCE MANAGEMENT DEPARTMENT	

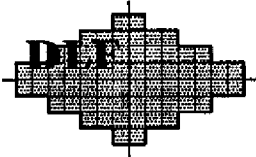

ENGINEERING CALCULATION SHEET

**ENGINEERS
& CONSTRUCTORS INC.**

P.O. Box 717, Windsor, CA 95492
(707) 838-1505 · FAX # (707) 838-1970

SHEET NO. 2 OF 4

JOB NO. 141404

DATE 12-09-04

BY TMN CHK'D DLF

CUSTOMER EXCHANGE BANK

LOCATION 400 DUTTON AVE

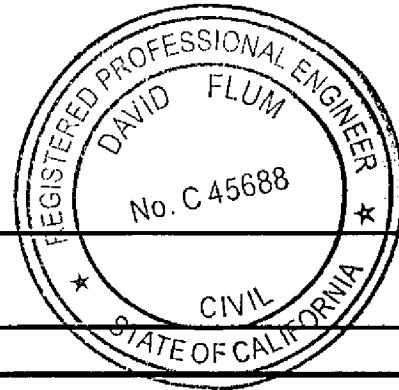
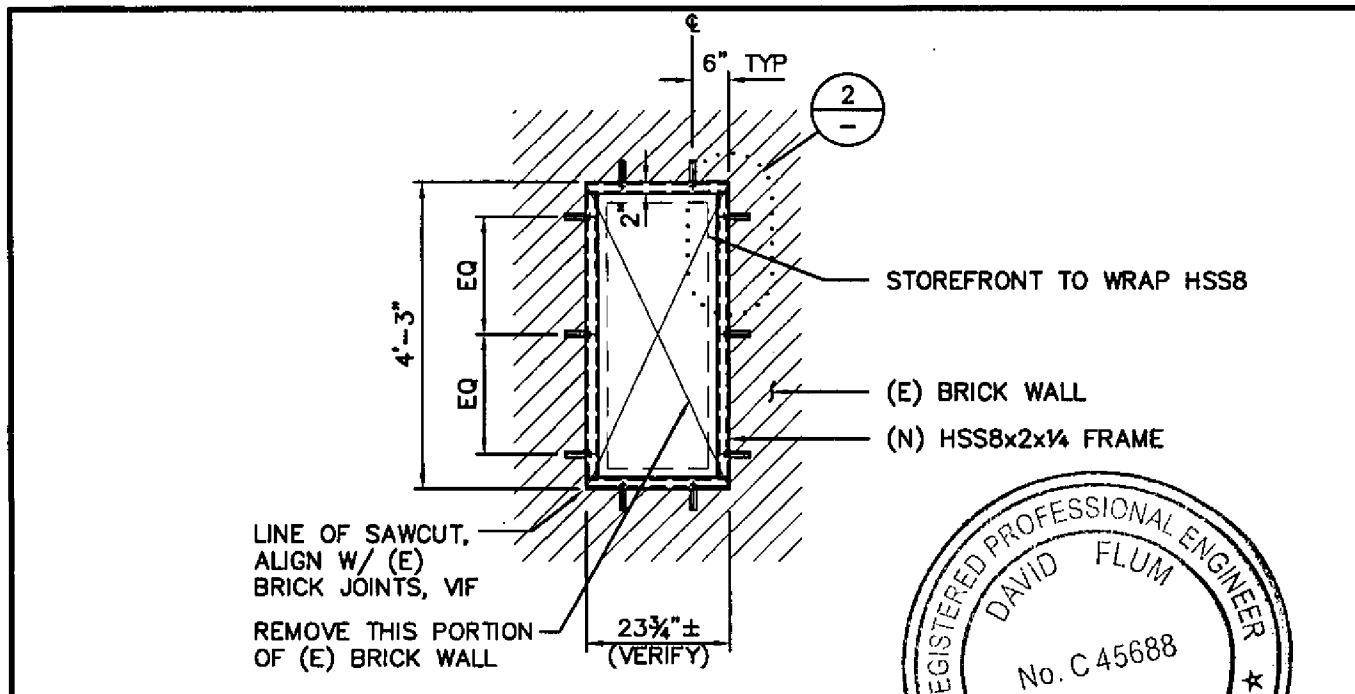

1	(N) OPENING IN (E) BRICK WALL
3/8" = 1'-0"	

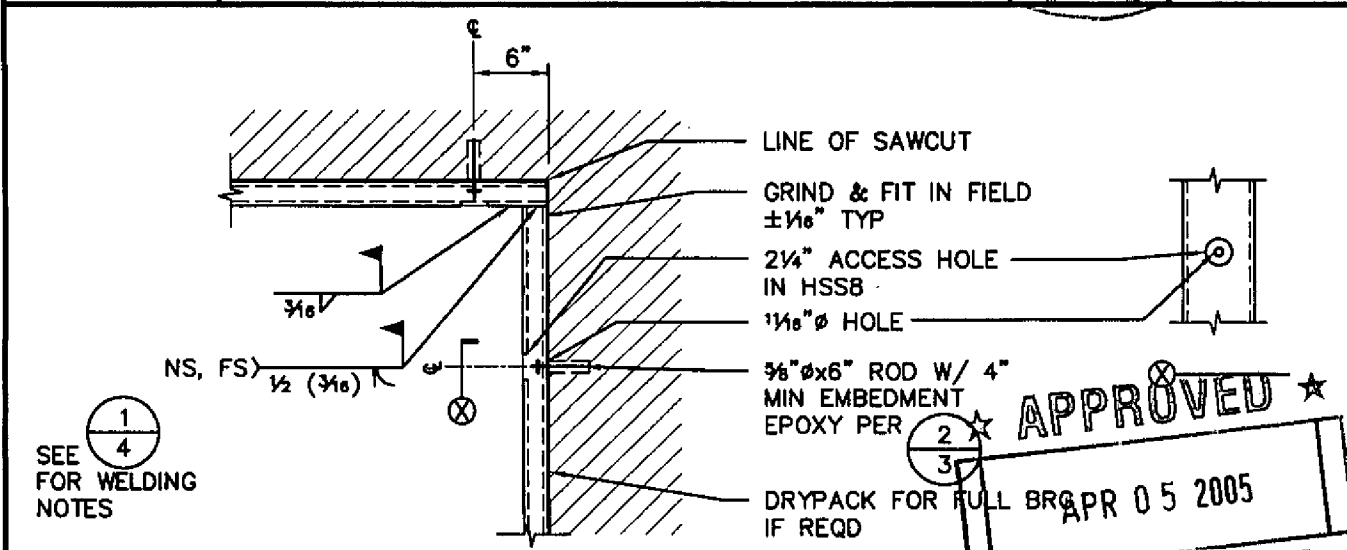

2	(N) OPENING IN (E) BRICK WALL	2
3/4" = 1'-0"		

PERMIT AND RESOURCE MANAGEMENT DEPARTMENT

ENGINEERING CALCULATION SHEET

**ENGINEERS
& CONSTRUCTORS INC.**

P.O. Box 717, Windsor, CA 95492
(707) 838-1505 · FAX # (707) 838-1970

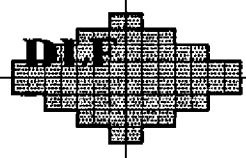

SHEET NO. 3 OF 4

CUSTOMER EXCHANGE BANK

JOB NO. 141404

DATE 12-09-04

LOCATION 400 DUTTON AVE

BY TMN CHK'D DLF

NOTE:

EXISTING DIMENSIONS AND CONDITIONS SHOWN ARE APPROXIMATE. CONDITIONS NOT SHOWN OR FORESEEN MAY ALTER NEW WORK AND MAY REQUIRE ADDITIONAL WORK. CONTRACTOR SHALL PROVIDE ENGINEER WRITTEN VERIFICATION OF DIMENSIONS AND CONDITIONS SHOWN PRIOR TO COMMENCEMENT OF NEW WORK.

CAUTION:

UTILITIES AND OTHER OBSTRUCTIONS MAY BE PRESENT. CONTRACTOR SHALL TAKE ALL NECESSARY ACTION TO DETERMINE EXACT LOCATION AND NATURE OF OBJECTS SUCH AS, BUT NOT LIMITED TO, PIPE, CONDUIT OR ANY OTHER INTERFERING STRUCTURES THAT ARE PRESENT IN THE AREA NEW WORK IS TO BE PERFORMED. CONTRACTOR SHALL PROVIDE ENGINEER WITH WRITTEN DOCUMENTATION OF HIS FINDINGS PRIOR TO COMMENCEMENT OF NEW WORK.

1	DEMO
-	

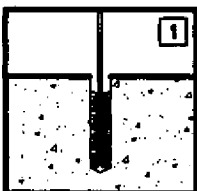

1
DRILL PROPER HOLE. CLEAN OUT HOLE. COMPLETE HOLE PREPARATION WITH USE OF NYLON BRUSH (DO NOT USE WIRE BRUSH)

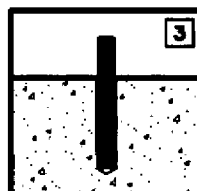

3
INSERT THE SELECTED ROD SLOWLY BY HAND INTO THE BOTTOM OF THE HOLE USING A SLOW TWISTING MOTION

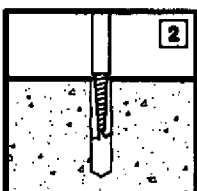

2
PRIOR TO PLACEMENT, DISCHARGE APPROXIMATELY ONE FLUID OUNCE OF EPOXY. EPOXY MUST BE UNIFORM IN COLOR. INSERT THE NOZZLE INTO THE BOTTOM OF THE HOLE AND FILL THE HOLE TO 1/2 THE HOLE DEPTH

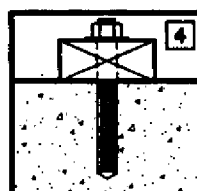

4
AFTER RECOMMENDED CURE TIME INSTALL AND TIGHTEN FIXTURE

EPOXY HOLE PREPARATION:

1. EPOXY SHALL BE ONE OF THE FOLLOWING:
HILTI C20.
EPONCA7.
RAW CHEMFAST.
SIMPSON SET.
2. HOLES FOR ADHESIVE ANCHOR SHALL BE DRILLED WITH A ROTARY DRILL.
3. HOLES FOR ADHESIVE ANCHOR SHALL BE THOROUGHLY CLEANED WITH THE FOLLOWING PROCEDURE:
 - A. BLOW OUT ALL DUST AND LOOSE MATERIAL WITH COMPRESSED AIR EXTENSION NOZZLE-PLACED AT BOTTOM OF HOLE.
 - B. CLEAN HOLE SURFACE WITH A NYLON BRUSH WHICH IS SLIGHTLY LARGER THAN THE HOLE DIAMETER.
 - C. BLOW OUT HOLE WITH COMPRESSED AIR PER A.
 - D. REPEAT A-C AS REQD. UNTIL ALL SURFACES ARE CLEAN AND DUST FREE.
4. EPOXY SHALL BE INSTALLED WHILE IN LIQUID FORM BY POURING OR INJECTING INTO CLEANED HOLE.

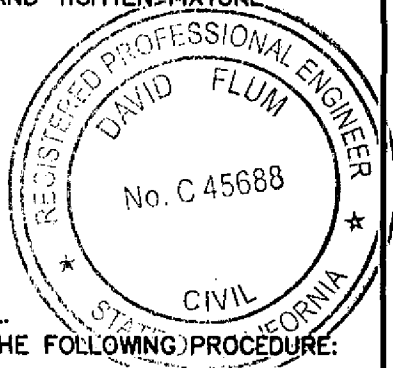

2	EPOXY ANCHOR BOLT DETAIL	3
NTS		

ENGINEERING CALCULATION SHEET

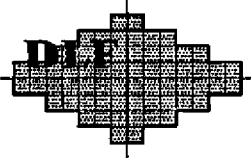

**ENGINEERS
& CONSTRUCTORS INC.**

P.O. Box 717, Windsor, CA 95492
(707) 838-1505 · FAX # (707) 838-1970

SHEET NO. 4 OF 4
 JOB NO. 141404
 DATE 12-09-04
 BY TMN CHK'D DLF

CUSTOMER EXCHANGE BANK
 LOCATION 400 DUTTON AVE

REQUIRED SPECIAL INSPECTIONS

IN ADDITION TO THE REGULAR INSPECTIONS, THE FOLLOWING ITEMS WILL REQUIRE SPECIAL INSPECTION IN ACCORDANCE WITH SECTION 1701 OF THE 2001 CALIFORNIA BUILDING CODE:

1. STRUCTURAL WELDING
 - A. ALL WELDING, BOTH SHOP AND FIELD.
 - B. INSPECTION TO BE PERFORMED DURING FABRICATION OF MATERIAL IN THE SHOP. SUBMIT ALL REPORTS & CERTIFICATIONS TO BUILDING DEPARTMENT AND COPIES TO ENGINEER OF RECORD PRIOR TO ERECTION.
 - C. INSPECTION TO BE PERFORMED DURING FIELD WELDING OF MATERIAL, CERTS AND REPORTS TO INSPECTOR WITHIN 2 WEEKS OF ERECTION.
 - D. STRUCTURAL WELDS SHALL BE DONE BY A CERTIFIED WELDER IN ACCORDANCE WITH THE CURRENTLY ADOPTED EDITION OF AWS D1.1.
 - E. FULL TIME INSPECTION REQUIRED DURING FINAL FIELD WELDING OF CONNECTIONS.
 - F. SPECIAL INSPECTOR TO BE HIRED BY OWNER.
 - G. REFER TO $\frac{2}{-}$ FOR STRUCTURAL STEEL.
2. EPOXIED DOWELS OR THREADED ROD
 - A. DURING INSTALLATION OF DOWELS OR THREADED ROD.

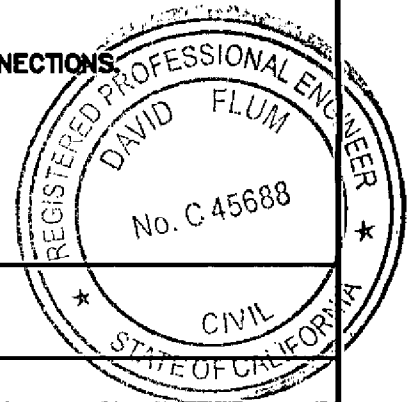

1	SPECIAL INSPECTION AND SPECIAL SUBMITTAL NOTES
-	

1. ALL STRUCTURAL STEEL FABRICATION AND ERECTION SHALL CONFORM TO THE SPECIFICATIONS AS STATED IN THE "MANUAL OF STEEL CONSTRUCTION" BY AISC (LATEST EDITION). STRUCTURAL STEEL SHALL MEET THE FOLLOWING MINIMUM REQUIREMENTS:

RECTANGULAR & SQUARE HSS	ASTM A500, GRADE B	Fy=46ksi
COMMON BOLTS	ASTM A307, GRADE A	
WASHERS	ASTM F436	
THREADED RODS	ASTM A36	Fy=36ksi
2. ALL STEEL MEMBERS SHALL BE GIVEN ONE SHOP COAT OF RUST-INHIBITIVE PRIMER PRIOR TO ERECTION. ALL STEEL EXPOSED TO WEATHER SHALL BE HOT-DIP GALVANIZED, STAINLESS STEEL OR EFFECTIVELY PROTECTED FROM CORROSION.
3. COMMON BOLTS SHALL CONFORM TO THE REQUIREMENTS OF ASTM A307. BOLT HOLES SHALL BE $\frac{1}{8}$ " LARGER IN DIAMETER THAN THE BOLT, UNLESS NOTED OTHERWISE (UNO) ON THE DRAWINGS. IF HIGH STRENGTH BOLTS ARE USED, BOLTS SHALL CONFORM TO THE REQUIREMENTS OF ASTM A325 OR A490.
4. WELDING ELECTRODES SHALL MEET AWS REQUIREMENTS. WELD METAL SHALL MATCH OR EXCEED TENSILE STRENGTH OF PARENT METAL. ELECTRODES SHALL BE E70XX FOR SHIELDED METAL ARC, F7XX-EXXX FOR SUBMERGED ARC, AND E70-X FOR GAS METAL ARC, UNO.
5. ALL STRUCTURAL WELDING SHALL BE PERFORMED BY A CERTIFIED WELDER IN ACCORDANCE WITH THE CURRENTLY ADOPTED EDITION OF AWS D1.1. SPECIAL INSPECTION REQUIRED FOR ALL WELDING PER ENGINEER OF RECORD. INSPECTIONS TO MEET THE REQUIREMENTS SET FORTH BY THE LOCAL BUILDING CODE.

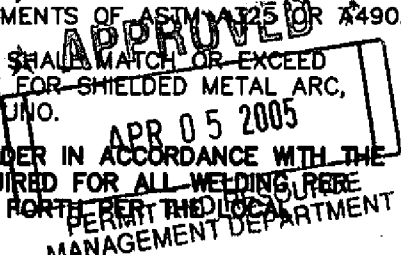

2	STRUCTURAL STEEL NOTES / SPECS				4
-					



MAIN OFFICE: P O BOX 933 WINDSOR CA 95492 PHONE 707.837.0920 FAX 707.838.0411
 BRANCH OFFICE LOCATIONS: VALLEJO & PETALUMA CA TOLL FREE PHONE 877.495.6662

SPECIAL INSPECTION REPORT

DAILY FINAL

CRT NO.	04-18	DSA FILE:	
PERMIT NO.		DSA APP. No.:	
DATE	04-18-05		
CLIENT	EXCHANGE BANK		
PROJECT NAME	EXCHANGE BANK		
PROJECT ADDRESS	400 DUTTON AVENUE SANTA ROSA CA		
CONTRACTOR	JIM MURPHY & ASSOCIATES		
SUBCONTRACTOR	IRON DOG WELDING		

SPECIAL INSPECTION ITEMS

- | | |
|--|---|
| <input type="checkbox"/> EARTHWORKS
<input type="checkbox"/> FTN EXCAVATION
<input type="checkbox"/> REINFORCEMENT STEEL
<input type="checkbox"/> POST TENSIONED STEEL
<input type="checkbox"/> CONCRETE PLACEMENT
<input type="checkbox"/> FIREPROOFING
<input type="checkbox"/> SCHMIDT HAMMER | <input type="checkbox"/> COMPACTION TESTS
<input type="checkbox"/> DRILLED PIERS
<input type="checkbox"/> EPOXY PLACEMENT
<input type="checkbox"/> PULL TEST
<input type="checkbox"/> STRUCTURAL MASONRY
<input type="checkbox"/> PACHOMETER |
|--|---|

ALL: THE FOLLOWING DESCRIBED PORTION OF THE ABOVE: **SPECIAL INSPECTION ITEM HAS BEEN COMPLETED**
 VISUALLY INSPECTED PLACEMENT OF (30) 5/8" ALL THREADS EPOXIED
 CHECKED FOR PROPER DIA & DEPTH ALL HOLES WERE WIRE BRUSHED AND AIR BLOWN CLEAN. EPOXY
 USE= SIMPSON ETF. ALL WORK WAS IN COMPLIANCE WITH PLANS AND SPECIFICATIONS OF PROJECT.

Based on my personal inspection of the construction procedures it is my opinion that the special inspection item items inspected were performed and materials used and installed meet the requirements of the DSA CBC IBC approved documents. Non-conforming or rejected portions of the item items were reworked, repaired or replaced and reinspected for compliance. Non conforming or rejected portions which did not receive a record of correction were reported to the following parties Contractor PI Architect

SPECIAL INSPECTOR / FIELD TECHNICIAN

 Peter Dawson
 PRINT FULL NAME

I declare under penalty of perjury that I prepared the above listed report and that all statements are true.

cc: AOR SEOR PI DSA



MAIN OFFICE: P O Box 933 WINDSOR CA 95492 PHONE 707.837.0920 FAX 707.838.0411
BRANCH OFFICE LOCATIONS: VALLEJO & PETALUMA CA TOLL FREE PHONE 877.495.6662

WELDING SPECIAL INSPECTION REPORT

FINAL REPORT

CRT No.	04-18	DSA FILE:	_____
PERMIT NO.	_____	DSA App. No.	_____
DATE	04-18-05		
CLIENT	EXCHANGE BANK		
PROJECT NAME	EXCHANGE BANK		
PROJECT ADDRESS	400 DUTTON AVENUE SANTA ROSA CA		
CONTRACTOR	JIM MURPHY AND ASSOCIATES		
FABRICATOR	IRON DOG		

Visually inspected the Weldments which were in progress completed this date
Shop Inspection Field Inspection Special Inspector _____ DA _____

WELDERS	NICK WILLIAMS	ID #	614-07-1430	WPS SETTINGS	YES <input checked="" type="checkbox"/>	NO <input type="checkbox"/>
				PROPER WELDING Mt'l.	YES <input checked="" type="checkbox"/>	NO <input type="checkbox"/>
				WELD SIZE VERIFIED	YES <input checked="" type="checkbox"/>	NO <input type="checkbox"/>
				UNDERCUT OK	YES <input checked="" type="checkbox"/>	NO <input type="checkbox"/>
				EACH PASS CLEANED	YES <input checked="" type="checkbox"/>	NO <input type="checkbox"/>
				POROSITY OK	YES <input checked="" type="checkbox"/>	NO <input type="checkbox"/>
				FILLER METAL STORAGE BEING USED	YES <input checked="" type="checkbox"/>	NO <input type="checkbox"/>

APPROVED WELDING PROCEDURES PROVIDED YES NO
 CHECKED WELDERS CERTIFICATION PAPERS YES NO
 NO CHANGE IN ENVIRONMENTAL CONDITIONS YES NO

Welding Special Inspection Report

<input type="checkbox"/> COMPLETED GROOVE PENETRATION WELD(S)	<input type="checkbox"/> PARTIAL GROOVE PENETRATION WELD(S)
<input checked="" type="checkbox"/> SINGLE PASS FILLET WELD(S)	<input type="checkbox"/> MULTI PASS FILLET WELD(S)
<input type="checkbox"/> FLARE BEVEL GROOVE WELD(S)	<input type="checkbox"/> DIRECT INDIRECT BUTT SPICED WELD(S)
<input type="checkbox"/> REINFORCING STEEL BAR(S) PREHEAT	<input type="checkbox"/> ARC SPOT <input type="checkbox"/> STITCH WELD(S) <input type="checkbox"/> METAL DECKING ga

DESCRIPTION/COMMENTS: HSS8 TUBE STEEL AT NEW OPENING IN EXISTING BRICK WALL PER DAVID FLUM PE
DRWGS 1-4 DATED 12/9/04 JOB # 141404

Based on my personal inspection of the construction procedures it is my opinion that the special inspection item items inspected were performed and materials used and installed meet the requirements of the DSA CBC IBC Approved documents. Non-conforming or rejected portions of the item items were reworked, repaired or replaced and reinspected for compliance. Non conforming or rejected portions which did not receive a record of correction were reported to the following parties Contractor PI Architect _____

CWI WELDING INSPECTOR

David C. Arnett
PRINT FULL NAME

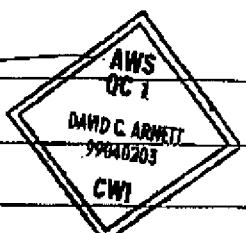

I declare under penalty of perjury that I prepared the above listed report and that all statements are true.

cc: AOR SEOR PI DSA