

**B**

Type

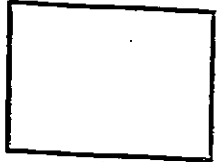

Plans

**BLD**16-4540

Permit Number

161

Street Number

Wembley Ct

Street Name

WM

Community Code

058-232-005

APN

# COUNTY OF SONOMA - PERMIT AND RESOURCE MANAGEMENT DEPARTMENT

2550 Ventura Avenue, Santa Rosa, CA 95403 (707) 565-1900 FAX (707) 565-1103

Please Print Your Name: \_\_\_\_\_ Date Applied: \_\_\_\_\_

## INFORMATION WITHIN HEAVY LINE TO BE COMPLETED BY APPLICANT

SITE LOCATION INFORMATION - PRINT CLEARLY

Site Address: 161 Wembley CT City: Santa Rosa ZIP: 95403

Cross-Street: \_\_\_\_\_ APN: 05822005 Project Name #: ( ) Project Fax #: ( )

Directions: \_\_\_\_\_ Email address: \_\_\_\_\_ Unit #: \_\_\_\_\_ Lot #: \_\_\_\_\_

Describe Project: Aluminum patio cover

Living Area: \_\_\_\_\_ Garage: \_\_\_\_\_ Decks: \_\_\_\_\_ Contract Price: \$11,000

OWNER NAME AND ADDRESS

Name: Mr. Durler Mailing Address: 161 Wembley CT

City: Santa Rosa State: CA ZIP: 95403

Day Ph: ( ) Fax: ( )

APPLICANT NAME AND ADDRESS

Name: Sonoma County Sunrooms Mailing Address: 3415 Santa Rosa Ave

City: Santa Rosa State: CA ZIP: 95407

Day Ph: ( 707-586-2710 ) Fax: ( )

CONTRACTOR INFORMATION

Company Name: Sonoma County Sunrooms Name: \_\_\_\_\_

Address: 3415 Santa Rosa Ave Address: \_\_\_\_\_

City: Santa Rosa State: CA ZIP: 95407 City: \_\_\_\_\_ State: \_\_\_\_\_ ZIP: \_\_\_\_\_

Day Ph: ( 707-586-2710 ) Fax: 707-586-2720 Day Ph: ( ) Fax: ( )

OTHER PERSONS (ARCHITECT, ENGINEER, ETC.)

Name: \_\_\_\_\_ Address: \_\_\_\_\_

City: \_\_\_\_\_ State: \_\_\_\_\_ ZIP: \_\_\_\_\_

Day Ph: ( ) Fax: ( )

WORKER'S COMPENSATION DECLARATION

I hereby affirm under penalty of perjury one of the following declarations:

I have and will maintain a certificate of consent to self-insure for worker's compensation, as provided for by Section 3700 of the Labor Code, for the performance of the work for which this permit is issued.

I have and will maintain worker's compensation insurance, as required by Section 3700 of the Labor Code, for the performance of the work for which this permit is issued. My worker's compensation insurance carrier and policy number are:

Carrier: Everest

Policy No.: 76001515461

(This section need not be completed if the permit is for one hundred dollars (\$100) or less.)

I certify that in the performance of the work for which this permit is issued, I shall not employ any person in any manner so as to become subject to the worker's compensation laws of California, and agree that if I should become subject to the worker's compensation provisions of Section 3700 of the Labor Code, I shall forthwith comply with those provisions.

Exp. Date: 7/17 Applicant: Paul Spaldy

**WARNING: FAILURE TO SECURE WORKER'S COMPENSATION COVERAGE IS UNLAWFUL, AND SHALL SUBJECT AN EMPLOYER TO CRIMINAL PENALTIES AND CIVIL FINES UP TO ONE HUNDRED THOUSAND DOLLARS (\$100,000), IN ADDITION TO THE COST OF COMPENSATION, DAMAGES AS PROVIDED FOR IN SECTION 3706 OF THE LABOR CODE, INTEREST, AND ATTORNEY'S FEES.**

OWNER-BUILDER DECLARATION

I hereby affirm under penalty of perjury that I am exempt from the Contractor's License Law for the following reason (Sec. 7031.5, Business and Professions Code: Any city or county which requires a permit to construct, alter, improve, demolish, or repair any structure, prior to its issuance, also requires the applicant for such permit to file a signed statement that he or she is licensed pursuant to the provisions of the Contractor's License Law (Chapter 9 (commencing with Section 7000) of Division 3 of the Business and Professions Code) or that he or she is exempt therefrom and the basis for the alleged exemption. Any violation of Section 7031.5 by any applicant for a permit subjects the applicant to a civil penalty of not more than five hundred dollars (\$500).):

I, as owner of the property, or my employees with wages as their sole compensation, will do the work, and the structure is not intended or offered for sale (Sec. 7044 Business and Professions Code: The Contractors License Law does not apply to an owner of property who builds or improves thereon, and who does such work himself or herself or through his or her own employees, provided that such improvements are not intended or offered for sale. If, however, the building or improvement is sold within one year of completion, the owner-builder will have the burden of proving that he or she did not build or improve for the purpose of sale.)

I, as owner of the property, am exclusively contracting with licensed contractors to construct the project (Sec. 7044, Business and Professions Code: The Contractors License Law does not apply to an owner of property who builds or improves thereon, and who contracts for such projects with a contractor(s) licensed pursuant to the Contractors License Law.)

I am exempt under Sec. \_\_\_\_\_, B & P.C. for this reason \_\_\_\_\_

By my signature below I acknowledge that, except for my personal residence in which I must have resided for at least one year prior to completion of the improvements covered by this permit, I cannot legally sell a structure that I have built as an owner-builder if it has not been constructed in its entirety by licensed contractors. I understand that a copy of the applicable law, Section 7044 of the Business and Professions Code, is available upon request when this application is submitted or at the following website: <http://www.leginfo.ca.gov/calaw.html>.

Date: \_\_\_\_\_ Signature of Property Owner or Authorized Agent: \_\_\_\_\_

LICENSED CONTRACTOR'S DECLARATION

I hereby affirm under penalty of perjury that I am licensed under provisions of Chapter 9 (commencing with Section 7000) of Division 3 of the Business and Professions Code, and my license is in full force and effect.

Lic. Class: B Lic. No.: 799009

Exp. Date: 8/17 Contractor: Paul Spaldy

ASBESTOS DECLARATION

Written asbestos notification pursuant to Part 61 of Title 40 of the Code of Federal Regulations is required when asbestos exists in buildings, or portions thereof, undergoing demolition. I hereby declare that demolition authorized by this permit is from construction that (  does ) (  does not ) contain asbestos, or that  no demolition is authorized by this permit.

I certify that I have read this application and affirm under penalty of perjury that the above information is correct. I agree to comply with all local Ordinances and State laws relating to building construction. I hereby authorize representatives of the County of Sonoma to enter upon the above-mentioned property for inspection purposes. If, after making the Certificate of Exemption for the Worker's Compensation provision of the Labor Code I should become subject to such provisions, I will forthwith comply. In the event I do not comply with the Workman's Compensation law, this permit shall be deemed revoked.

PERMITTEE SIGNATURE: Paul Spaldy

ADDRESS: \_\_\_\_\_ CITY: \_\_\_\_\_ ZIP: \_\_\_\_\_

Contractor  Owner  Other Licensed Professional

CONSTRUCTION LENDING DECLARATION

I hereby affirm under penalty of perjury that there is a construction lending agency for the performance of the work for which this permit is issued. (Sec. 3097, Civ. C.)

Lenders Name: \_\_\_\_\_

Lenders Address: \_\_\_\_\_

FOR DEPARTMENT USE

Zoning: R1B7, SR VEH File No. \_\_\_\_\_ Acres: .32

Existing Use/Structures: SFD

Proposed Use/Structures: patio cover

Zoning Min. Yard Requirements: Front 20 Left 5 Right 5 Back 20

NOTE: Fire Safe Standards require all parcels greater than 1 Acre to have a min. 30' setback unless mitigated.  Mitigation Required  Address subject to change

Approval for Permit Issuance: \_\_\_\_\_ Approval for Occupancy: \_\_\_\_\_

By: \_\_\_\_\_ Date: \_\_\_\_\_

By: Hannah Spencer Date: 9-2-16

Conditions: outside of SR

Sewer Connection:  Available  Fees Paid

Approved by: \_\_\_\_\_ Date: \_\_\_\_\_

Road Encroachment:  Fees Paid

Approved by: \_\_\_\_\_ Date: \_\_\_\_\_

Septic System Permit/Clearance # \_\_\_\_\_

Approved by: \_\_\_\_\_ Date: \_\_\_\_\_

Flood Zone:  Yes  No 100 Year Flood Elevation: \_\_\_\_\_

Site Review \_\_\_\_\_

Drainage Review: \_\_\_\_\_

Approved by: \_\_\_\_\_ Date: \_\_\_\_\_

Fire: \_\_\_\_\_

Approved by: \_\_\_\_\_ Date: \_\_\_\_\_

Code Enforcement Violation  Yes  No Violation # \_\_\_\_\_

This permit is limited to \_\_\_\_\_ days.

Work Authorized: Free standing 210 sq ft Aluminum patio cover 9' high

Plans Approved  Post FIRM  Aiqist Priolo Report Available

No Plans Subject to Field Inspection  Pre FIRM  Geotechnical report Available

Planchek Cleared By: CB Date: 9/2/16 Type of Construction: VB Occupancy: U No. of Stories: 1 No. of Bedrooms: 1

Permit Cleared for Issuance By: CB Date: 9/2/16 Auto. Fire Sprinklers Req'd: \_\_\_\_\_ No. of Units: \_\_\_\_\_ Certificate of Occupancy: \_\_\_\_\_

Machine Space for Permit Fee

PAYMENT RECEIVED

\$ 11,000

SEP 02 2016

PERMIT AND RESOURCE MANAGEMENT DEPARTMENT

COUNTY OF SONOMA

Distribution: White - File County Applicant Blue - Assessor - Cardstock - Inspector

JOB ADDRESS: 161 WEMBLEY CT, WIS PERMIT NUMBER: BLD 16-4540 INSPECTION AREA: 11

**THIS PERMIT SHALL EXPIRE IN THREE(3) YEARS FROM DATE FEES ARE PAID UNLESS OTHERWISE NOTED BY CODE ENFORCEMENT**

131) SPECIAL INSPECTION REQUIRED		<input type="checkbox"/> YES	<input checked="" type="checkbox"/> NO	IF YES, SEE ADDITIONAL SHEET
INSPECTION RECORD	DATE	NAME	REMARKS	
101) ROUGH GRADING			Aluminum patio cover with six (6) post and concrete piers (free standing)	
103) FOUNDATION				
FORMS/SETBACK				
FOOTING				
106) UFER GROUND #				
104) CAISSONS/PIERS (6)	9/28/16	Parmy		
105) SLAB				
107) UNDERGROUND UTILITIES				
110) MASONRY				
109) RETAINING WALLS				
113) FIREPLACE				
FOOTING				
HEARTH/PROTECTION				
THROAT				
114) CHIMNEY				
120) UNDERFLOOR/UNDERSLAB				
115) HYDRONICS				
116) U/F ELECTRICAL				
117) U/F MECHANICAL				
118) U/F PLUMBING				
119) U/F FRAMING				
139) U/F INSULATION				
126) SHEAR WALLS				
<input type="checkbox"/> INTERIOR	<input type="checkbox"/> EXTERIOR			
127) DIAPHRAGMS				
<input type="checkbox"/> ROOF	<input type="checkbox"/> FLOOR			
134) SIDING/SHEATHING				
125) HOLD DOWNS				
132) CLOSE-IN				
122) ROUGH ELECTRICAL				
123) ROUGH MECHANICAL				
124) ROUGH PLUMBING				
128) ROUGH FRAME				
160) SMOKE DETECTORS				
139) INSULATION				
142) WALLBOARD				
143) FIREWALLS				
135) STUCCO/PLASTER				
<input type="checkbox"/> LATH	<input type="checkbox"/> SCRATCH			
137) ROOFING				
130) TUB/SHOWER PAN				
162) FIRE DAMPERS/DOORS				
164) SUSPENDED CEILING				
<input type="checkbox"/> ROUGH ELEC.	<input type="checkbox"/> ROUGH MECH.			
165) EXITING - RAMPS/STAIRS				
163) HANDRAILS/GUARDRAILS				
CORRIDORS/DOORS				
166) ACCESSIBILITY COMPLIANCE			650) SUSMP INSPECTION	
144) WATER TANKS			651) NPDES EROSION COMPLIANCE	
<input type="checkbox"/> SLAB	<input type="checkbox"/> WALLS		652) NPDES SEDIMENT COMPLIANCE	
170) TEMPORARY OCCUPANCY			653) NPDES DOCS/SWPPP	
171) TEMPORARY ELECTRICAL			FIRE INSPECTION REQUIRED	DATE
172) TEMPORARY GAS			<input type="checkbox"/> Yes <input checked="" type="checkbox"/> No	NAME
174) ELECTRIC METER AUTHORIZATION			759) KNOX BOX	
152) PANEL BOARDS/SERVICE			760) PROPANE TANK HOLD DOWNS	
189) SEPTIC ELECTRIC FINAL			770) SPRINKLER FINAL	
175) GAS METER AUTHORIZATION			771) ABOVEGROUND HYDROSTATIC	
153) GAS PRESSURE TEST			772) UNDERGROUND HYDROSTATIC	
HOUSE	YARD		773) UNDERGROUND FLUSH	
190) MANUF. HOME FOUNDATION			774) THRUST BLOCKS	
191) MANUF. HOME INSTALLATION			775) PIPE WELD	
CONTINUITY			776) HYDRANTS/APPLIANCES	
STAIRS/SKIRTS			777) PUMP ACCEPTANCE	
RIDGE BOLTING			778) WATER SUPPLY/TANK	
193) MANUF. HOME COND. FINAL			779) ALARM SYSTEM	
SWIMMING POOLS			780) HOOD & DUCT SYSTEM	
194) PRE-GUNITE			781) ABOVEGROUND TANK/DISPENSER	
195) PRE-DECK			198) FIRE FINAL	
196) PRE-PLASTER/FENCE			CLEARANCES:	
197) VINYL/FIBERGLASS POOL EXCAVATION			FIRE	<input type="checkbox"/> Local <input type="checkbox"/> County
102) GRADING FINAL			HEALTH DEPARTMENT	
176) ELECTRICAL FINAL			ZONING	
177) MECHANICAL FINAL			SANITATION	
178) PLUMBING FINAL				
199) FINAL	10/25/16	Parmy		
OCCUPANCY (OK TO OCCUPY)			PLAN RETENTION REQUIRED	<input type="checkbox"/> Yes <input type="checkbox"/> No

PERMIT # ASD16-4540

DURLER  
161 WEMBLEY CT  
SANTA ROSA, Ca. 95403

FREE STANDING  
COVER

SONOMA COUNTY  
**SUNROOMS**  
SINCE 1984

3415 Santa Rosa Avenue  
Santa Rosa, Ca. 95407  
707-586-2710

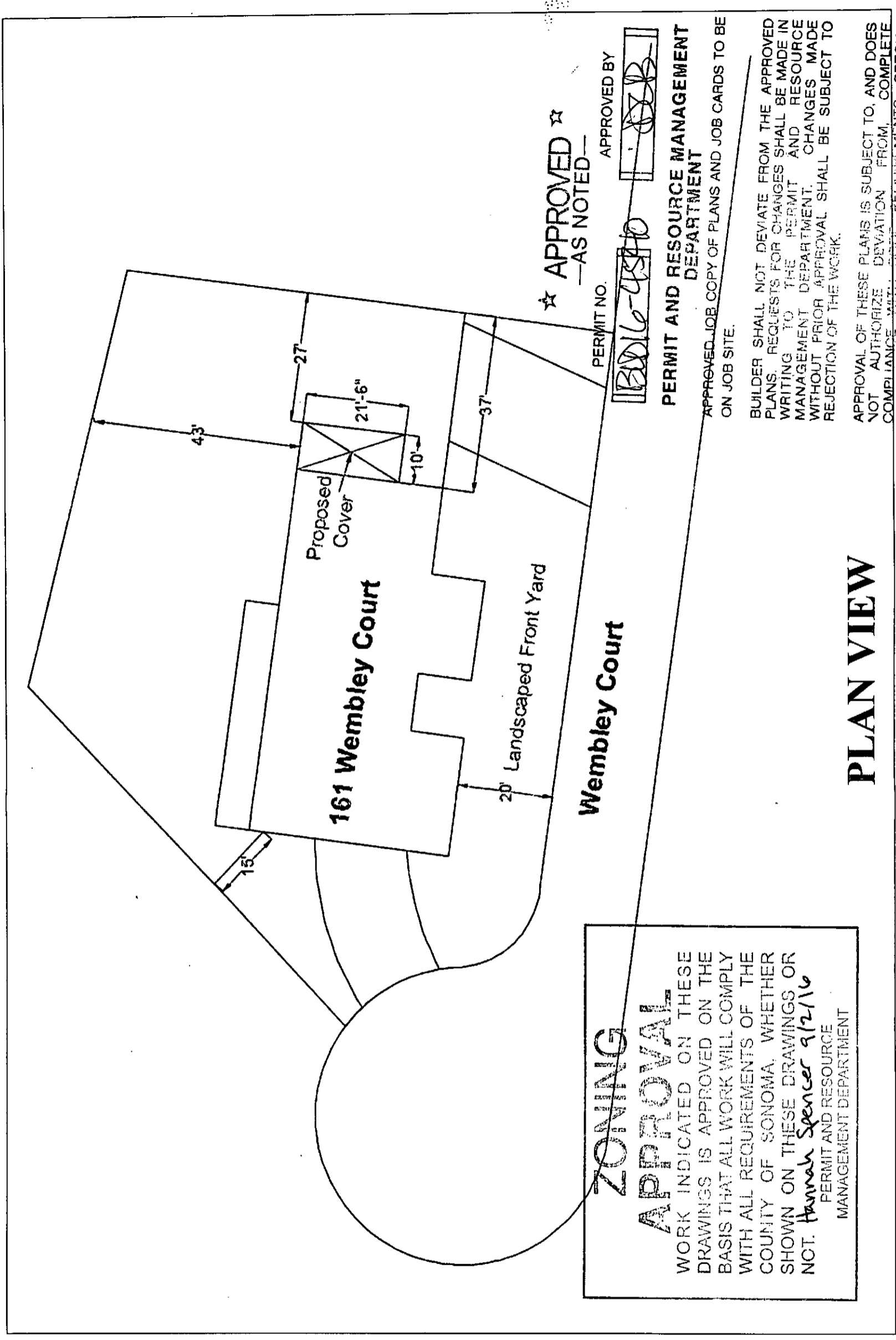

★ APPROVED ★  
—AS NOTED—

APPROVED BY  
PERMIT NO. BD16-4510

PERMIT AND RESOURCE MANAGEMENT  
DEPARTMENT

APPROVED JOB COPY OF PLANS AND JOB CARDS TO BE  
ON JOB SITE.

BUILDER SHALL NOT DEVIATE FROM THE APPROVED  
PLANS. REQUESTS FOR CHANGES SHALL BE MADE IN  
WRITING TO THE PERMIT AND RESOURCE  
MANAGEMENT DEPARTMENT. CHANGES MADE  
WITHOUT PRIOR APPROVAL SHALL BE SUBJECT TO  
REJECTION OF THE WORK.

APPROVAL OF THESE PLANS IS SUBJECT TO, AND DOES  
NOT AUTHORIZE DEVIATION FROM, COMPLETE  
COMPLIANCE WITH ALL LOCAL REQUIREMENTS. SPECIAL  
INSPECTIONS WHEN REQUIRED AND FIELD INSPECTION.

PLEASE READ ALL PERTINENT SECTIONS OF  
APPLICABLE CODES.

### PLAN VIEW

**ZONING  
APPROVAL**  
WORK INDICATED ON THESE  
DRAWINGS IS APPROVED ON THE  
BASIS THAT ALL WORK WILL COMPLY  
WITH ALL REQUIREMENTS OF THE  
COUNTY OF SONOMA, WHETHER  
SHOWN ON THESE DRAWINGS OR  
NOT. *Hannah Spencer 9/2/16*  
PERMIT AND RESOURCE  
MANAGEMENT DEPARTMENT

*FILE COPY BD16-4510*

DURLER  
161 WEMBLEY CT  
SANTA ROSA, Ca. 95403

FREE STANDING  
COVER

SONOMA COUNTY  
**SUNROOMS**  
SINCE 1984

3415 Santa Rosa Avenue  
Santa Rosa, Ca. 95407  
707-586-2710

House

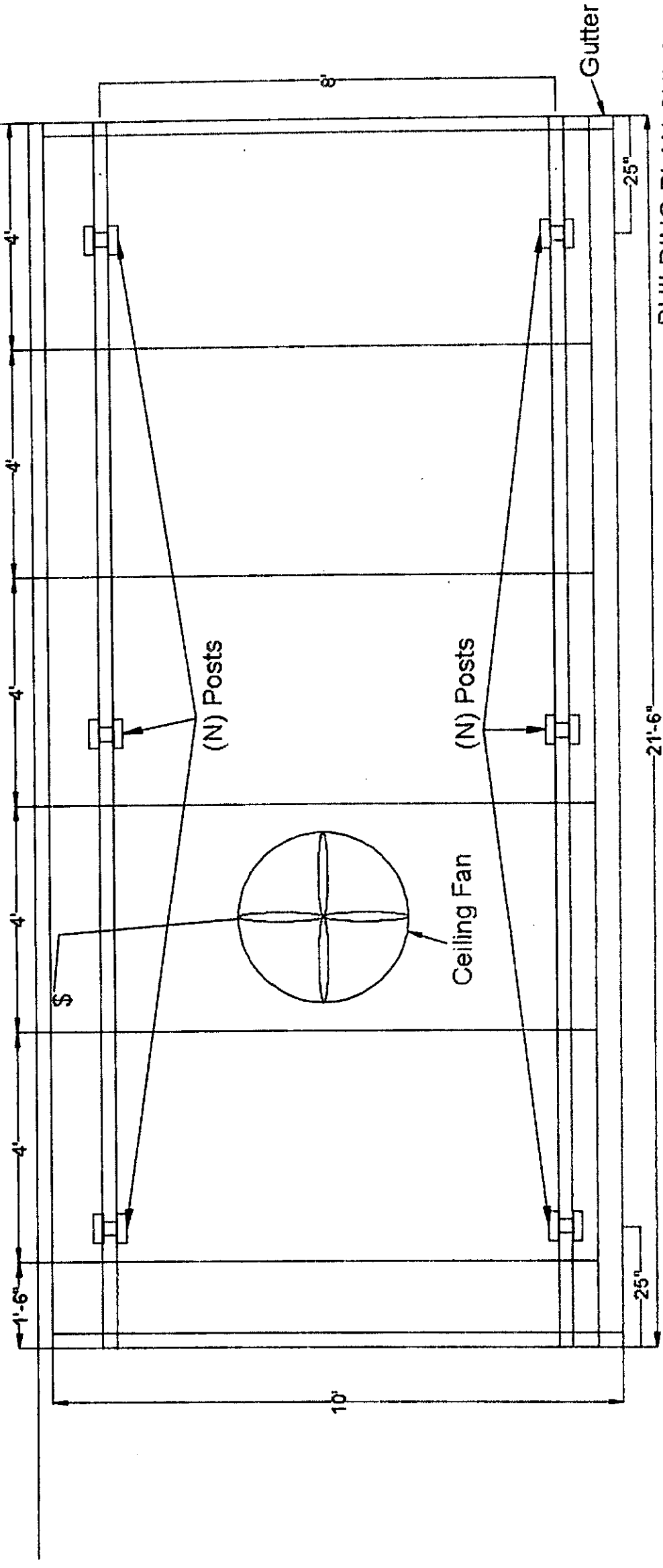

BUILDING PLAN CHECK

★ APPROVED ★

SEP 02 2016

PERMIT AND RESOURCE  
MANAGEMENT DEPARTMENT

TOP VIEW

DURLER  
161 WEMBLEY CT  
SANTA ROSA, Ca. 95403

FREE STANDING  
COVER

SONOMA COUNTY  
**SUNROOMS**  
SINCE 1984

3415 Santa Rosa Avenue  
Santa Rosa, Ca. 95407  
707-586-2710

