

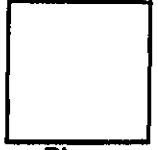

Type



Plans

GRD06-0269

Permit Number

1289

Street Number

Sebastopol Rd

Street Name

BEL

Community Code

125-091-035

APN

COUNTY OF SONOMA - PERMIT AND RESOURCE MANAGEMENT DEPARTMENT

2550 Ventura Avenue, Santa Rosa, CA 95403 (707) 565-1900 FAX (707) 565-1103

Please Print
Your Name: **Bill Wiggins**

Date Applied:

INFORMATION WITHIN HEAVY LINE TO BE COMPLETED BY APPLICANT

SITE LOCATION INFORMATION - PRINT CLEARLY

Site Address: 1289 Sebastopol Road	City: SANTA ROSA	ZIP: 954
Cross-Street: Burbank Ave.	APN: 125-091-035	Project Phone #: () NA
Directions:	Subd. Name: Q	Project Fax #: () NA
Describe Project: excavate a 300' of trench, 15' deep for purposes of installing remediation system	Living Area	Contract Price: \$10,000
	Garage Decks	

OWNER NAME AND ADDRESS			APPLICANT NAME AND ADDRESS		
Name: Pete / Shad Skikos			Name: Trans Tech Consultants		
Mailing Address: 1289 Sebastopol Road			Mailing Address: 930 Shiloh Rd, Bldg 4, Ste J		
City: Santa Rosa	State: CA	ZIP:	City: Windsor	State: CA	ZIP: 95492
Day Ph: 707 575-3000	Fax: ()		Day Ph: 707 575-8622	Fax: 707 837-7334	

CONTRACTOR INFORMATION			OTHER PERSONS (ARCHITECT, ENGINEER, ETC.)		
Company Name: Trans Tech Consultants			Name: Bill Wiggins		
Address: 930 Shiloh Rd., Bldg. 4, Ste J			Address: 930 Shiloh Rd		
City: Windsor	State: CA	ZIP: 95492	City: Windsor	State: CA	ZIP: 95492
Day Ph: 707 575-8622	Fax: 707 837-7334		Day Ph: () 575-8622	Fax: () 837-7334	

WORKER'S COMPENSATION DECLARATION

I hereby affirm under penalty of perjury one of the following declarations:

I have and will maintain a certificate of consent to self-insure for worker's compensation, as provided for by Section 3700 of the Labor Code, for the performance of the work for which this permit is issued.

I have and will maintain worker's compensation insurance, as required by Section 3700 of the Labor Code, for the performance of the work for which this permit is issued. My worker's compensation insurance carrier and policy number are:

Carrier: **Northern Insurance Co. of New York**
Policy No: **0151284900**

(This section need not be completed if the permit is for one hundred dollars (\$100) or less.)

I certify that in the performance of the work for which this permit is issued, I shall not employ any person in any manner so as to become subject to the worker's compensation laws of California, and agree that if I should become subject to the worker's compensation provisions of Section 3700 of the Labor Code, I shall forthwith comply with those provisions.

Exp. Date: **3/1/07** Applicant: **[Signature]**

WARNING: FAILURE TO SECURE WORKER'S COMPENSATION COVERAGE IS UNLAWFUL, AND SHALL SUBJECT AN EMPLOYER TO CRIMINAL PENALTIES AND CIVIL FINES UP TO ONE HUNDRED THOUSAND DOLLARS (\$100,000), IN ADDITION TO THE COST OF COMPENSATION, DAMAGES AS PROVIDED FOR IN SECTION 3708 OF THE LABOR CODE, INTEREST, AND ATTORNEY'S FEES.

CONSTRUCTION LENDING DECLARATION

I hereby affirm under penalty of perjury that there is a construction lending agency for the performance of the work for which this permit is issued. (Sec. 3097, Civ. C.)

Lenders Name _____
Lenders Address _____

FOR DEPARTMENT USE

Zoning: **M1** File No. _____ Acres _____
Existing Use/Structures: **warehouse, truck terminal**
Proposed Use/Structures: **grading, remediation**
Zoning Min. Yard Requirements: Front _____ Right _____ Back _____
NOTE: Fire Safe Standards require all parcels greater than 1 Acre to have a min. 25' setback unless mitigated. Mitigation Required Address subject to change

Approval for Issuance: _____ Approval for Occupancy: _____
By: _____ Date: **8/28/06**

Conditions: **Fuel Tank**

OWNER-BUILDER DECLARATION

I hereby affirm under penalty of perjury that I am exempt from the Contractor's License Law for the following reason (Sec. 7031.5, Business and Professions Code: Any city or county which requires a permit to construct, alter, improve, demolish, or repair any structure, prior to its issuance, also requires the applicant for such permit to file a signed statement that he or she is licensed pursuant to the provisions of the Contractor's License Law (Chapter 9 (commencing with Section 7000) of Division 3 of the Business and Professions Code) or that he or she is exempt therefrom and the basis for the alleged exemption. Any violation of Section 7031.5 by any applicant for a permit subjects the applicant to a civil penalty of not more than five hundred dollars (\$500).):

I, as owner of the property, or my employees with wages as their sole compensation, will do the work, and the structure is not intended or offered for sale (Sec. 7044 Business and Professions Code: The Contractor's License Law does not apply to an owner of property who builds or improves thereon, and who does such work himself or herself or through his or her own employees, provided that such improvements are not intended or offered for sale. If, however, the building or improvement is sold within one year of completion, the owner-builder will have the burden of proving that he or she did not build or improve for the purpose of sale.).

I, as owner of the property, am exclusively contracting with licensed contractors to construct the project (Sec. 7044, Business and Professions Code: The Contractor's License Law does not apply to an owner of property who builds or improves thereon, and who contracts for such projects with a contractor(s) licensed pursuant to the Contractor's License Law.).

I am exempt under Sec. _____, B & P.C. for this reason _____

Date _____ Owner _____

LICENSED CONTRACTOR'S DECLARATION

I hereby affirm under penalty of perjury that I am licensed under provisions of Chapter 9 (commencing with Section 7000) of Division 3 of the Business and Professions Code, and my license is in full force and effect.

Lic. Class: **AHAZ** Lic. No: **697833**

Exp. Date: **10/31/06** Contractor: **TRANSTECH CONSULTANTS**

ASBESTOS DECLARATION

Written asbestos notification pursuant to Part 61 of Title 40 of the Code of Federal Regulations is required when asbestos exists in buildings, or portions thereof, undergoing demolition. I hereby declare that demolition authorized by this permit is from construction that does does not contain asbestos, or that no demolition is authorized by this permit.

I certify that I have read this application and affirm under penalty of perjury that the above information is correct. I agree to comply with all local Ordinances and State laws relating to building construction. I hereby authorize representatives of the County of Sonoma to enter upon the above-mentioned property for inspection purposes. If, after making the Certificate of Exemption for the Worker's Compensation provision of the Labor Code I should become subject to such provisions, I will forthwith comply. In the event I do not comply with the Worker's Compensation law, this permit shall be deemed revoked.

PERMITTEE SIGNATURE: **[Signature]** Date: **8/28/06**
ADDRESS: **930 Shiloh Rd, Ste J** CITY: **Windsor** ZIP: **95492**

Contractor Owner Other Licensed Professional

Sewer Connection: Available Fees Paid
Approved by: **[Signature]** Date: **8-28-06**

Road Encroachment: Fees Paid
Approved by: _____ Date: _____

Septic System Permit/Clearance # **N/A**
Approved by: _____ Date: _____

Flood Zone: Yes No 100 Year Flood Elevation: _____

Site Review _____

Drainage Review: **[Signature]** Date: **9-11-06**

Fire: Approved by: _____ Date: _____

Code Enforcement Violation Yes No Violation # _____

This permit is limited to _____ days.

Work Authorized: _____

Plans Approved Post FIRM Alquist Priolo Report Available
 No Plans Subject to Field Inspection Pre FIRM Geotechnical report Available

Plancheck Cleared By: **[Signature]** Date: **9-11-06** Type of Construction: _____ Occupancy: _____ No. of Stories: _____ No. of Bedrooms: _____

Permit Cleared for Issuance: **[Signature]** Date: **9-19-06** Auto. Fire Sprinklers Req'd: _____ No. of Units: _____ Certificate of Occupancy: _____

PAYMENT
\$ _____ Multiple State Permit Fee

OCT 10 2006

PERMIT AND RESOURCE MANAGEMENT DEPARTMENT
COUNTY OF SONOMA

Final Date: _____ Inspector: _____

THIS PERMIT SHALL EXPIRE IN THREE(3) YEARS FROM DATE FEES ARE PAID UNLESS OTHERWISE NOTED BY CODE ENFORCEMENT

JOB ADDRESS: **1289 Sebastopol Rd, Santa Rosa**
PERMIT NUMBER: **GRD06-0269**
INSPECTION AREA: **9**



License Detail
Contractor License # 697833

CALIFORNIA CONTRACTORS STATE LICEN

DISCLAIMER

A license status check provides information taken from the CSLB license data base. Before on this information, you should be aware of the following limitations:

- CSLB complaint disclosure is restricted by law (B&P 7124.6). If this entity is subject to complaint disclosure, a link for complaint disclosure will appear below. Click on the link button to obtain complaint and/or legal action information.
- Per B&P 7071.17, only construction related civil judgments reported to the CSLB are disclosed.
- Arbitrations are not listed unless the contractor fails to comply with the terms of the arbitration.
- Due to workload, there may be relevant information that has not yet been entered on the Board's license data base.

GRW 06-0269

Extract Date: **09/19/2006**

***** Business Information *****

TRANS TECH CONSULTANTS
 930 SHILOH ROAD, BLDG 44, # J
 WINDSOR, CA 95492
 Business Phone Number: (707) 575-8622

Entity: **Corporation**
 Issue Date: **10/25/1994** Expire Date: **10/31/2006**

***** License Status *****

This license is current and active. All information below should be reviewed.

***** Additional Status Information *****

The renewal application has been received but not yet processed.

***** Classifications *****

Class	Description
A	GENERAL ENGINEERING CONTRACTOR

***** Certifications *****

Cert	Description
HAZ	HAZARDOUS SUBSTANCES REMOVAL

***** Bonding Information *****

CONTRACTOR'S BOND: This license filed Contractor's Bond number **10124670** in the an **\$10,000** with the bonding company **AMERICAN CONTRACTORS INDEMNITY COMPANY.**
Effective Date: **07/20/2004**

Contractor's Bonding History

BOND OF QUALIFYING INDIVIDUAL(1): The Responsible Managing Officer (RMO) WI **CLYDE WIGGINS** certified that he/she owns 10 percent or more of the voting stock/equity corporation. A bond of qualifying individual is **not** required.
Effective Date: **07/07/1998**

BQI's Bonding History

***** Workers Compensation Information *****

This license has workers compensation insurance with the **NORTHERN INSURANCE COMPANY OF NEW YORK**
Policy Number: **WC151284900** Effective Date: **03/01/2006** Expire Date: **03/01/2007**

Workers Compensation History

Personnel listed on this license (current or disassociated) are listed on other licenses

6/19/06 0269

Personnel List **Other Licenses**

License Number Request **Contractor Name Request** **Personnel Name Request**
Salesperson Request **Salesperson Name Request**

© 2006 State of California. Conditions of Use Privacy Policy

FOR INTERNAL USE ONLY

Address: 1289 Sebastopol Rd

P.C.# HRD 06-0269

Inspector: KR

Date: 9/6/06

The proposed construction appears to be located in:

Flood Hazard:	<input type="checkbox"/> FIRM Flood Zone (ASFH) BFE = _____ ft. NGVD. Lowest finish floor at 12 above BFE = _____ ft. NGVD.	<input type="checkbox"/> Portions of property in flood zone but project site not in flood zone.
	<input type="checkbox"/> Design for moving water is recommended Section _____ is _____ Ft/sec Section _____ is _____ Ft/sec	<input type="checkbox"/> Building is in FIRM Floodway <input type="checkbox"/> Main building on site is Post-FIRM <input type="checkbox"/> Sensitive drainage area, review by drainage section recommended.
	<input type="checkbox"/> Area subject to flooding (not on adopted FIRM). <input type="checkbox"/> Project is on flood zone major damage list.	<input type="checkbox"/> Appears to be a "substantial improvement" (40%), therefore flood regulations apply. <input type="checkbox"/> Located inside the <i>Laguna de Santa Rosa</i> below elevation of 75 ft (Ord.#4906).
	<input checked="" type="checkbox"/> Flood Prone Urban Area defined by Ordinance #4906.	
Geo-technical:	<input type="checkbox"/> Area of suspected slides, slumps, earth flow, or soil creep. (a.) <input type="checkbox"/> Area of previous fill placement. (g.) <input type="checkbox"/> Area of suspected expansive soil. (c.) <input type="checkbox"/> Area without sufficient slope setback as set forth in UBC Section 1806. (b.) <input type="checkbox"/> Area subject to possible liquefaction. (e.) <input type="checkbox"/> Area of suspected soft, compressible, or organic soil with low bearing capacity.	<input type="checkbox"/> Area without recommended setback from stream (Drainage Division recommendations). <input type="checkbox"/> Area of high moisture content in soil. (f.) <input type="checkbox"/> Area subject to high erosion (water or wind). <input type="checkbox"/> Area of soft soil due to past deep ripping or cultivation below minimum foundation depth. (h.) <input type="checkbox"/> Area within 1000 feet of a solid waste disposal site.
	Soils Investigation: Required <input type="checkbox"/> Included <input type="checkbox"/> Available <input type="checkbox"/>	
Geologic:	<input type="checkbox"/> Located in the Alquist-Priolo Special Studies Zone.	<input type="checkbox"/> Geologic report required (see CGS Publication 42).
General:	<input type="checkbox"/> Building addition will affect the required light and ventilation in an existing room. <input type="checkbox"/> Existing electric meter must be replaced. <input type="checkbox"/> Existing gas meter must be replaced.	<input type="checkbox"/> Indications of existing substandard conditions that are not addressed by the proposed construction. <input type="checkbox"/> Indications of past work done without a permit. <input type="checkbox"/> Grading permit required for road, driveway, or site preparation.
	Slope is <u>FLAT</u>	<input type="checkbox"/> Site is likely to be acceptable for conventional construction methods.
Wind:	Exposure "B" Exposure "C" Exposure "D"	N.S.C. Air Pollution Control District <input type="checkbox"/> Yes <input type="checkbox"/> No

- ① (E) parking lot area where trenching to take place.
- ② plans don't seem to indicate width of trenches etc.
- ③ ~~propose~~ ~~to~~ ~~the~~ FUEL station tank already removed & stuck trailer in place.
- ④ No other issues, plans seem incomplete.
- ⑤ Where are spots from excavation going? How much material?

RETURN



Since 1987

TRANS TECH CONSULTANTS

*Environmental Compliance Services
Engineers • Geologists • Architects
License # 697833 (A-Haz)*

July 20, 2006
Job No. 1279.01

*True Copy
6/20/06 - 0259 (PLANS INSIDE)*

Bob Haye, Branch Manager
Slakey Bros. - Santa Rosa Branch
2845 Duke Court
Santa Rosa, CA 95407

**Subject: Remedial Action Plan
Slakey Bros., Inc., 1289 Sebastopol Road, Santa Rosa, California
Case No. ITSO030**

Dear Mr. Haye:

This presents Trans Tech Consultants Remedial Action Plan for the subject site. The subject site is approximately located as shown on the Site Location Map, Plate 1. The purpose of this report is to outline the procedures for implementing the approved air sparge / vapor extraction (AS/VE) remedial system at the subject site. The AS/SVE system was proposed in our February 3, 2006 Feasibility Study / Corrective Action Plan (FS/CAP) and approved in a July 5, 2006 letter from Colleen Hunt of the North Coast Regional Water Quality Control Board (NCRWQCB).

Scope-of-Work

Remedial System Installation

As proposed in our FS/CAP, we plan to install an AS/VE system to remediate impacted groundwater at the site. It is proposed to excavate an approximately 12-inch wide trench in a roughly rectangular shaped pattern within the groundwater contaminant plume, as indicated on Plate 2. The trench is configured to surround the most heavily contaminated portion of the plume in order to apply air sparging and vapor extraction forces on all sides.

The detailed trench configuration will be determined based on a thorough underground utility search. Besides consulting with the City of Santa Rosa Public Works Department and applicable private utility companies, an underground utility location firm will be engaged to perform a comprehensive underground utility search.

Since virtually no amount of underground utility location effort can guarantee the absence of underground obstructions, precautions will be taken to avoid damage to utility lines. Hand digging will be practiced around any known underground utilities. A contingency plan for emergency response to damaged utilities will developed. Excavation will only take place Monday thru Thursday

from 7:00 AM to 2:30 PM so that there will be time to repair any damaged utilities before dark. Also, all excavation activities will be coordinated with Underground Service Alert and the Santa Rosa Public Works Department.

The injection lines will be constructed of 1^{1/4}-inch diameter PVC installed horizontally at a depth of approximately 15 feet below grade. Historically, groundwater levels have fluctuated between 3.76 and 17.50 feet below grade (BG). Therefore, we anticipate that the injection lines will be submerged in groundwater for most of the year. The injection lines will be installed on a bed of gravel and will be covered by 3/8-inch washed pea gravel. The pea gravel will extend from the top of the injection lines at approximately 15 feet BG, to approximately 3.5 feet BG. We will manifold the injection lines in a manner that will allow for air to pressurize equally. Further, we will perforate the injection lines with small holes near the sources of air injection with increasingly larger holes placed further from the air injection points. We have found that this technique allows for equal air distribution throughout the line.

The vapor extraction line will be constructed of 2-inch galvanized steel and will also be installed horizontally within the pea gravel bed at a depth of approximately 4.5 feet BG. Approximately two feet of pea gravel will be placed above the extraction lines, and geotextile fabric will be placed above that. The remaining space will be filled with Class II material and compacted to at least 90% before being re-surfaced with asphalt. The combination of compacted base material and impervious pavement will provide an effective seal and prevent vacuum short circuiting to the ground surface. The extraction line will be perforated in approximate three foot sections which will be staggered approximately 5 and 10 feet apart. In addition, we will manifold the extraction line to allow the vacuum to be applied at multiple locations. These techniques will allow for adequate vacuum to be applied to the entire line.

In addition to the horizontal injection and extraction lines we will install four observation points within the trench. The observation points will consist of 2-inch diameter perforated PVC pipe installed vertically within the trench. The observation points will extend from the bottom of the trench to approximately 6-inches below the surface. A traffic rated Christy box will be installed at the surface to protect the observation point. The perforations on the pipe will extend from the bottom of the trench to approximately 3.5 feet BG. The observation point will provide a means to measure water level depths within the trench as well as to collect remedial system data.

Due to the scope of the proposed AS/VE trench, we will be required to obtain a grading permit from the City of Santa Rosa. Therefore our trench excavation, backfill, and compaction will be performed in accordance with the grading permit requirements. Once the system installation backfill, compaction and resurfacing are completed, we will proceed with the AS/VE system testing.



Remedial System Testing

An oil free air compressor will be installed onto the injection line. The equipment used will have an operational range for testing and monitoring which we will use to determine the optimum flow rate. It is anticipated that 2-5 standard cubic feet per minute (scfm) per foot of trench will be required for optimum system performance. Soil vapor will be extracted from the trench with an electrically driven rotary vane blower. Powered by a 5 HP motor, the blower will be capable of extracting 150 SCFM of vapor from the trench. The vacuum blower will be mobilized to the site and installed onto the vapor extraction line. A relatively low flow vacuum will be applied so that vapors are recovered but groundwater is not. It is anticipated that less than 5 inches of mercury will be required to achieve the objective. Once we have established the optimum performance range for both the injection and extraction lines, we will proceed with the system operation. We will install a vapor sample port before vapor treatment and after treatment. These sample ports will allow us to quantify the hydrocarbon masses removed as well as verify the effectiveness of the vapor treatment. The surface mounted air compressor and vacuum blower will be secured within an onsite equipment compound.

Remedial System Operation, Monitoring and Reporting

Upon remedial system startup, we will collect a vapor sample from which we will perform an initial estimation on contaminant mass removal rates. Subsequent vapor sampling will occur weekly for the first two months to determine the consistency of contaminant recovery and to generate data from which contaminant recovery trends can be extrapolated. The vapor samples collected from the system will be analyzed for total petroleum hydrocarbons (TPH) as gasoline (g), benzene (B), toluene (T), ethylbenzene (E), and total xylenes (X), as well as methyl tert butyl ether (MtBE). The samples will be collected in tedlar bags and transported to a State approved laboratory within 48 hours for the chemical analysis specified.

In addition, upon system startup we will collect data from the observation points. Dissolved oxygen and carbon dioxide readings will be collected. In addition, groundwater samples will be collected from the observation points and analyzed for the petroleum hydrocarbon constituents of concern. From the data collected we will evaluate the effectiveness of the remedial system and determine if an increase in microbial activities is occurring. After two months of system operation and monitoring, we will prepare a remediation update report. The remedial update report will document the system installation and present the laboratory analytical data from the vapor sampling. The report will also present recommendations relative to continuing remedial system operation, or making remedial system modifications. In addition, our report will include calculations totaling the contaminant mass removed as well as calculations relative to the contaminant mass removal rates.



We appreciate the opportunity to be of service to you and trust that this provides the information you require at this time. If you have any questions or require any additional information, please feel free to contact us at (707) 575-8622 or www.transtechconsultants.com.

Sincerely,
TRANS TECH CONSULTANTS

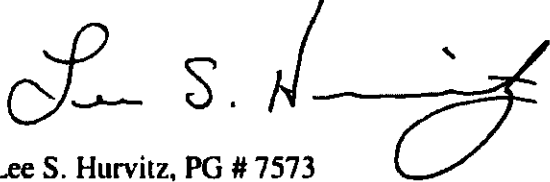

Lee S. Hurvitz, PG # 7573
Professional Geologist

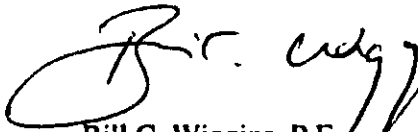
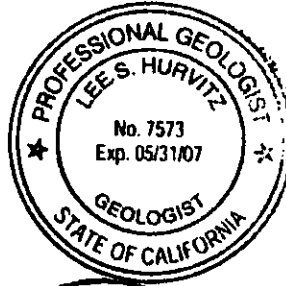

Bill C. Wiggins, P.E.
Registered Civil Engineer

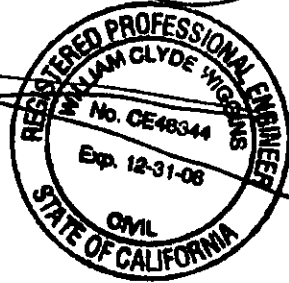

Attachments	Plate 1,	Site Location Map
	Plate 2,	Site Plan
	Plate 3,	Air Sparge / Soil Vapor Extraction System Installation
		Distribution List



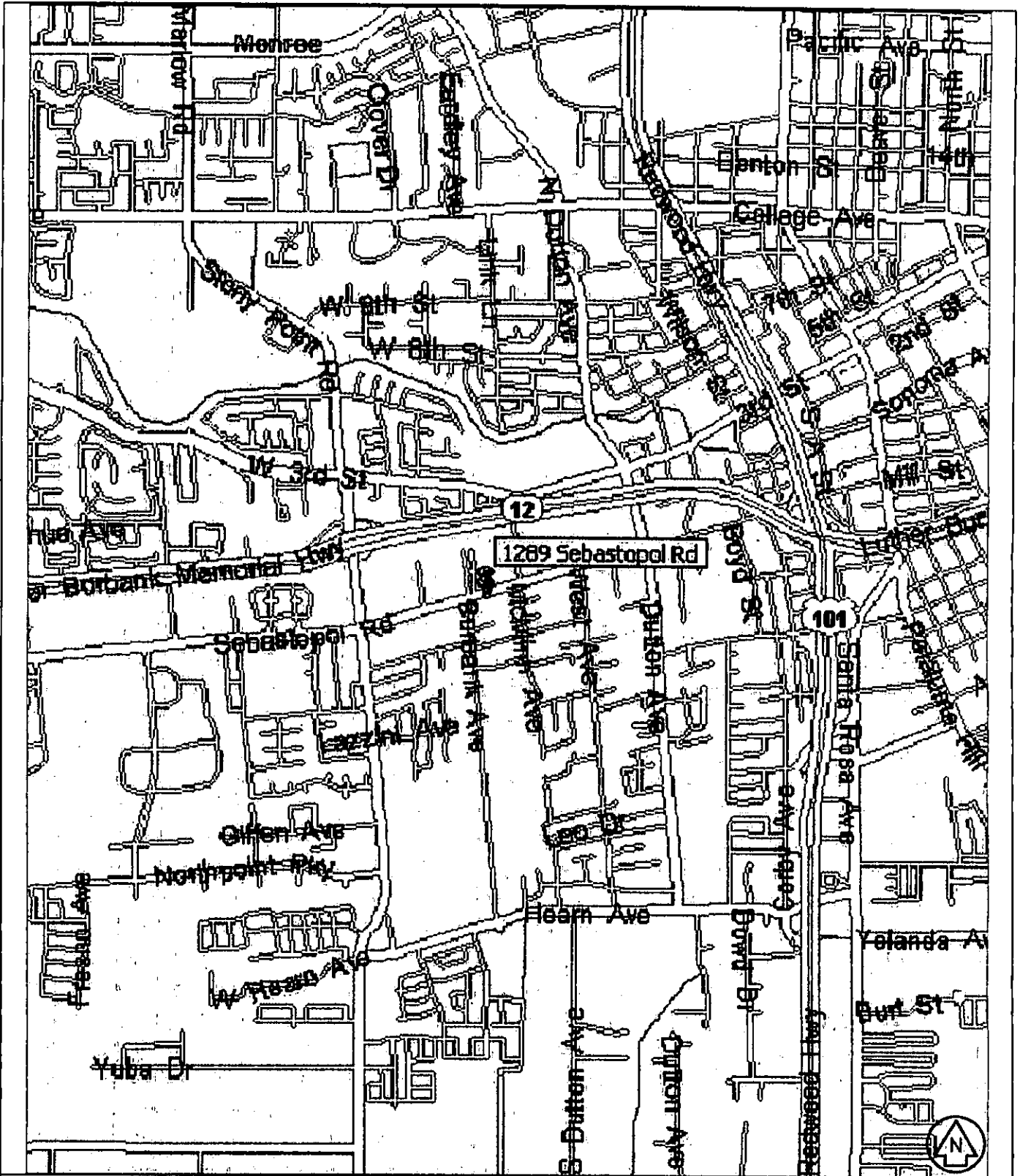

TRANS TECH CONSULTANTS

930 SHILOH RD., BLDG 44, SUITE J
 WINDSOR, CA 95492
 PHONE: 707-575-8822 FAX: 707-837-7334

SITE LOCATION MAP

SLAKEY BROTHERS, INC.
 1289 SEBASTOPOL ROAD
 SANTA ROSA, CA

PLATE:

1

DRAWN BY: PSC	DWG NAME: 1279.01 SLM	APPR. BY: BRH	JOB NUMBER: 1279.01	W.O. NUMBER: A-385	REVISIONS:	DATE: 2/11/04
------------------	--------------------------	------------------	------------------------	-----------------------	------------	------------------

ZONING APPROVAL

WORK INDICATED ON THESE DRAWINGS IS APPROVED ON THE BASIS THAT ALL WORK WILL COMPLY WITH ALL REQUIREMENTS OF THE COUNTY OF SANTA ROSA, WHETHER SHOWN ON THESE DRAWINGS OR NOT.

8/28/06

PROPERTY LINE

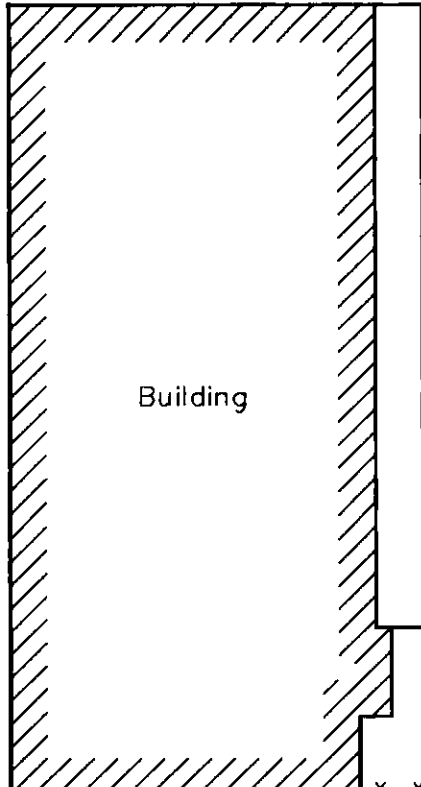

PERMIT AND RESOURCE MANAGEMENT DEPARTMENT

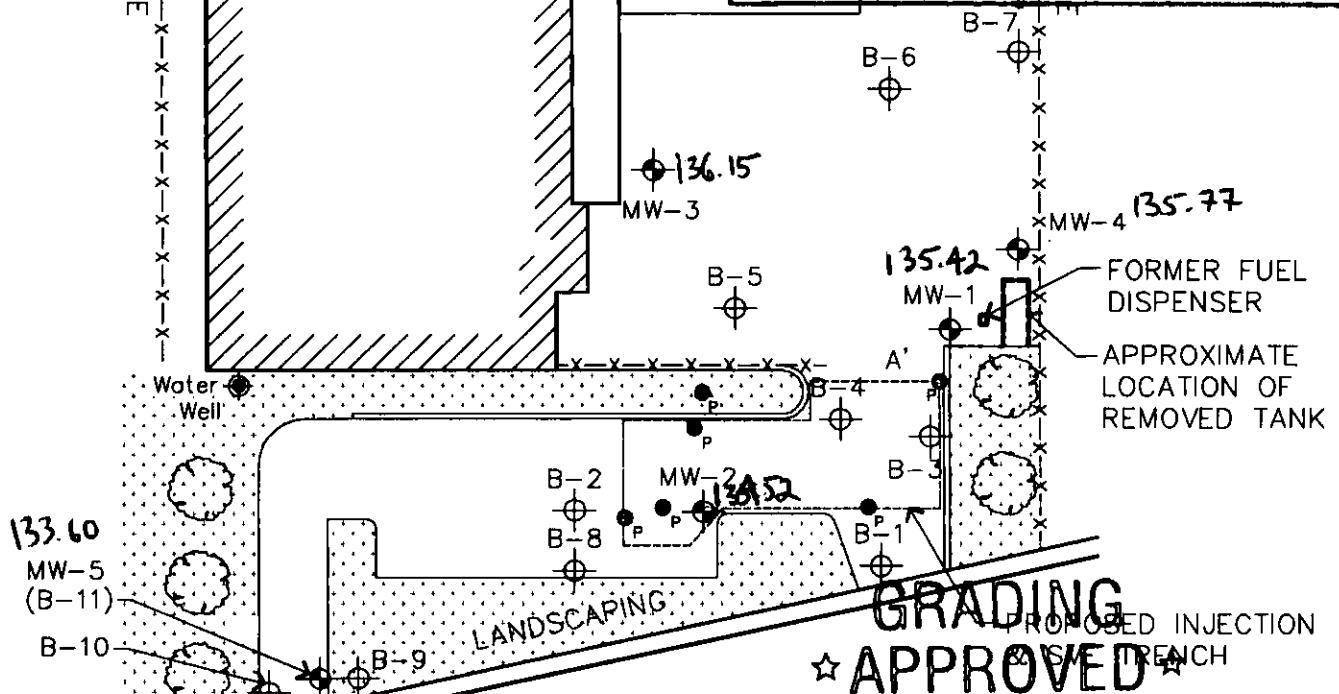

★ APPROVED ★

GRADING PROPOSED INJECTION TRENCH
★ APPROVED ★

DLL 9-11-06

Sebastopol Road *DLL 9-11-06*

BY DRAINAGE REVIEW SECTION
PERMIT AND RESOURCE
MANAGEMENT DEPARTMENT

PERMIT AND RESOURCE
MANAGEMENT DEPARTMENT

- P OBSERVATION POINTS
- ⊕ MONITORING WELL LOCATION
- ⊕ SOIL BORING LOCATION

- as noted
- subject to attached conditions
- subject to soil report recommendations
- requires inspection by Soil Engineer

**elevations represented relative to msl*

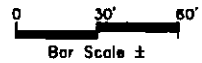

T TRANS TECH CONSULTANTS
930 SHILOH RD., BLDG 44, SUITE J
WINDSOR, CA 95492
PHONE: 707-575-8622 FAX: 707-837-7334

SITE PLAN WITH PROPOSED REMEDIATION TRENCH & TRENCH PROFILE LINE A-A'
SLAKEY BROTHERS, INC.
1289 SEBASTOPOL ROAD
SANTA ROSA, CA

PLATE:
2

DRAWN BY: PSC	DWG NAME: 1279.01 SP	APPR. BY: LSH	JOB NUMBER: 1279.01	W.O. NUMBER: A-970	REVISIONS:	DATE: 8/25/06
------------------	-------------------------	------------------	------------------------	-----------------------	------------	------------------

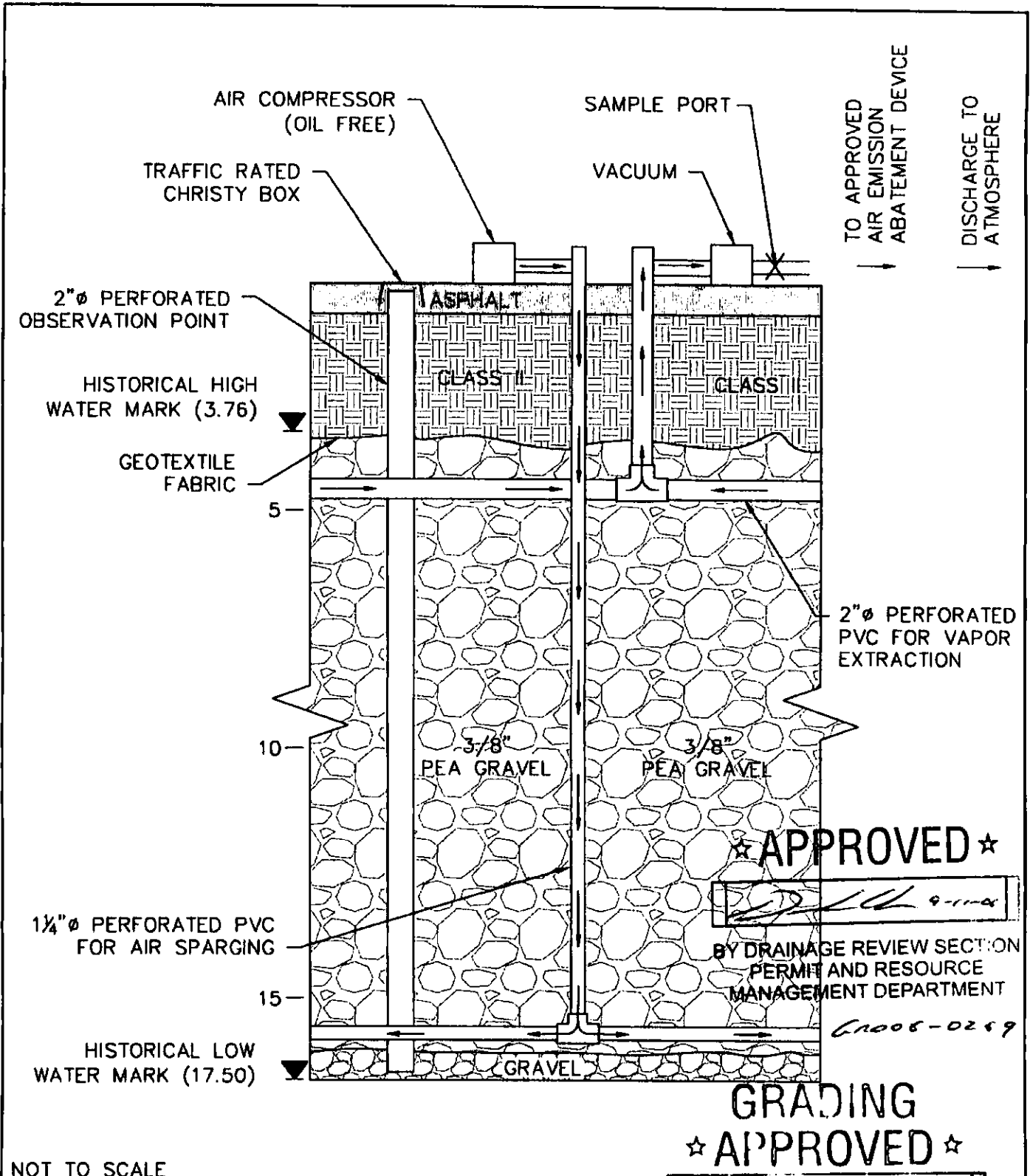

NOT TO SCALE

★ APPROVED ★
 BY DRAINAGE REVIEW SECTION
 PERMIT AND RESOURCE
 MANAGEMENT DEPARTMENT
 62008-0289
 ★ GRADING APPROVED ★

TRANS TECH CONSULTANTS
 930 SHILOH RD., BLDG 44, SUITE J
 WINDSOR, CA 95492
 PHONE: 707-575-8822 FAX: 707-837-7334

PROFILE OF PROPOSED AIRSPARGING/VAPOR EXTRACTION TRENCH
 SLAKEY BROTHERS PERMIT AND RESOURCE
 1289 SEBASTOPOL ROAD MANAGEMENT DEPARTMENT
 SEBASTOPOL, CALIFORNIA 95472

DRAWN BY: JLP	DWG NAME: 1279.01 EXTRACTION	APPR. BY: LSH	JOB NUMBER: 1279.01	W.O. NUMBER: A-970	REVISIONS: <input type="checkbox"/> subject to attached conditions <input type="checkbox"/> subject to soil report recommendations <input type="checkbox"/> requires inspection by Soil Engineer	3
------------------	---------------------------------	------------------	------------------------	-----------------------	---	---

DISTRIBUTION LIST

**Remedial Action Plan
Slakey Brothers Inc.
1289 Sebastopol Road
Santa Rosa, California
July 20, 2006
Job No. 1279.01**

**Mrs. Colleen Hunt
North Coast Regional Water
Quality Control Board
5550 Skylane Boulevard, Suite A
Santa Rosa, California 95403**





Since 1987

TRANS TECH CONSULTANTS

Environmental Compliance Services
Engineers • Geologists • Architects
License # 697833 (A-Haz)

September 18, 2006
Job No. 1279.01

Derek Chow
County of Sonoma - Permit and Resource Management Department
2550 Ventura Avenue
Santa Rosa, California 94903-2829

Subject: Grading Permit Review
1289 Sebastopol Road, Santa Rosa, California
Project # GRD06-0269

Dear Mr. Chow:

This letter addresses the comments outlined in a September 11, 2006 letter from the County of Sonoma - Permit and Resource Management Department.

Copies of the standard "Erosion and Sediment Control Notes" and Grading Notes" have been attached to the *Remedial Action Plan* report as requested.

The approximate dimensions of the proposed excavation trench are shown on the Site Plan/Remediation Equipment Detail, Plate 2 in red. In general, the trench will be approximately 40 feet by 100 feet, and 1 foot wide. The trench is expected to extend to approximately 15 feet below ground surface.

Excavated soil generated will be placed on and covered by 6 mil plastic sheets and stored temporarily onsite, pending disposal at the approximate location shown on Plate 2.

We appreciate the opportunity to be of service to you and trust that this provides the information you require at this time. If you have any questions or require any additional information, please call us at 575-8622 or at www.transtechconsultants.com.

Sincerely,
Trans Tech Consultants

Brian R. Hasik
Staff Geologist

Bill C. Wiggins, PE
Registered Civil Engineer

