

W

Type

5

Docs

0

Plans

WEL00 - 0357

Building Permit Number (List all associated with these documents)

4061

Street Number

Madera Ave

Street Name

ROS

Community Code

035 - 181 - 031

APN

COUNTY OF SONOMA

PERMIT AND RESOURCE MANAGEMENT DEPARTMENT

2550 Ventura Avenue, Santa Rosa, CA

(707) 565-1900 FAX (707) 565-1103

APPLICATION RECEIPT

WEL00-0357

Date: Jun 30, 2000
Time: 09:31

Site Location Information:

Address: 4061 MADERA AVE ROS
Cross Street:

Area #: 00
APN: 035-181-031

<p style="text-align: center;">Owner</p> <p>SUNDT HEDI 60 PALIMINO CIR NOVATO CA 94947</p>	<p style="text-align: center;">Applicant</p> <p>WEEKS DRILLING & PUMP CO INC PO BOX 176 SEBASTOPOL CA 95473 (707) 542-3272</p>
<p style="text-align: center;">Contractor</p> <p>WEEKS DRILLING & PUMP CO INC PO BOX 176 SEBASTOPOL CA 95473 (707) 542-3272 Lic. #: 177681</p>	<p style="text-align: center;">Engineer</p>

Date: 06/30/00
Expires:
Printed By: BKEARNS

Description of Work: NEW WELL (out of water)

Item #	Item Account Code	Description	Fee	Prev. Paid
0391	1343 0425	CLASS I WATER WELL	\$327.00	\$.00
0392	1343 0426	CLASS II WATER WELL	\$.00	\$.00
0393	1343 0427	WAIVER (WATER WELL)	\$.00	\$.00
0394	1343 0428	WATER WELL DESTRUCTION	\$.00	\$.00
0395	1343 0429	WELL PERMIT HOURLY RATE	\$.00	\$.00
0396	1343	WELL YIELD REPORT	\$.00	\$.00
0397	1343	GEOTECHNICAL BORINGS	\$.00	\$.00
			\$327.00	\$.00

Total Calculated Fees	\$327.00
Previously Paid	\$.00
Balance Due	\$327.00

CASH REGISTER
VALIDATION
REQUIRED

019437 06/30/00E01
0000357
SIERRA \$327.00
***TTL \$327.00
CHECK \$327.00
CHNG \$0.00

COUNTY OF SONOMA
 PERMIT & RESOURCE MANAGEMENT DEPARTMENT
 WELL & SEPTIC SECTION
 2550 VENTURA AVENUE
 SANTA ROSA, 95403
 (707) 565-1900

APPLICATION FOR PERMIT
 WATER WELL

Out of Water

WELL ADDRESS 4061 Madero Ave
 CITY Santa Rosa, CA ZIP 95407
 PROPERTY OWNER Hedi Sundt
 ADDRESS 60 Palomino Cr. Novato
 DRILLING CONTRACTOR WEEKS DRILLING & PUMP CO.
 ADDRESS PO Box 176, Sebastopol, CA 95473

APPLICATION No. We 00-0357
 ASSESSOR'S PARCEL No. 035-181-031
 PHONE No. 542-2107
 CONTRACTOR LICENSE No. C57-177681
 PHONE No. (707) 442-3272

TYPE OF WORK: Class I Permit Class II Permit New Well Reconstruct Observation Test well, Test hole Destruct Other: 019437 05/30/0080:

PROPOSED USE: Domestic, Single Family Domestic, Public Irrigation Industrial Other: SIERRA

CONSTRUCTION PROPOSED:
 Casing: Diameter: 5" Gauge: SDR21 Material: PVC Conductor: No Single Double
 Annular Space: Size: 2 Depth of Seal: 50 Concrete: / Grout: / Heat Cement: Puddled Clay: CHINA

Method of Disinfection: HTH Method of Sealing Access Opening: WELL CAP Type of Joint: Glue

0000357
\$327.00
\$327.00
\$327.00
\$0.00

Well located within an existing public water system boundary: Yes No Name: _____

I hereby agree to comply with all laws and regulations of the County of Sonoma and State of California pertaining to water well construction. I will telephone (707) 565-1694 to notify the Environmental Health Specialist when I am commencing this work. I will furnish the Permit and Resource Management Department and the owner a copy of the State Water Well Driller's Report within 60 days in order to obtain final approval on this well. I acknowledge that the application will become a permit only after site approval and payment of fee. I understand that this permit is not transferrable and expires one year from date of issuance.

CONSTRUCTION PROPOSED:
 A currently effective certificate of Worker's Compensation Insurance is on file with the Sonoma County PRMD.
 I certify that in the performance of the work, for which this permit is issued I shall not employ any person in any manner so as to become subject to the Worker's Compensation laws of California.
 Insurance Carrier State Fund Policy # WC641-817-99
 Signature of Applicant Donald Kamm Date 6-30-00

Signature of Well Driller Donald Kamm Date 6-30-00

FOR OFFICE USE ONLY - ENVIRONMENTAL HEALTH SERVICE

Site approved by: Lucretia R Baert Date: 7-7-00 Water Scarce Area: Yes No
FINAL BASED ON WELL REPORT
 Sealed to depth of _____
 Finaled by: _____ Date: _____ Seal Observed: Yes No

Indicate below the exact location of well with respect to the following items: property lines, water bodies or water courses, drainage pattern, roads, existing wells, sewer main and laterals and private sewage disposal systems or other sources of contamination or pollution. INCLUDE DIMENSIONS. The validity of this permit depends upon the accuracy of the information provided by the applicant.

7-7 OLD WELL TO BE DESTROYED UNDER THIS PERMIT
 REMOVE PUMP & BACKFILL W/CEMENT

See Attached



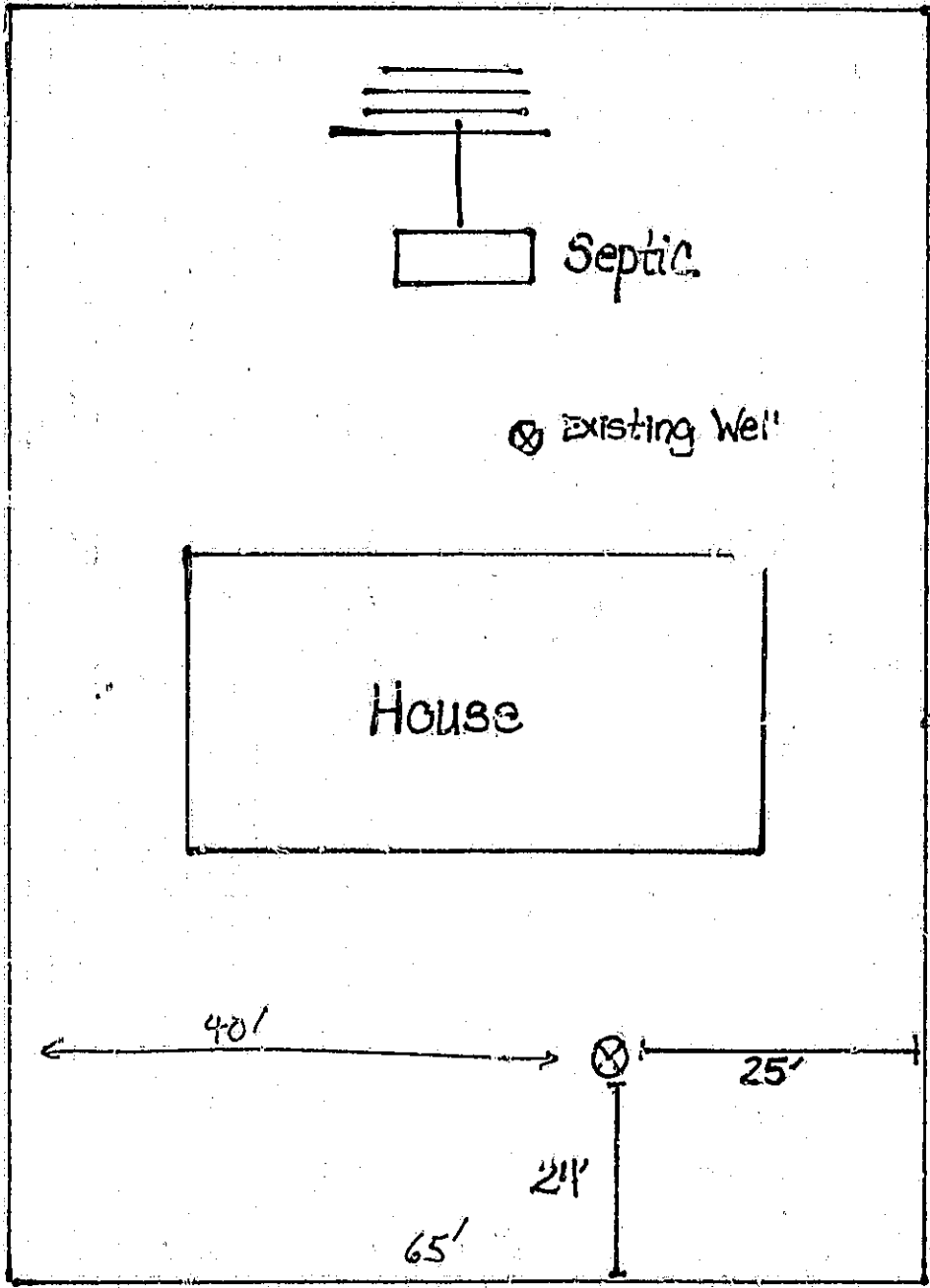

Madera

AP# 035-181-031

Project: Sundt, Hedi	Date:
WEEKS DRILLING & PUMP CO. Sebastopol, Calif.	Project Notes

1-800-345-7334

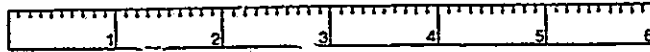

SCALE IN 1/10 OF AN INCH

4063 Madera

4065 Madera
4061 Madera

COUNTY ASSESSOR'S PARCEL MAP

TAX RATE AREA
4-036

35-18

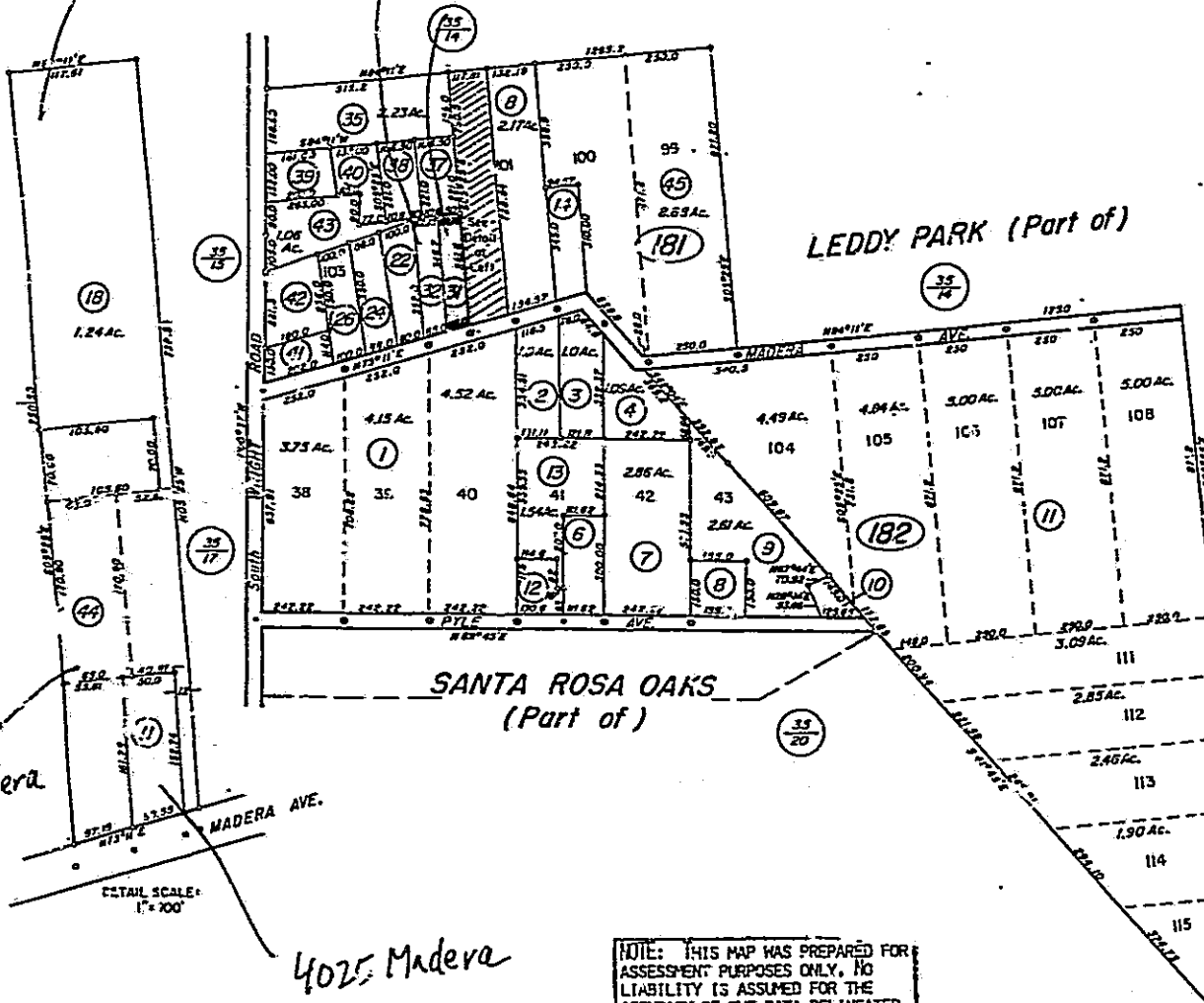

4047 Madera

4025 Madera

ESTABL SCALE:
1" = 100'

NOTE: THIS MAP WAS PREPARED FOR ASSESSMENT PURPOSES ONLY. NO LIABILITY IS ASSUMED FOR THE ACCURACY OF THE DATA DELINEATED HEREON.



REVISED
12-5-97+45 (181) LSL

Assessor's Map Bk. 35 Pg. 18
County of Sonoma, Calif.

QUADRUPPLICATE
For Local Requirements

STATE OF CALIFORNIA
WELL COMPLETION REPORT

Refer to Instruction Pamphlet

Page of

Owner's Well No.

No. **700448**

Date Work Began 7/20/2000, Ended 7/20/2000

Local Permit Agency SONOMA CO. PERMIT AND RESOURCE MGT.

Permit No. WEL00-0357 Permit Date 7/7/2000

DWR USE ONLY — DO NOT FILL IN

STATE WELL NO./STATION NO.

LATITUDE LONGITUDE

APN/TRSIO/HER

ORIENTATION (°)		DRILLING METHOD	DESCRIPTION
VERTICAL — HORIZONTAL — ANGLE — (SPECIFY)		<u>MUD ROTARY</u>	<u>Bentonite</u>
DEPTH FROM SURFACE		Describe material, grain size, color, etc.	
Fl.	to Fl.		
0	15		Dark brown sandy clay with gravel
15	30		Lighter brown clay which turns into blue clay
30	45		Tighter blue clay with some softer sandier gravel zones
45	60		Blue green clay turns into gravel (clean rounded multi-colored)
60	75		Tighter brownish gray clay with some wood pieces. Turns back into gravel with some volcanic rock.
75	90		Brown gray sandy clay with zones of rounded sands and gravel
90	105		Turns into tighter brown clay with some sand and gravel lenses

WELL OWNER

Name SUNDT, Kedi
Mailing Address 2621 Calle Del Oro
City LaJolla, CA 92037 STATE ZIP

WELL LOCATION

Address 4061 Madera Avenue
City Santa Rosa, CA
County Sonoma
APN Book 035 Page 181 Parcel 031
Township Range Section
Latitude NORTH Longitude WEST

LOCATION SKETCH — NORTH

ACTIVITY (±)

NEW WELL

MODIFICATION/REPAIR

Deepen

Other (Specify)

DESTROY (Describe Procedure and Materials Under "GEOLOGIC LOG")

PLANNED USES (±)

WATER SUPPLY

Domestic Public

Irrigation Industrial

MONITORING

TEST WELL

CATHODIC PROTECTION

HEAT EXCHANGE

DIRECT PUSH

INJECTION

VAPOR EXTRACTION

SPARGING

REMEDICATION

OTHER (SPECIFY)

CONFIDENTIAL

RECEIVED

AUG 07 2000

PERMIT AND RESOURCE MANAGEMENT DEPARTMENT
COUNTY OF SONOMA

WATER LEVEL & YIELD OF COMPLETED WELL

DEPTH TO FIRST WATER (FL) BELOW SURFACE

DEPTH OF STATIC WATER LEVEL 10 (FL) & DATE MEASURED 7/20/2000

ESTIMATED YIELD 45 (GPM) & TEST TYPE A lifted

TEST LENGTH 2 (Hrs) TOTAL DRAWDOWN Bottom (FL)

* May not be representative of a well's long-term yield.

DEPTH FROM SURFACE	BORE-HOLE DIA. (Inches)	CASING (S)							
		TYPE (±)				MATERIAL / GRADE	INTERNAL DIAMETER (Inches)	GAUGE OR WALL THICKNESS	SLOT SIZE IF ANY (Inches)
Fl.	to Fl.	BLANK	SCREEN	CONDUCTOR	FILL PIPE				
0	105								
11	105		X			PVC	5	CL200	
60	100		X					.032	

DEPTH FROM SURFACE	ANNULAR MATERIAL TYPE			
	CEMENT (±)	BENTONITE (±)	FILL (±)	FILTER PACK (TYPE/SIZE)
Fl.	to Fl.			
0	50		X	
50	105			X 12x20 SAND

ATTACHMENTS (±)

Geologic Log

Well Construction Diagram

Geophysical Log(s)

Soil/Water Chemical Analyses

Other

ATTACH ADDITIONAL INFORMATION, IF IT EXISTS.

CERTIFICATION STATEMENT

I, the undersigned, certify that this report is complete and accurate to the best of my knowledge and belief.

NAME WEEKS DRILLING AND PUMP COMPANY by Chris Thompson
(PERSON, FIRM, OR CORPORATION) (TYPED OR PRINTED)

P.O. Box 176 Sebastopol, CA 95473

ADDRESS CITY STATE ZIP

Signed DATE SIGNED 7/31/2000 177681
WELL DRILLER/AUTHORIZED REPRESENTATIVE C-57 LICENSE NUMBER