

16

3575 SLUSSER RD
2PE02-0127



COUNTY OF SONOMA
PERMIT AND RESOURCE MANAGEMENT DEPARTMENT

2550 Ventura Avenue, Santa Rosa, CA 95403
(707) 565-1900 FAX (707) 565-1103

Application Fees / Invoice for: ZPE02-0127

Project Address: 3575 SLUSSER RD SRO
Cross Street: LAUGHLIN ROAD

APN: 067-070-041

Status: APPROVED
Printed: July 31, 2003
Initialized by: DPARSONS
Activity Type: B-ZPE 101

Description: REQUEST FOR A ZONING PERMIT FOR TWO CULTURAL

Owner: RICHARD'S GROVE AND SARALEE'S VINEYARD
3575 SLUSSER RD
WINDSOR CA
95492
707 546 3276

Applicant: SONOMA COUNTY WINERIES ASSN
ATTN MICHAEL MONAHAN
5000 ROBERTS LAKE RD
ROHNERT PARK CA 94928
707 586 3795

Fees:

Item#	Description	Account Code	Tot Fee	Prev. Pmts	Cur. Pmts
334	EH REVIEW PUB SEW & WAT	025015-3355	86.00	86.00	.00
1160	ZONING PERMITS W/POSTING	025015-3830	544.00	544.00	.00
			\$630.00	\$630.00	

Total Fees: \$630.00

Total Paid: \$630.00

Balance Due: \$0.00

When validated below, this is your receipt.

Zoning Permit Application

PJR-004

File#: 2PE02-0127

- Ag. Employee Dwelling Unit
- Biotic Resource
- Confined Livestock
- Daycare-Large Family
- Hobby Kennel
- Home Occupation
- Horse Boarding

- Landmarks Commission
- Minor Timberland Conversion
- Mobile Home
- Non-conforming Uses
- Setback Averaging/Reduction
- Special Events
- Other _____

Applicant (Contact Person):

Name: Sonoma County Wineries Assoc
Mailing Address: 5000 Roberts Lake Rd
Kohler Park, CA 94928
City/Town: _____ State/Zip: 94928
Phone: 586-3795 Fax: 586-1383
Signature: _____ Date: 1-22-02

Owner, if other than Applicant:

Name: Richard G. Gross
Mailing Address: 3575 Slusser Rd
Windsor, CA 95492
City/Town: _____ State/Zip: 95492
Phone: 546-3276 Fax: 546-3277
Signature: _____ Date: 1-29-02

Other Persons to be Notified: (Specify: Agent, Lender, Architect or Engineer)

Name	Name	Name
_____	_____	_____
Mailing Address	Mailing Address	Mailing Address
_____	_____	_____
City/Town State/Zip	City/Town State/Zip	City/Town State/Zip
_____	_____	_____
Title	Title	Title
_____	_____	_____
Phone Fax	Phone Fax	Phone Fax
_____	_____	_____

Project Information:

Address(es): 3575 Slusser Rd City/Town: Windsor, CA 95492
Assessor's Parcel Number(s): 057-070-041 Acreage: 5
Project Description: Wine Food Tasting - silent Auction

Site Served by Public Water? yes no
Site Served by Public Sewer? yes no
I/we agree to comply with the attached performance standards/conditions.

Signature of Applicant: _____ Date: 1-22-02

DO NOT WRITE BELOW THIS LINE - To Be Completed by PRMD Staff

Zoning permit approved by: Shelley Cabanilla Date: 7-8-2002
Signature of Planner
Planning Area: 5 Supervisorial District: 4 Current Zoning: DA B6-60, 2, Fa General Plan Land Use: DA 60
Specific Plan: _____ S.P. Land Use: _____ Needs CEQA Review? yes no
Violation? yes no; Application resolve planning violation? yes no; Penalty applicable? yes no; Civil Penalty Factor: N/A
Previous Files: 2PE 99-0518 & others
Application accepted by: D.P. [Signature] Date: 6-18-02

SPECIAL EVENT/CULTURAL EVENT - PERMIT APPLICATION

FILE NO. 2PE 02-0127

I/We Sonoma County Wineries Ass [Applicant(s)] propose to hold a special event located at 3 LOCATIONS. The event is to be held 7-12-02 through 7-12-02 (dates), during hours of NOON to 11:00pm.

The event will include the following activities: Dinner DANCING Auction and WINE TASTING. I/We expect attendance to be 1200-1500. I/We understand that signatures from the following Departments/agencies must be obtained prior to issuance of this zoning permit by the Permit and Resource Management Department.

If the application is approved, the Permit and Resource Management Department will issue a zoning permit specifying any conditions which will be imposed upon the application approval. You must comply with these conditions in connection with the special event you are conducting.

Environmental Health/Consumer Protection Condition(s): events of 1 day are exempt from health permit requirement. Follow safe food handling practices.
1030 Center Dr., Suite A
Santa Rosa, CA 95403
(707) 565-6565
Signature: [Signature] Date: 4/30/02

Well & Septic Division Condition(s): SEE ATTACHED
2550 Ventura Avenue
Santa Rosa, CA 95403
(707) 565-1900
Signature: _____ Date: _____

Fire Services/Local Fire District Condition(s): Comply w/ all fire code regulations. Fire inspections will be conducted. Call 565-1154 for inspection.
2300 County Center Dr., Ste. 221A
Santa Rosa, CA 95403
(707) 565-1152
Signature: [Signature] Date: 6/14/02

Transp. & Public Works/Encroachments Condition(s): NO PARKING ALONG STREET CURB
2550 Ventura Avenue
Santa Rosa, CA 95403
(707) 565-3626 or 3645
Signature: [Signature] Date: 5/1/02

Sheriff Condition(s): TAKE ALL REASONABLE STEPS TO ENSURE PUBLIC SAFETY. COMPLY WITH ALL STATE AND LOCAL LAWS AND ORDINANCES.
600 Administration Dr., #103J
Santa Rosa, CA 95403
(707) 565-2511
Signature: [Signature] Date: 3/29/02

Building Inspection Condition(s): No permanent structures, electrical, plumbing, etc.
2550 Ventura Avenue
Santa Rosa, CA 95403
(707) 565-1900
Signature: [Signature] Date: 5/1/02

California Highway Patrol Condition(s): Provide ample parking on site. PARKING VIOLATIONS WILL BE ENFORCED. NOTIFY CHP OF ANY CHANGES.
1600 LaBain Avenue
Rohnert Park, CA 94928
(707) 588-1400
Signature: [Signature] Date: 5-1-02

SPECIAL EVENT/CULTURAL EVENT



COUNTY OF SONOMA
PERMIT AND RESOURCE MANAGEMENT DEPARTMENT

2550 Ventura Avenue, Santa Rosa, CA 95403-2829
(707) 565-1900 FAX (707) 565-1103

**CONDITIONS FOR PLANNING DEPARTMENT PERMIT APPLICATION
SPECIAL EVENTS**

Event: Sonoma Cutrer San Francisco Symphony & Fireworks Display

NAME OF ORGANIZATION: Sonoma County Wineries Association

LOCATION OF EVENT: 4401 Slusser Road, Windsor

DATE OF EVENT: July 13, 2002, 5:00 PM - 11:00 PM

1. Provide at least 1 portable toilet per 100 people. Portable toilets must be serviced by a licensed company. If no other facility for hand washing exists for the project, the portable toilets shall be equipped with hand washing sinks if food is sold or served at the event.

NOTE: ANY EXISTING SEPTIC SYSTEM CANNOT BE USED FOR THESE EVENTS UNLESS IT HAS BEEN THOROUGHLY REVIEWED BY THE WELL & SEPTIC DISTRICT SPECIALIST AND HAS THE CAPACITY TO ACCOMMODATE THE INCREASED LOADING FROM THE EVENTS AND THE EXISTING USES. UPGRADES TO THE EXISTING SEPTIC SYSTEM WILL LIKELY BE NECESSARY. PORTABLE TOILETS REQUIRED.

2. Provide an adequate number of solid waste receptacles and provide for daily litter pick-up. Containers shall be designed to prevent spillage and the entry of rodents, birds, cats or dogs.

3. Noise shall be controlled in accordance with the Table NE-2 of the Noise Element of the Sonoma County General Plan.

NOTE: ANY AMPLIFIED MUSIC OR LOUDSPEAKERS SHALL BE CONTROLLED SO THAT THE IMPACT TO SURROUNDING PROPERTIES WILL BE MINIMIZED. ORIENTATION OF SPEAKERS SHALL BE AWAY FROM ANY NEIGHBORING RESIDENCES. VOLUMES SHALL ALSO BE MONITORED TO MEET COUNTY STANDARDS AT ALL TIMES. ALL AMPLIFIED MUSIC SHALL CEASE AT 10:00 PM.

NEIGHBORS SURROUNDING THE EVENT SITE MUST BE NOTIFIED OF POTENTIAL NOISE FROM FIREWORKS. FIREWORKS SHALL BE LIMITED TO 35 MINUTES DURATION ONLY.

4. Other: (a) Pay Project Review-Health fee of \$86.00 at time of submittal to Planning.
(b) Comply with conditions of Environmental Health, Consumer Protection regarding food and beverage service. Catering services must be used.
(d) If any complaints are received regarding this event, the applicant may have to cease this activity based upon investigation by this department.



JONATHAN TRACY, R.E.H.S., M.S.
Senior Environmental Health Specialist, Project Review

4-3-02
DATE

agency Services - Fire Division

Page 4 of 26

Richard George ... byd

Following information shall be provided in order to process the tent/canopy permit:

Address of event: 3575 Sussie Rd Windsor 95492

Contact Person: ICEU CHAIR Phone No.: 251-2200

Home Address of Contact Person: 1952 Illinois St

Napa, CA 94559 5 Star production

Date of event: July 13 2002 Hours of Operations: 12-5pm

Date tent being erected: Jul 9 2002 Date Down: July 15 2002

Size of tent: SEE ATTACHED

Number of people anticipated: 1200

Type of event: WINE & FOOD TASTING

Entertainment - what type: STEEL DRUM MUSICIANS

Is admission being charged: YES

Liquor served (charging?): YES, WINE - INCLD. IN TICKET PRICE

Cooking (how prepared): YES BBQ

Will there be dancing? NO

If so, records, tapes or band? N/A

Source of power: GENERATOR

Source of heat: N/A

Ground cover: GRASS

A plot plan indicating the tent and/or canopy dimensions, and distances from other tents and/or ca buildings, vehicle parking areas and roadways shall be provided.

A seating arrangement plan, if applicable, indicating the number of seats, seat spacing, aisle locati widths, exit widths/locations and exit sign locations shall be provided on a floor plan.

A table arrangement plan, if applicable, indicating number of tables, table dimensions and locatio locations and widths shall be provided on the floor plan.

Number, type, rating and locations of portable fire extinguishers shall be indicated on the floor pla

eriod

Use of any tent, canopy or temporary membrane structure shall not exceed a use period of 180 days wi nth period on a single premise.

ons, Access and Parking

SUMMA TAKE TENT SIZES & layout:

TENT SIZES:

- (1) 1 - 10x30 FESTIVAL TENT FOR CHECK-IN (ON ENTRANCE)
- (2) 3 - 10x10 FESTIVAL TENTS FOR AUCTION CASHIER + GIFT SHOP
- (3) 1 - 10x20 FESTIVAL TENT OF SCREAMIN' MIMI'S (ICE CREAM)
- (4) 1 - 10x30 FESTIVAL FOR FANTASY KITCHEN
- (5) 4 10x20 FESTIVAL TENTS FOR CHEF PREPARATION
- (6) 1 - 10x10 ^{FESTIVAL} FIVE STAR STAGING TENT
- (7) 1 - 40x60 FESTIVAL FOR DIY CREEK
- (8) 1 40x60 FESTIVAL FOR ALEXANDER VALLEY
- (9) 1 40x40 FESTIVAL AND 2 10x10 FESTIVAL FOR SILENT AUCTION
- (10) 1 40x80 GENESIS TENT FOR RUSSIAN BUREAU
- (11) 1 40x40 OR 40x60 FESTIVAL FOR SUMMA VALLEY
(THIS WILL BE FINANCED BY 5/15/02)

- (1) 80 x 250 WHITE TENT FOR DINING
- (2) 1 20 x 60 TENT FOR CATERING
- (3) 3 10 x 10 BOSSIN, TENTS
- (4) 3 10 x 10 TENTS FOR ENTRY (LOCATIONS TO BE DETERMINED)
- (5) 1 10 x 20 TENT FOR ENTERTAINERS CHAIRS
- (6) POSSIBLY 2 10 x 10 TENTS FOR RESTROOM COVER TO BE OBTAINED. 5/15/02.
- (7) 2 10 x 10 TENTS FOR AUDIO VIDEO



Richard's Grove & Saralee's Vineyard, Inc.

"Located in Sonoma County's Russian River Valley"

3575 Slusser Road

Windsor, California 95492

(707) 545-3276 ~ Fax (707) 546-3277

Rules & Regulations for 2002 Use of Richard's Grove & Saralee's Vineyard, Inc.

Welcome to Richard's Grove & Saralee's Vineyard, Inc. We are happy to have this beautiful setting available for your use and enjoyment. Please respect the natural beauty of the setting and leave the premises as you found them.

Please... When listing the event site on your invitations, flyers, news releases etc. please use:

Richard's Grove & Saralee's Vineyard

"Located in Sonoma County's Russian River Valley"

1. The use of the Grove for Non-Profit Organizations is limited to those events that involve the sale and/or promotion of agricultural products grown or processed in Sonoma County.
2. The consumption of alcoholic beverages is limited to Sonoma County Wine, Sonoma County Beer and Korbel Brandy. It is the responsibility of the organization using the premises to secure the necessary permits from ABC for the sale/consumption of alcoholic beverages. A copy of the permit must be received in our office seven (7) days prior to the event.
3. A certificate of insurance is required naming Richard's Grove & Saralee's Vineyard, Inc. Richard & Saralee Kunde, their officers, agents, and employees as additional insured in the amount of one million dollars (\$1,000,000.00) of liability insurance coverage. This must be received in our office seven (7) days prior to the event.
4. Noise shall be controlled in accordance with Table NE-2 of the Noise Element of the Sonoma County General Plan.
5. Handicap-accessible restrooms are available at the Grove. For large events, *you will need to rent additional temporary portable toilets.* Please leave them neat and tidy.
6. A licensed Sonoma County Caterer must be secured to do food for gatherings open to the public by Non-Profit Organizations. There are no approved cooking facilities or coded kitchens on the site.
7. Please park all cars headed into the center of the vine rows starting on left side of driveway! **NO parking on right side of driveway or Slusser Road! NO driving or parking on the lawn area!** Four to eight (4-8) people must be designated as parking attendants during your event. We can suggest a 4-H parking team for your event. Please make arrangements to meet seven (7) days prior to event to go over parking at the site.
8. 4'x4' bins are scattered for your use to dispose of solid waste/trash. You will need to empty them following your use and recycle all you can. Please separate all glass, plastic & aluminum from other solid waste/trash.
9. All Dairy products served at your event must be Clover Stornetta brand (Sonoma County Products must be used). No Non-Dairy creamers are allowed.
10. No staples, nails, pins, tacks, etc., may be placed in any tables, benches or trees. No stakes may be driven into the lawn.
11. We will not be providing help in setting up tables and benches or helping with clean up. *Please leave it like you found it.*

TREE TABLE

1. 30" W.O.	17. 42" W.O.	33. 51" W.O.	49. 33" W.O.	65. 27" W.O.
2. 8" W.O.	18. 50" W.O.	34. 55" W.O.	50. 20" W.O.	66. 25" W.O.
3. 7" W.O.	19. 40" W.O.	35. 60" W.O.	51. 32" W.O.	67. 48" W.O.
4. 7" W.O.	21. 54" W.O.	36. 22" W.O.	52. 40" W.O.	69. 32" W.O.
5. 14" I.O.	22. 24" W.O.	37. 16" W.O.	53. 44" W.O.	70. 42" W.O.
6. 8" W.O.	23. 40" W.O.	38. 18" W.O.	54. 18" W.O.	71. 28" W.O.
7. 10" W.O.	24. 35" W.O.	39. 20" W.O.	55. 28" W.O.	72. 53" W.O.
8. 9" W.O.	25. 22" W.O.	40. 54" Ash	56. 24" W.O.	73. 8" W.O.
9. 18" W.O.	26. 22" W.O.	41. 38" W.O.	57. 50" W.O.	74. 8" W.O.
10. 15" W.O.	27. 32" W.O.	43. 38" W.O.	58. 30" W.O.	75. 40" W.O.
11. 6" W.O.	28. 28" W.O.	44. 40" W.O.	59. 36" W.O.	76. 40" W.O.
12. 48" W.O.	30. 48" W.O.	45. 58" W.O.	60. 36" W.O.	77. 40" Buckeye
13. 14" W.O.	31. 30" W.O.	46. 34" W.O.	61. 42" W.O.	78. 18" & 10" Buckeye
14. 40" W.O.	32. 18" W.O.	47. 21" W.O.	62. 26" W.O.	79. 30" W.O.
15. 26" W.O.		48. 22" W.O.	63. 27" W.O.	80. 28" W.O.
16. 38" W.O.			64. 26" W.O.	

APPLICANTS:

Richard & Soralee Kinde
3575 Slusser Road
Windsor, CA 95192
(707) 546-3276

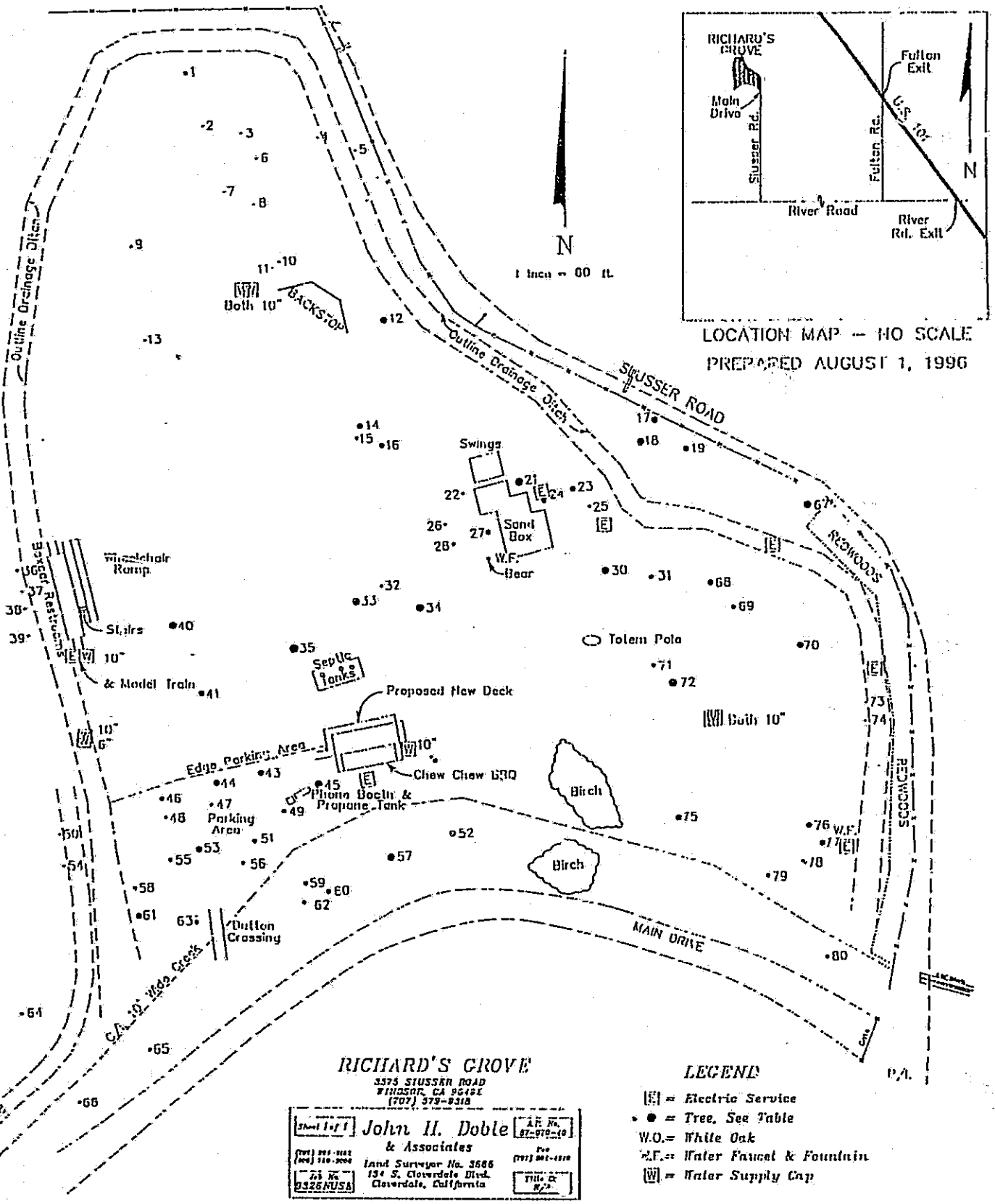

LOCATION MAP - NO SCALE
PREPARED AUGUST 1, 1996

RICHARD'S GROVE
3575 SLUSSER ROAD
WINDSOR, CA 95192
(707) 546-3276

John H. Doble
& Associates
Land Surveyor No. 3686
134 S. Cloverdale Blvd.
Cloverdale, California

LEGEND

- [E] = Electric Service
- = Tree, See Table
- W.O. = White Oak
- W.F. = Water Faucet & Fountain
- [W] = Water Supply Cap

Richard's Grove



Saralee's Vineyard

Richard's Grove & Saralee's Vineyard, Inc.

"Located in Sonoma County's Russian River Valley"

Rich & Saralee M. Kunde

3575 Slusser Road

Windsor, California 95492

Phone 707 546-3276 • 579-9318

Fax 707 546-3277

Special Event/Cultural Event – Proposal Statement

Date:

July 13, 2002

Time:

12 noon to 5:00 p.m.

Activities to be held:

Wine & Food Tasting and Silent Auction

Number of Participants:

1,500

Food & Wine:

The event will include a food and wine tasting by 70+ wineries and 20+ chefs and caterers

Road Closure:

None

Alcoholic Beverages:

Wine

Restroom Facilities:

The Sonoma County Wineries Association will provide a sufficient number of portable restrooms to accommodate the number of participants.

FROM: Five Star Productions

FAX NO.: 7072551929

APR. 07 2002 01:32PM P4

FROM: NUFG

FAX NO.: 7077623704

APR. 25 2002 03:08AM P6

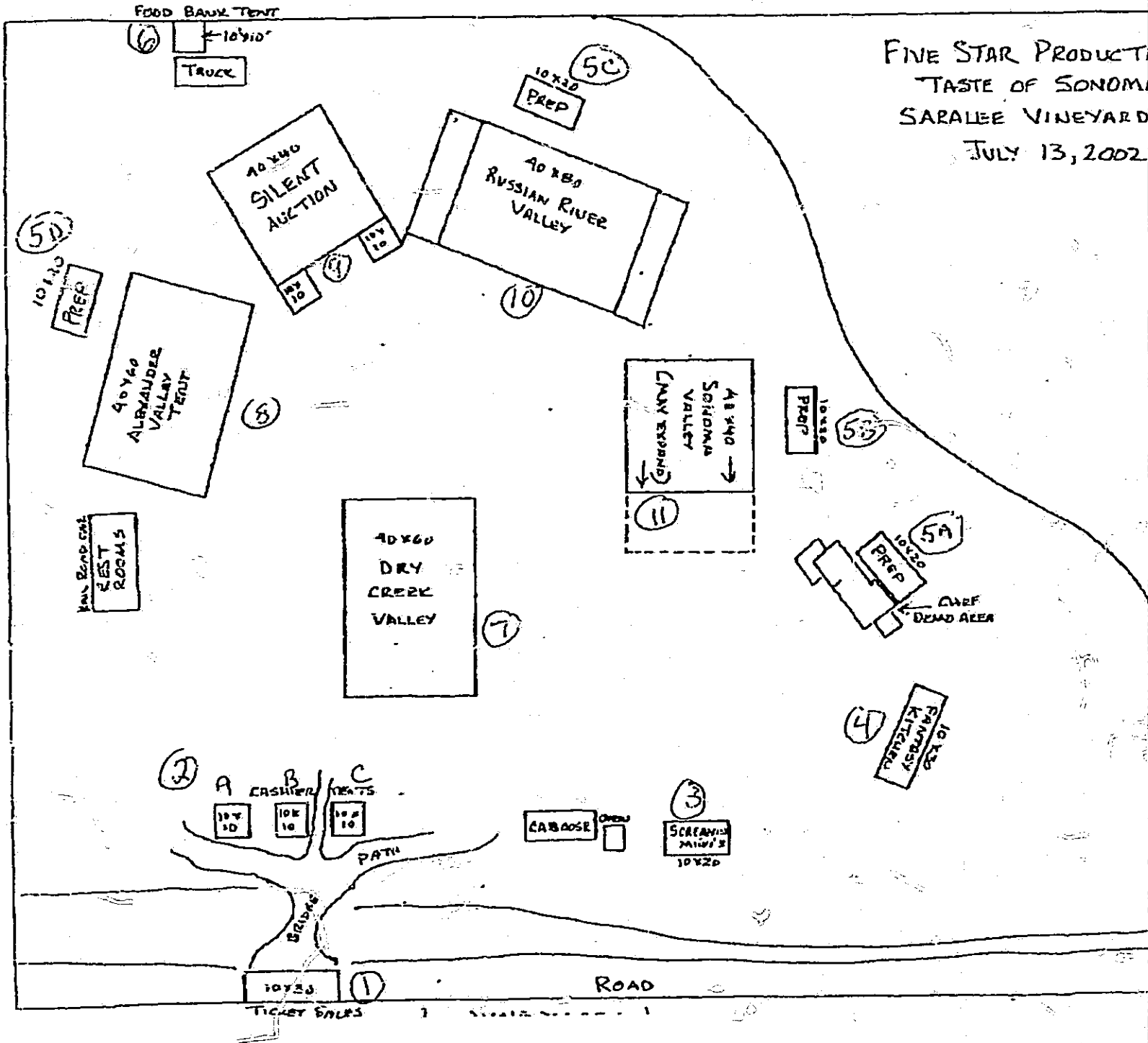

Barrel auction Tent sizes + layout + table schematic

3

2

FILE: ZP02-0127

SCWA

Applicant

3575/440/Slusser Rd,
Address

Windsor

AFFIDAVIT OF NOTICING

I, Shelley Caballera, posted three copies of the attached poster at the following:
(Name of responsible planner)

locations on or near the subject property: (description of location)

At 3575 Slusser Rd, Windsor

At entrance to 440 Slusser Rd, Windsor

75 ft South of 3575 Slusser Rd, Windsor on June 26, 2002
(Date)

I declare under penalty of perjury under the laws of the State of California that the foregoing is true and correct.

6-26-02
(Date)

Shelley Caballera
(Signature)

I, _____, mailed the attached notice to:
(Name of responsible Secretary)

_____ the County Clerk's Office on _____

_____ the newspaper on _____

_____ to each owner of record within 300 feet of the subject property and to applicant/owner and others that have requested notification on _____

I declare under penalty of perjury under the laws of the State of California that the foregoing is true and correct.

(Date)

(Signature)

NOTICE OF ZONING PERMIT

REQUEST FOR A CULTURAL EVENT/OUTDOOR FESTIVAL

NOTICE IS HEREBY GIVEN THAT A ZONING PERMIT APPLICATION HAS BEEN FILED WITH THE SONOMA COUNTY PERMIT AND RESOURCE MANAGEMENT DEPARTMENT FOR A CULTURAL EVENT/OUTDOOR FESTIVAL

EVENT DESCRIPTION:	Zoning permit for a cultural event for the Sonoma County Wineries Association showcase of wine and food tasting, and silent auction/Symphony event with dancing for approximately 1500 guests
DATE:	July 13, 2002
TIME:	12:00 p.m. to 5:00 p.m. 5:00 p.m. to 12:00 a.m.
FILE NO.:	ZPE 02-0127
LOCATION:	3575 Slusser Road, Windsor 4401 Slusser Rd, Windsor
ZONING:	DA (Diverse Agriculture), B6, 60 acre density, Z (Second Dwelling Unit Exclusion), F2 (Secondary Flood Plain) ;
ASSESSOR PARCEL #:	057-070-041/057-070-031
APPLICANT/OWNER:	Sonoma County Wineries Association/Sonoma-Cutrer Vineyards, Inc./Richard's Grove & Saralee's Vineyard

NOTICE IS FURTHER GIVEN THAT THE COUNTY PERMIT AND RESOURCE MANAGEMENT DEPARTMENT WILL ISSUE A ZONING PERMIT FOR A CULTURAL EVENT/OUTDOOR FESTIVAL AT THIS PROPERTY IF A WRITTEN APPEAL AND THE APPROPRIATE FILING FEE IS NOT RECEIVED WITHIN 10 DAYS FROM THE DATE OF THIS NOTICE. YOU MUST SPECIFY THE REASONS FOR YOUR APPEAL. (SEE CURRENT SCHEDULE FOR APPEAL FEE.)

PERSONS WISHING TO OBTAIN MORE INFORMATION ABOUT THIS APPLICATION, OR TO APPEAL IN WRITING, MUST CONTACT THE SONOMA COUNTY PERMIT AND RESOURCE MANAGEMENT DEPARTMENT, 2550 VENTURA AVENUE SANTA ROSA, CA 95403 (707) 565-2258.

SONOMA COUNTY PERMIT AND RESOURCE MANAGEMENT DEPARTMENT

DATED: June 26, 2002

STAFF: Shelley Cabanilla



COUNTY OF SONOMA
PERMIT AND RESOURCE MANAGEMENT DEPARTMENT

2550 Ventura Avenue, Santa Rosa, CA 95403
(707) 565-1900 FAX (707) 565-1103

July 8, 2002

Sonoma County Wineries Assoc.
Attn: Michael Monahan
5000 Robert's Lake Road
Rohnert Park, CA 94928

Re: ZPE 02-0127; 3575 Slusser Road, Windsor

The Sonoma County Permit and Resource Management Department hereby grants the request for a Zoning Permit for a cultural event for the Sonoma County Wineries Association showcase of wine and food tasting, and silent auction for approximately 1500 guests scheduled for July 13, 2002, from 12:00 p.m. to 5:00 p.m.

Approval and conditions have been received from Building, Environmental Health, Fire Services, and Transportation and Public Works. All of the conditions imposed by these Divisions shall be adhered to.

It is the determination of the Permit and Resource Management Department that the project is Categorically Exempt from the provisions of the California Environmental Quality Act pursuant to the Provisions of Title 14 of the California Administrative Code, Section 15301.

This zoning permit is limited to the use as described on the application form, the proposal statement and the site plan submitted to this Department. Any modifications of the use, expansion or alteration shall be submitted for review and approval of the Permit and Resource Management Department in advance of the proposed change and may, at the discretion of the department, require a new zoning permit.

If you have any questions, feel free to contact me at 565-2258. Please refer to your file number (ZPE 02-0127) when making inquiries.

Sincerely,

Shelley Cabanilla
Project Planner

:sm

c: File ZPE 02-0127
Richard's Grove & Saralee's Vineyard