



COUNTY OF SONOMA
PERMIT AND RESOURCE MANAGEMENT DEPARTMENT

2550 Ventura Avenue, Santa Rosa, CA 95403
(707) 565-1900 FAX (707) 565-1103

March 8, 2016

Re: Proposed Planning Application in your Neighborhood

File No.: CPN16-0004
Address: 22400 Timber Cove Road, Timber Cove
APN: 109-200-014

Dear Property Owner:

As the Project Planner for the County of Sonoma Permit and Resource Management Department (PRMD) I am notifying you of a recently received application for a Coastal Permit for a new addition to an existing single family dwelling located at the above referenced address.

We are very early in the application review process and no action has been taken on this application. However, the purpose of this communication is to provide you early notification and an opportunity to review, comment, or ask questions about the proposed project.

You can contact the project applicant directly (Michael Hallett / 707-847-3468 / michael@countryarchitect.com), or you can review the project application in more detail at PRMD Records Counter located at 2550 Ventura Avenue, Santa Rosa. Alternatively, please feel free to contact me at 707-565-1683 or at Jennifer.Faso@sonoma-county.org if I can be of assistance. Please refer to the file number (CPN16-0004) and site address when making inquiries.

No response is necessary at this time unless you need additional information on the project. Please be advised that you will receive a separate public notice related to action to be taken on the project.

Thank you for your input.

Sincerely,

Jennifer Faso
Project Planner

:mm

c: File No.: CPN16-0004
Michael Hallett
Don and Suzanne Lindsey



COUNTY OF SONOMA
PERMIT AND RESOURCE MANAGEMENT DEPARTMENT

2550 Ventura Avenue, Santa Rosa, CA 95403
(707) 565-1900 FAX (707) 565-1103

March 8, 2016

Re: Proposed Planning Application in your Neighborhood

File No.: CPN16-0004
Address: 22400 Timber Cove Road, Timber Cove
APN: 109-200-014

Dear Property Owner:

As the Project Planner for the County of Sonoma Permit and Resource Management Department (PRMD) I am notifying you of a recently received application for a Coastal Permit for a new addition to an existing single family dwelling located at the above referenced address.

We are very early in the application review process and no action has been taken on this application. However, the purpose of this communication is to provide you early notification and an opportunity to review, comment, or ask questions about the proposed project.

You can contact the project applicant directly (Michael Hallett / 707-847-3468 / michael@countryarchitect.com), or you can review the project application in more detail at PRMD Records Counter located at 2550 Ventura Avenue, Santa Rosa. Alternatively, please feel free to contact me at 707-565-1683 or at Jennifer.Faso@sonoma-county.org if I can be of assistance. Please refer to the file number (CPN16-0004) and site address when making inquiries.

No response is necessary at this time unless you need additional information on the project. Please be advised that you will receive a separate public notice related to action to be taken on the project.

Thank you for your input.

Sincerely,

Jennifer Faso
Project Planner

:mm

c: File No.: CPN16-0004
Michael Hallett
Don and Suzanne Lindsey

109-400-036
BORDESSA JERRY A ET AL
PO BOX 483
PENNGROVE CA 94951-

109-410-039
CULCASI SALVATORE ANTHONY TR & CULCASI CI
1830 CASTELLINA DR
BRENTWOOD CA 94513-

109-480-015
FORRY TIMOTHY R TR & FORRY NANCY A TR
PO BOX 133
MONTE RIO CA 95462-

109-410-007
FRENCH DAVID A TR
22100 KOFTINOW
JENNER CA 95450-9710

109-400-001
MCKUSICK TIMOTHY H & MARYLOU
22153 PINE CT
JENNER CA 95450-

109-400-038
SWANSON CHARLES H
23440 FORT ROSS RD
CAZADERO CA 95421-9776

109-400-003
TIMBER COVE COUNTY WATER DISTRICT
PO BOX 204
CAZADERO CA 95421-

109-200-014
TIMBER DELL PROPERTIES LLC
1406 WEBSTER ST
ALAMEDA CA 94501-

109-410-020
ZAPIAIN ESTEBAN A ET AL
2287 GROUSE WAY
UNION CITY CA 94587-4612

DON AND SUZANNE LINDSEY
1255 SHERMAN STREET
ALAMEDA CA 94501-

109-400-028
BROWN STEVEN R ET AL
25 LIBERTY RD
PETALUMA CA 94952-

109-480-014
FORRY TIMOTHY R TR & FORRY NANCY A TR
PO BOX 133
MONTE RIO CA 95462-

109-410-008
FRENCH DAVID A TR
22100 KOFTINOW
JENNER CA 95450-9710

109-200-037
LORENZINI GIANNI LIFE EST
PO BOX 68
STEWARTS POINT CA 95480-0068

109-410-009
ROMEO MICHAEL A TR & TINA M TR
20705 HIGHWAY 1
JENNER CA 95450-

109-400-002
TIMBER COVE COUNTY WATER DISTRICT
PO BOX 204
CAZADERO CA 95421-

109-200-015
TIMBER DELL PROPERTIES LLC
1406 WEBSTER ST
ALAMEDA CA 94501-

109-410-006
WREN CHRISTOPHER M & WREN ELEANOR B
8443 FERNCLIFF AVE NE
BAINBRIDGE ISLAND WA 98110-2937

MICHAEL HALLETT
9425 BEN WAY
CAZADERO CA 95421

Results

Records returned (20)

Parcels

Select all Unselect all Zoom to all Clear

Select Parcel Number Adj

109-410-008 N

Map Contents

Property

- Special Addresses (SPAD)
- Place Names
- Parcel Centroids
- PRMD Permits
- Parcels
- Buildings
- Public Lands
- Special Assessment District

Reference

- Hospitals
- Schools
- Airport Runways

Transportation

Report

Buffer

Buffer Distances Select Buffer Clear

310 Feet

Export Template

PRMD Mailing Labels

Click Here for the Buffer Map

Click Here for the CSV File

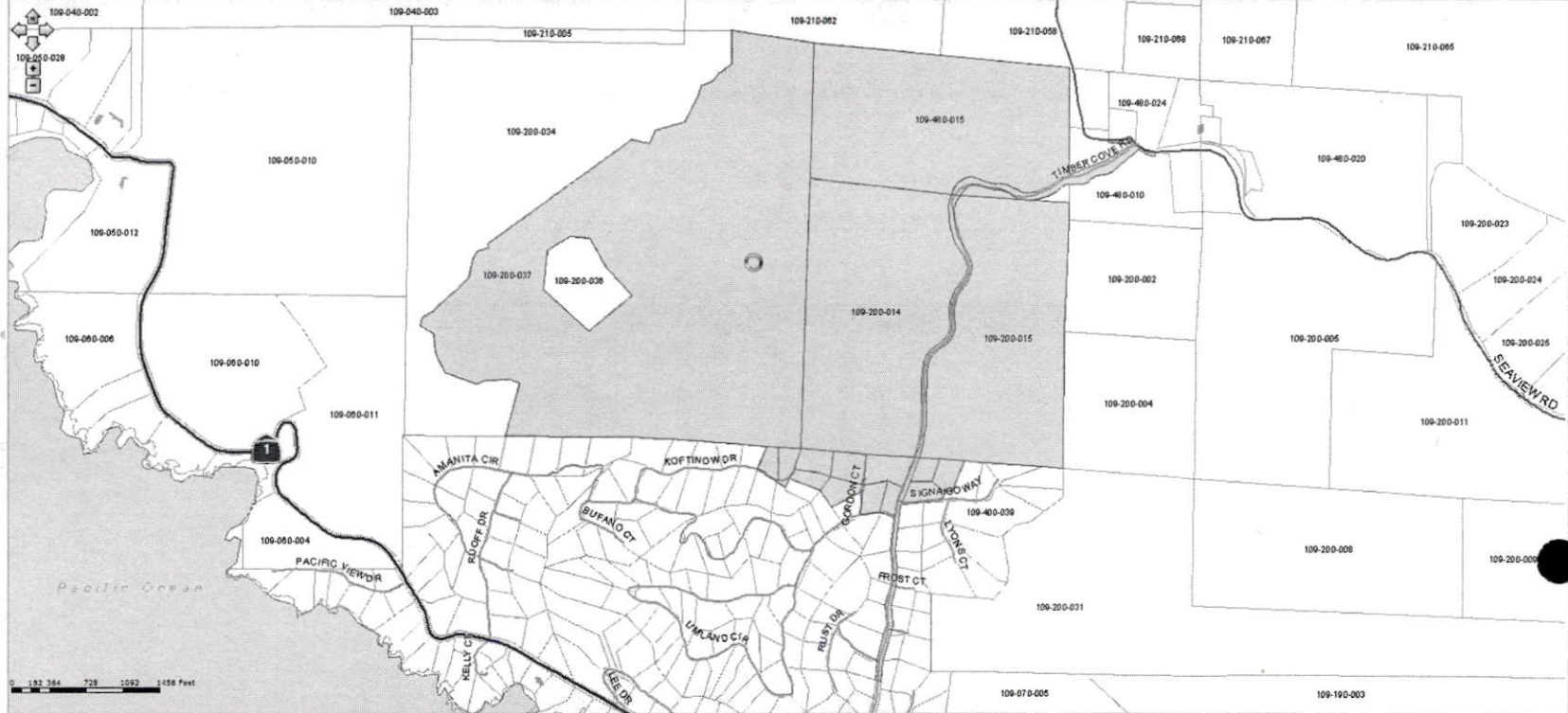

6195508.471, 1965707.37



Pending Action on a Coastal Permit No Public Hearing Required

Sonoma County Permit and Resource Management Department
2550 Ventura Avenue, Santa Rosa, CA 95403
(707) 565-1900 FAX (707) 565-1103

August 25, 2016

Planner: Jennifer Faso

For a development located within the Sonoma County Coastal Zone.

Application Filing Date: March 3, 2016
File No: CPN16-0004
Applicant: Michael Hallett
Assessor's Parcel No: 109-200-014
Proposed Project Location: 22400 Timber Cove Road, Timber Cove
Zoning: TP (Timberland Production District), CC (Coastal Combining),
B6- 160/640 (AC/DU), G (Geologic Combining), SR (Scenic
Resource)
Supervisorial District: 5
Project Description: Request for a Coastal Permit without hearing for a 493 square
foot addition to an existing single family dwelling, addition to
existing deck and the construction of a new detached garage
and storage building on an 84 acre parcel.

It is the determination of the department that the project is categorically exempt from the provisions of the California Environmental Quality Act pursuant to the Provisions of Title 14 of the California Administrative Code, Section 15301, because the project involves the addition to an existing single family dwelling with no significant impacts to the environment.

Date Application Will Be Acted Upon: September 8, 2016

A 10 calendar day public comment period from the date of this notice allows interested persons to inform the County, in writing, of any concerns they have regarding the proposed project.

Please submit any comments by: September 6, 2016

Comments will be reviewed prior to local decision making. This project does not require a public hearing unless the administrative decision is appealed.

The project is Not Appealable to the Coastal Commission.

Persons wishing to obtain more information about this proposal, or to appeal in writing, must contact the Sonoma County Permit and Resource Management Department, 2550 Ventura Avenue, Santa Rosa, CA 95403. Contact Jennifer Faso at Jennifer.Faso@sonoma-county.org or at 707-565-1683.

109-400-ROW

109-480-ROW

CPN 160004
Mailing list

999-999-ROW

109-480-014

109-480-015

FORRY TIMOTHY R TR & FORRY NANCY A TR

PO BOX 133

MONTE RIO CA 95462-

109-410-007

FRENCH DAVID A TR

22100 KOFTINOW

JENNER CA 95450-9710

109-410-009

ROMEO MICHAEL A TR & TINA M TR

20705 HIGHWAY 1

JENNER CA 95450-

109-400-002

TIMBER COVE COUNTY WATER DISTRICT

PO BOX 204

CAZADERO CA 95421-

109-200-014

TIMBER DELL PROPERTIES LLC

1406 WEBSTER ST

ALAMEDA CA 94501-

FORRY TIMOTHY R TR & FORRY NANCY A TR

PO BOX 133

MONTE RIO CA 95462-

109-410-008

FRENCH DAVID A TR

22100 KOFTINOW

JENNER CA 95450-9710

109-200-037

LORENZINI GIANNI LIFE EST

PO BOX 68

STEWARTS POINT CA 95480-0068

109-400-038

SWANSON CHARLES H

23440 FORT ROSS RD

CAZADERO CA 95421-9776

109-200-015

TIMBER DELL PROPERTIES LLC

1406 WEBSTER ST

ALAMEDA CA 94501-