

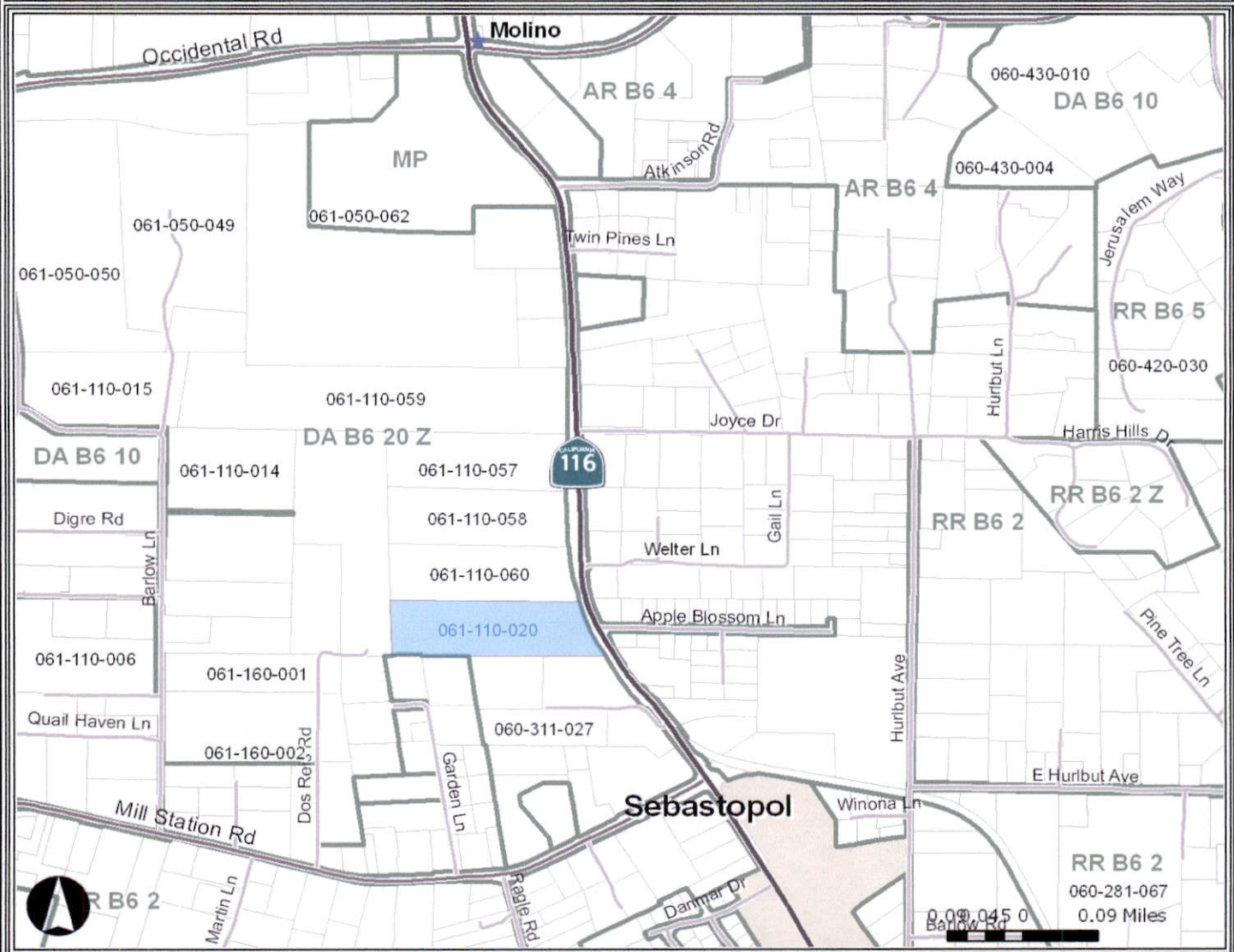

# County of Sonoma Permit and Resource Management Department California

Permit and Resource Management Department  
DEPARTMENT INFORMATION SYSTEMS  
COUNTY OF SONOMA

## Zoning Theme



### Zoning Designations

- Land Use Policy
- Zoning by Area
- AH Affordable Housing
- SR Scenic Resource
- SD Scenic Design
- MR Mineral Resource

### Base Layers

- F1 Floodway
- F2 Floodplain
- HD Historical District
- G Geologic Hazard
- VOH Valley Oak Habitat
- Geographic Places
- Urban Service Areas
- Lake Sonoma
- Parcels
- City Limits

- Streets
- US Federal Highway
  - State Highway
  - Major Road
  - Residential Street

Map Scale and Reproduction methods limit precision in physical features displayed. This map is for illustrative purpose only, and is not suitable for parcel-specific decision making. Site-specific studies are required to draw parcel-specific conclusions. Aerial photos are provided by DigitalGlobe Copyright 2008.

Map Generated by:  
**ActiveMap**

Created on 3/24/2013 at 3:15PM



# County of Sonoma Permit and Resource Management Department California

Permit and Resource Management Department  
DEPARTMENT OF INFORMATION SYSTEMS  
COUNTY OF SONOMA

## Base Map Theme

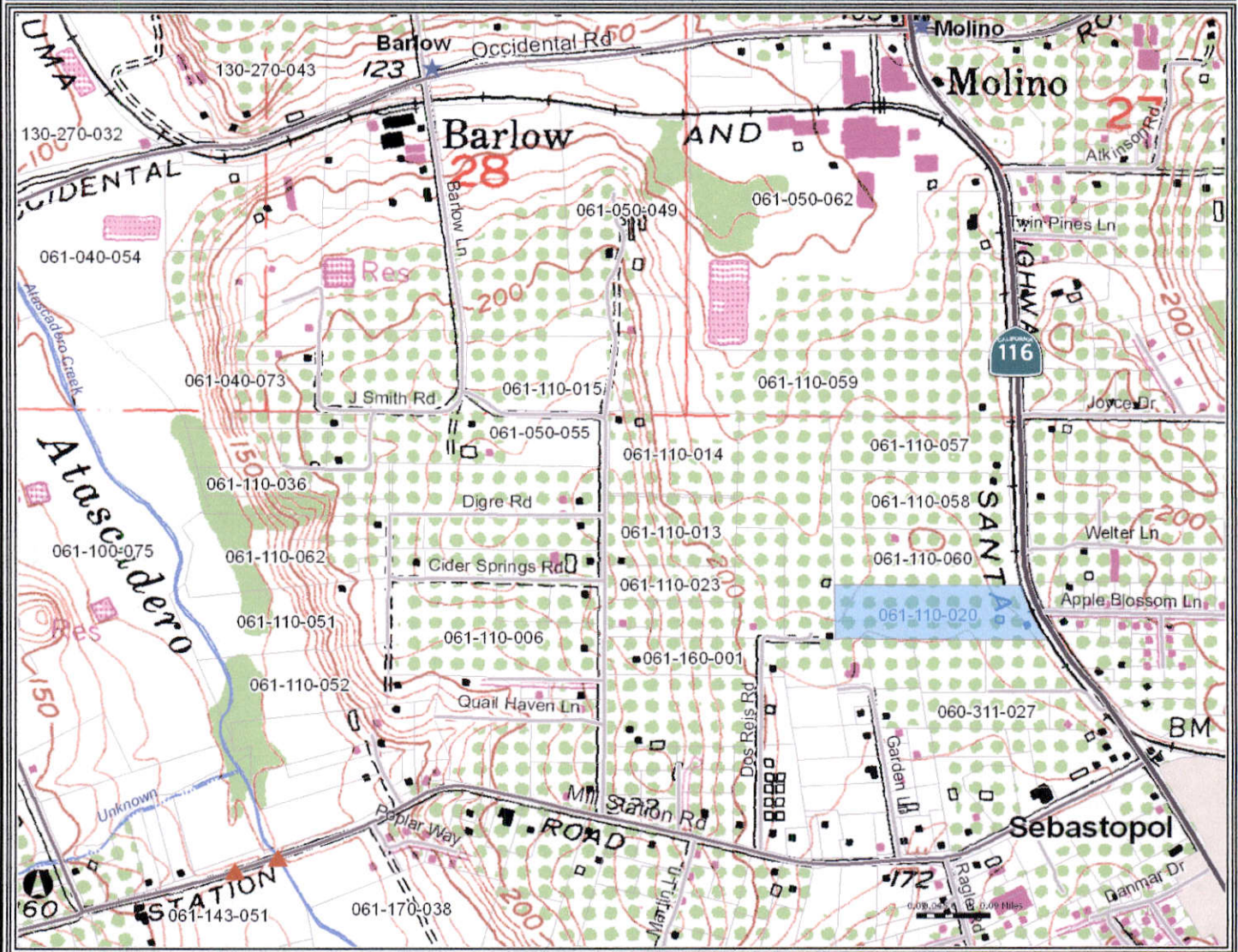

### Planning

- Area & Specific Plans
- Local Area Development Guidelines
- Redevelopment Plans
- Williamson Act Land Contracts
  - Type I
  - Type I (Phase-out)
  - Type II
  - Type II (Phase-out)
  - Type II (Open Space)

### Air Quality Measure

- Air Quality Control Board
  - Northern Sonoma County
  - Bay Area

### Well and Septic

- Water Quality Control Board
  - North Coast Region
  - San Francisco Region
- Waiver Prohibition Areas
- Flood Prone Urban Areas

### Wet Weather Zones

- Zone A - Petaluma
- Zone B - Sonoma
- Zone C - Santa Rosa
- Zone D - Sebastopol
- Zone E - Guerneville
- Zone F - Healdsburg
- Zone G - Cloverdale

### Base Layers

- Geographic Places
- City Sphere of Influence
- City Urban Growth

### Planning Areas

- Urban Service Areas
- Lake Sonoma
- Streets
  - US Federal Highway
  - State Highway
  - Major Road
  - Residential Street
- Streams
  - Perennial
  - Intermittent

### Parcels

- City Limits
- Supervisor Districts
  - District 1
  - District 2
  - District 3
  - District 4
  - District 5
- Fire Protection Responsibility Area
  - Federal
  - State
  - Local

Map Scale and Reproduction methods limit precision in physical features displayed. This map is for illustrative purpose only, and is not suitable for parcel-specific decision making. Site-specific studies are required to draw parcel-specific conclusions. Aerial photos are provided by DigitalGlobe Copyright 2008.

Created on 3/24/2013 at 3:49PM

