

# COUNTY OF SONOMA

## PERMIT AND RESOURCE MANAGEMENT DEPARTMENT

2550 Ventura Avenue, Santa Rosa, CA

(707) 565-1900 FAX (707) 565-1103

### APPLICATION RECEIPT

WEL99-0697

Date: Dec 15, 1999

Time: 08:47

#### Site Location Information

Address: 4660 HESSEL RD HES

Cross Street:

Area #: 10

APN: 062-112-005

Owner	Applicant
MC BRIDE PAUL TR 4660 HESSEL RD SEBASTOPOL CA 954726250	WEEKS DRILLING & PUMP CO INC PO BOX 176 SEBASTOPOL CA 95473 (707) 542-3272
Contractor	Engineer
WEEKS DRILLING & PUMP CO INC PO BOX 176 SEBASTOPOL CA 95473 (707) 542-3272 Lic. #: 177681	

Date: 12/15/99

Expires:

Printed By: BKEARNS

Description of Work: NEW WELL

Item #	Item Account Code	Description	Fee	Prev. Paid
0391	1343 0425	CLASS I WATER WELL	\$327.00	\$ .00
0392	1343 0426	CLASS II WATER WELL	\$ .00	\$ .00
0393	1343 0427	WAIVER (WATER WELL)	\$ .00	\$ .00
0394	1343 0428	WATER WELL DESTRUCTION	\$ .00	\$ .00
0395	1343 0429	WELL PERMIT HOURLY RATE	\$ .00	\$ .00
0396	1343	WELL YIELD REPORT	\$ .00	\$ .00
0397	1343	GEOTECHNICAL BORINGS	\$ .00	\$ .00
			\$327.00	\$ .00

Total Calculated Fees \$327.00

Previously Paid \$ .00

Balance Due \$327.00

CASH REGISTER  
VALIDATION  
REQUIRED

016937 12/15/99A01

# 0990697

SIERRA \$327.00

\*\*\*TTL \$327.00

CHECK \$327.00

CHNG \$0.00

COUNTY OF SONOMA  
PERMIT & RESOURCE MANAGEMENT DEPARTMENT  
WELL & SEPTIC SECTION  
2550 VENTURA AVENUE  
SANTA ROSA, 95403  
(707) 565-1900

APPLICATION FOR PERMIT  
WATER WELL

WELL ADDRESS 4660 Hessel RD  
CITY Sebastopol, CA ZIP 95472  
PROPERTY OWNER Paul McBride  
ADDRESS 4660 Hessel RD. Seb  
DRILLING CONTRACTOR WEEKS DRILLING & PUMP CO.  
ADDRESS P.O. Box 176 Sebastopol, CA 95473

APPLICATION No. Wel. 99-0697  
ASSESSOR'S PARCEL No. 62-112-05  
PHONE No. \_\_\_\_\_  
CONTRACTOR LICENSE No. C57-177681  
PHONE No. 707-542-3272

TYPE OF WORK: ☒ Class I Permit ☐ Class II Permit ☒ New Well ☐ Reconstruct ☐ Test well, Test hole ☐ Destruct ☐ Other: \_\_\_\_\_

PROPOSED USE: ☒ Domestic, Single Family ☐ Domestic, Public ☒ Irrigation ☐ Industrial ☐ Other: \_\_\_\_\_ 016937 12/15/99A01

CONSTRUCTION PROPOSED:

Casing: Diameter: 6 Gauge: 302 21 Material: PVC Conductor: No ☒ Single ☐ Double ☐ Gravel Pack: No ☒ Yes ☐ STIRRE  
Annular Space: Size: 2" Depth of Seal: 100' Concrete: 1 Grout: 1 Neat Cement: 1 Puddled Clay: CHNG  
Method of Disinfection: HTH Method of Sealing Access Opening: WELL CAP Type of Joint: CHNG

#  
0990697  
\$327.00  
\$327.00  
\$327.00  
\$0.00

Well located within an existing public water system boundary: Yes ☐ No ☒ Name: \_\_\_\_\_

I hereby agree to comply with all laws and regulations of the County of Sonoma and State of California pertaining to water well construction. I will telephone (707) 565-1694 to notify the Environmental Health Specialist when I am commencing this work. I will furnish the Permit and Resource Management Department and the owner a copy of the State Water Well Driller's Report within 60 days in order to obtain final approval on this well. I acknowledge that the application will become a permit only after site approval and payment of fee. I understand that this permit is not transferrable and expires one year from date of issuance.

Signature of Well Driller Donald Garner Date 12-14-99

CONSTRUCTION PROPOSED:

- ☒ A currently effective certificate of Worker's Compensation Insurance is on file with the Sonoma County PRMD.  
☐ I certify that in the performance of the work for which this permit is issued I shall not employ any person in any manner so as to become subject to the Worker's Compensation laws of California.

Insurance Carrier LEGION Policy # WC109872177  
Signature of Applicant Donald Garner Date 12-14-99

FOR OFFICE USE ONLY - ENVIRONMENTAL HEALTH SERVICE

Site approved by: ALF. J. Lauer Date: 12-20-99 Water Scarce Area: Yes ☐ No ☒  
Finaled by: ALF. J. Lauer Date: 8-3-2000 Sealed to depth of \_\_\_\_\_  
Seal Observed: Yes ☐ No ☒

Indicate below the exact location of well with respect to the following items: property lines, water bodies or water courses, drainage pattern, roads, existing wells, sewer main and laterals and private sewage disposal systems or other sources of contamination or pollution. INCLUDE DIMENSIONS. The validity of this permit depends upon the accuracy of the information provided by the applicant.

See ATTACHED



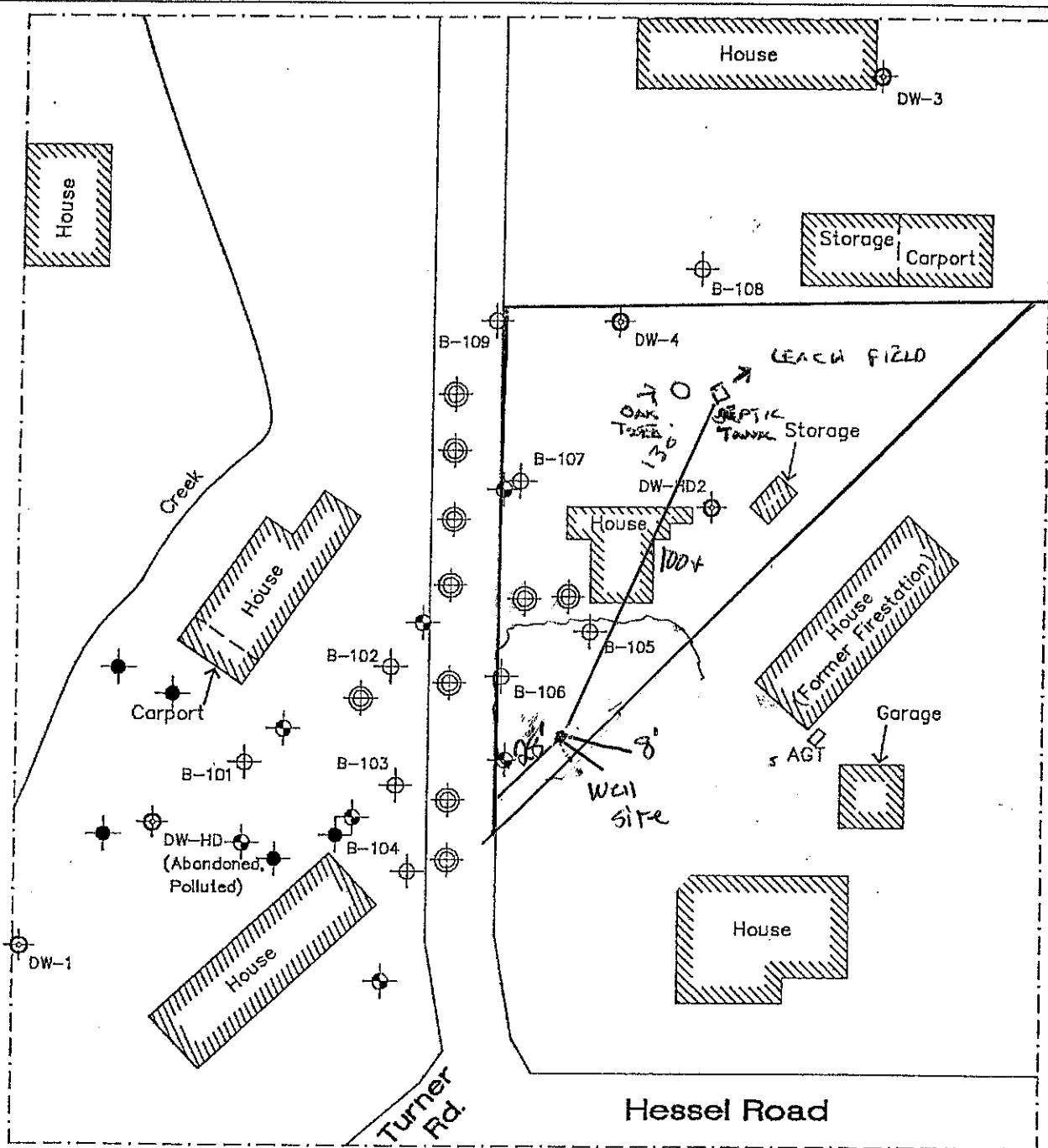

PAUL M. C. BRIDGE  
 4660 HESSEL RD  
 SEBASTOPOL CA 95472  
 823 0428  
 ASSESSOR'S PARCEL # 62-112-05  
 1/3 ACRE

#### LEGEND

- Boring/Hydropunch Location
- Water Supply Well
- Proposed Soil Boring Location
- Proposed Monitoring Well Location
- Proposed Hand Auger Locations

0 25' 50'  
 Scale: 1" = 50'



**EnviroNet**

CONSULTING

#### SITE PLAN PROPOSED DRILLING LOCATIONS

John Riddell  
 4660 Hessel Road  
 Sebastopol, California

823-1976

PLATE

2

DRAWN BY:  
 AJH

DWG NAME:  
 61191-2B

APPROVED BY:  
 GSJ

JOB NUMBER:  
 6119.1

REVISIONS:

DATE:  
 4/22/98

**QUADRUPLICATE**  
**For Local Requirements**

STATE OF CALIFORNIA  
**WELL COMPLETION REPORT**

Refer to Instruction Pamphlet

Page      of     

Owner's Well No.     

Date Work Began 1/13/2000, Ended 1/20/2000 **No. 719351**

Local Permit Agency SONOMA CO. PERMIT AND RESOURCE MGT.

Permit No. WEL99-0697 Permit Date 12/20/1999

DWR USE ONLY — DO NOT FILL IN	
STATE WELL NO./STATION NO.	
LATITUDE	LONGITUDE
APN/TRS/OTHER	

**GEOLOGIC LOG**

ORIENTATION (✓) <input checked="" type="checkbox"/> VERTICAL <input type="checkbox"/> HORIZONTAL <input type="checkbox"/> ANGLE <input type="checkbox"/> (SPECIFY)	
DEPTH FROM SURFACE	DRILLING METHOD <u>MUD ROTARY</u> FLUID <u>Bentonite</u>
Ft. to Ft.	DESCRIPTION <i>Describe material, grain size, color, etc.</i>
0 to 15	Light brown sands w/gravels turning into gray sand with rounded multi-colored gravels
15 to 30	Tight blue gray clay turning clay w/sand and gravel lenses
30 to 45	Gray sandy clay w/gravels and decomposed wood
45 to 60	Clean rounded gravels turning into tight brown sandy clay w/lenses of gravel
60 to 105	Tight brown sandy clay with cleaner lenses of sandy gravel
105 to 150	Brown clay turning into multi-colored medium to coarse grade sand
150 to 165	Brown orange sand w/rounded gravel
165 to 195	Tight blue green clay
195 to 225	Clay turns into clean sand w/gravel. Back into clay at 224'

**WELL OWNER**

Name MOBRIDE, PAUL  
Mailing Address 4660 Hessel Road  
Sebastopol, CA 95472  
CITY STATE ZIP  
Address 4660 Hessel Road  
City Sebastopol, CA  
County Sonoma  
APN Book 062 Page 112 Parcel 005  
Township      Range      Section       
Latitude      NORTH Longitude      WEST  
DEG. MIN. SEC. DEG. MIN. SEC.

**LOCATION SKETCH**

WEST EAST  
NORTH SOUTH  
Illustrate or Describe Distance of Well from Roads, Buildings, Fences, Rivers, etc. and attach a map. Use additional paper if necessary. **PLEASE BE ACCURATE & COMPLETE.**

**ACTIVITY (✓)**  
☒ NEW WELL  
MODIFICATION/REPAIR  
☐ Deepen  
☐ Other (Specify)  
**DESTROY (Describe Procedures and Materials Under "GEOLOGIC LOG")**  
**PLANNED USES (✓)**  
☒ WATER SUPPLY  
☐ Domestic ☐ Public  
☐ Irrigation ☐ Industrial  
MONITORING ☐  
TEST WELL ☐  
CATHODIC PROTECTION ☐  
HEAT EXCHANGE ☐  
DIRECT PUSH ☐  
INJECTION ☐  
VAPOR EXTRACTION ☐  
SPARGING ☐  
REMEDIATION ☐  
OTHER (SPECIFY) ☐

**WATER LEVEL & YIELD OF COMPLETED WELL**

DEPTH TO FIRST WATER      (FL) BELOW SURFACE  
DEPTH OF STATIC WATER LEVEL Artesian (FL) & DATE MEASURED 1/20/2000  
ESTIMATED YIELD 45 (GPM) & TEST TYPE Airlifted  
TEST LENGTH 1 (Hrs.) TOTAL DRAWDOWN 40 (FL)  
*\* May not be representative of a well's long-term yield.*

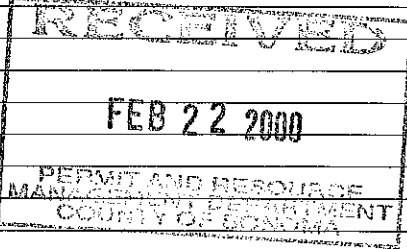

TOTAL DEPTH OF BORING 225 (Feet)  
TOTAL DEPTH OF COMPLETED WELL 215 (Feet)

DEPTH FROM SURFACE Ft. to Ft.	BORE-HOLE DIA. (Inches)	CASING (S)						DEPTH FROM SURFACE Ft. to Ft.	ANNULAR MATERIAL TYPE			
		TYPE (✓) BLANK SCREEN CON- DUCTOR FILL PIPE	MATERIAL / GRADE	INTERNAL DIAMETER (Inches)	GAUGE OR WALL THICKNESS	SLOT SIZE IF ANY (Inches)	CE- MENT (✓)		BEN- TONITE (✓)	FILL (✓)	FILTER PACK (TYPE/SIZE)	
0 to 225	11							0 to 100	X			
+2 to 217		X	PVC	6	CL200			100 to 215			X	12x20 Sand
115 to 135		X				.032						
175 to 215		X				.032						

**ATTACHMENTS (✓)**

- ☐ Geologic Log
- ☐ Well Construction Diagram
- ☐ Geophysical Log(s)
- ☐ Soil/Water Chemical Analyses
- ☐ Other

ATTACH ADDITIONAL INFORMATION, IF IT EXISTS.

**CERTIFICATION STATEMENT**

I, the undersigned, certify that this report is complete and accurate to the best of my knowledge and belief.

NAME WEEKS DRILLING AND PUMP COMPANY by Ward Thompson  
(PERSON, FIRM, OR CORPORATION) (TYPED OR PRINTED)  
P.O. Box 176 Sebastopol, CA 95473  
ADDRESS CITY STATE ZIP  
Signed Ward Thompson 1/26/2000 177681  
WELL DRILLER/AUTHORIZED REPRESENTATIVE DATE SIGNED C-57 LICENSE NUMBER