

Property Owner: Sullivan Waits
Site Address: 425 Bohemian Highway. Sebastopol, CA. 95472
APN: 073-120-030-000
Designer: DAVID GRANDA PERALES
Date: March 15, 2024

SCOPE OF WORK:
[1] NEW TESLA AC POWERWALL #3012170-XX-Y [SI1-SB]
[1] NEW TESLA BACKUP GATEWAY #1232100-XX-Y [CRD PCS]
[1] NEW EATON #DG221URB OR EQUIVALENT 30A DISCONNECT

Design Codes Used:
2022 California Electrical Code
2022 California Fire Code
2022 California Residential Code

Table of Contents:

- 1. TITLE SHEET
- 2. ELECTRICAL SCHEMATIC
- 3. PLAN VIEW
- 4. PLACARDS

REVISIONS				
ZONE	REV	DESCRIPTION	DATE	APPROVED

REVIEWED FOR
CODE COMPLIANCE
3/20/2024
Sean Stephens BLD24-1668
PERMIT SONOMA

Vicinity Map



RICHARD HEATH & ASSOCIATES C10 ELECTRICAL CONTRACTOR'S LICENSE #608302 <i>David Granda Perales</i>	PG&E-ESS POWERWALL INSTALLATION RICHARD HEATH & ASSOCIATES		DWG NAME TITLE PAGE	
	SULLIVAN WAITS RESIDENCE 425 BOHEMIAN HIGHWAY. SEBASTOPOL, CA. 95472 APN: 073-120-030-000			
David Granda Perales	SIZE B	FSCM NO.	DWG NO.	REV 0
3/19/2024	SCALE	NONE		SHEET 1 OF 4

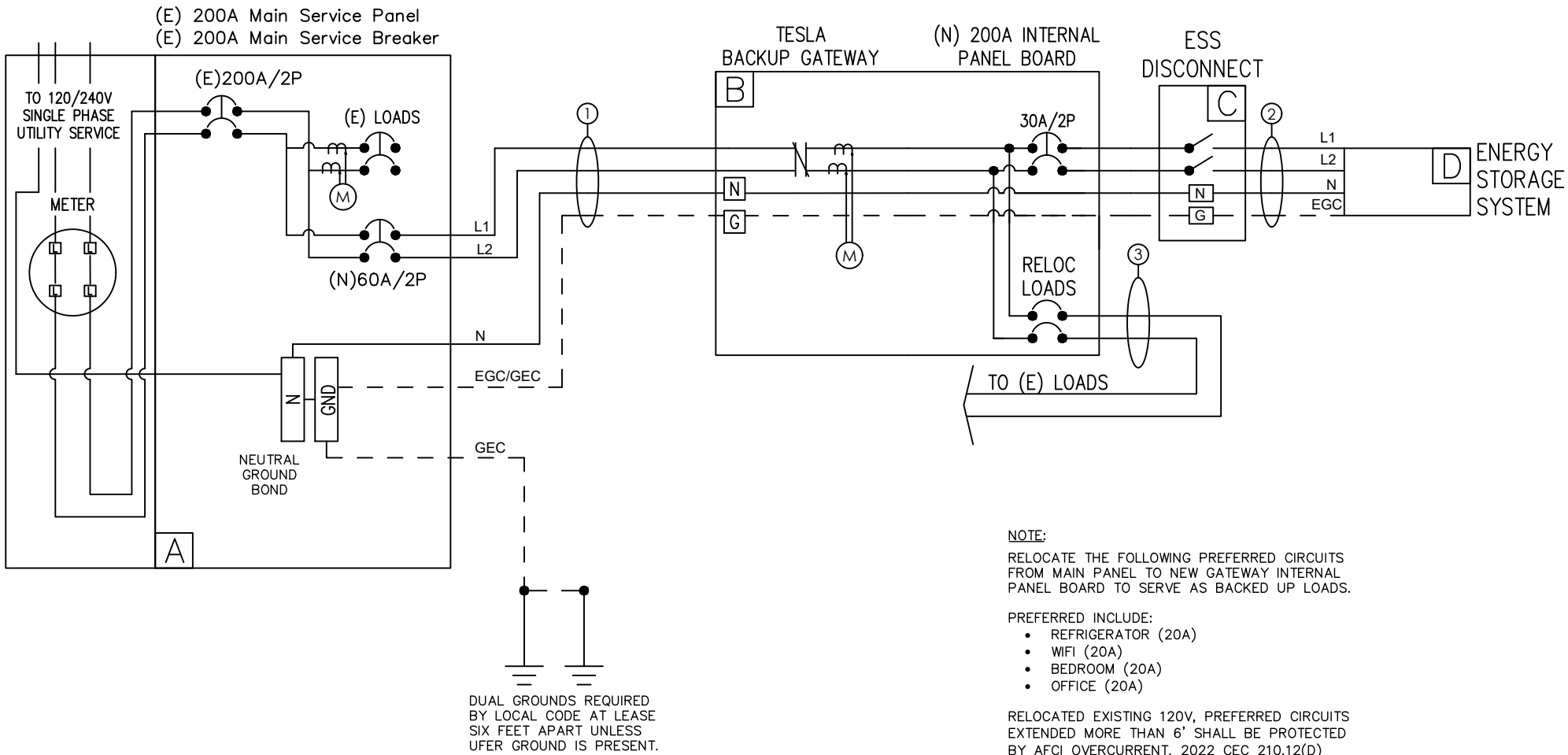

REVISIONS				
ZONE	REV	DESCRIPTION	DATE	APPROVED

EQUIPMENT LEGEND	
A	EXISTING 200A CROUSE-HINDS MAIN SERVICE PANEL #JA222CW 200A MAX. RATING.
B	NEW TESLA #1232100-XX-Y BACKUP GATEWAY 2 [CRD-PCS NON-EXPORT] ISOLATES SAFELY FROM THE GRID AND FEEDS THE HOUSE LOADS UPON GRID OUTAGE WITH NEW TESLA #1529623-01-C INTERNAL PANEL BOARD KIT 200A; 6 SPACES; 12 CIRCUITS <ul style="list-style-type: none">(1) 30 AMP CIRCUIT BREAKER 2 POLE; 240V; 2 SPACES(4) 20 AMP CIRCUIT BREAKER 1 POLE; 240V; 1 SPACES
C	NEW EATON 30A DISCONNECT #DG221URB OR EQUIVALENT
D	NEW TESLA #3012170-XX-Y 5 KW, 13.5 KWH, AC POWERWALL 2 [SI1-SB][CRD-PCS NON-EXPORT]

CONDUCTOR/CONDUIT LEGEND	
①	(3)AWG #6 CU THWN-2 (1)AWG #10 CU THWN-2 GND (1)EMT CONDUIT 1"
②	(3)AWG #10 CU THWN-2 (1)AWG #10 CU THWN-2 GND (1)COMMUNICATION WIRE SHIELD CARLO (R) 4 COND 16 AWG CU E2044S - 75C E60233-8 (UL) CL3R OR EQUAL (1)EMT CONDUIT 1"
③	EXISTING LOADS SHALL BE RELOCATED FROM THE (E) 100A MAIN SERVICE PANEL TO THE NEW GATEWAY'S 200A INTERNAL PANEL BOARD AND SHALL CONTAIN: [2] 20A/1P BREAKERS FOR ESSENTIAL LIGHTS/PLUGS [4] AWG #12 THWN-2 CONDUCTORS [1] EMT CONDUIT; 1"
M	NEW CURRENT TRANSFORMER PAIR P/N 1622277-00-X OR NEW REMOTE NEURIO W2 METER P/N 112484-04-X

- NOTES:
- PANEL LIMIT FEATURE FOR THE POWERWALL UNIT(S) TO BE UTILIZED. FIELD LABEL TO BE AT POINT OF INTERCONNECTION:
 - PCS CONTROLLED MAIN PANEL CURRENT SETTING IS 200A.
 - THE MAXIMUM OUTPUT CURRENT FROM THIS SYSTEM TOWARDS THE MAIN PANEL IS CONTROLLED ELECTRONICALLY. REFER TO MANUFACTURE"S INSTRUCTIONS FOR MORE CLARITY
 - INSPECTOR TO VERIFY BATTERY IS LOCATED A MINIMUM OF THREE FEET FROM ALL DOORS AND WINDOWS DIRECTLY ENTERING THE DWELLING UNIT.
 - RELOCATED EXISTING 120V 15 & 20 AMP CIRCUITS EXTENDED MORE THAN SIX FEET SHALL BE PROTECTED BY AFCI OVERCURRENT.
 - CA ELECTRICAL CODE 705.12 LOAD-SIDE SOURCE CONNECTIONS. THE OUTPUT OF AN INTERCONNECTED ELECTRIC POWER SOURCE SHALL BE PERMITTED TO BE CONNECTED TO THE LOAD SIDE OF THE SERVICE DISCONNECTING MEANS OF THE OTHER SOURCE(S) AT ANY DISTRIBUTION EQUIPMENT ON THE PREMISES. WHERE DISTRIBUTION EQUIPMENT OR FEEDERS ARE FED SIMULTANEOUSLY BY A PRIMARY SOURCE OF ELECTRICITY AND ONE OR MORE OTHER POWER SOURCE AND ARE CAPABLE OF SUPPLYING MULTIPLE BRANCH CIRCUITS OR FEEDERS, OR BOTH, THE INTERCONNECTING EQUIPMENT SHALL COMPLY WITH 705.12(A) THROUGH (E). WHERE A POWER CONTROL SYSTEM (PCS) IS INSTALLED IN ACCORDANCE WITH 705.13, THE SETTING OF THE PCS CONTROLLER SHALL BE CONSIDERED THE POWER-SOURCE OUTPUT CIRCUIT CURRENT IN 705.12(A) THROUGH (E).
 - CONDUIT/RACEWAY SHALL COMPLY WITH UL 870, TYPE 3R AND CSA C22.2 No. 26 CERTIFIED, TYPE 3R FOR OUTDOOR SERVICE. TYPE 1 FOR INDOOR SERVICE. EMT (CONDUIT) AND FITTINGS SHALL BE LISTED FOR THE INTENDED SERVICE AND SHALL BE INSTALLED IN ACCORDANCE WITH THE CALIFORNIA ELECTRICAL CODE.
 - CA ELECTRICAL CODE 705.10 DIRECTORY
 - A PERMANENT PLAQUE OR DIRECTORY DENOTING THE LOCATION OF ALL ELECTRIC POWER SOURCE DISCONNECTING MEANS ON OR IN THE PREMISES SHALL BE INSTALLED AT EACH SERVICE EQUIPMENT LOCATION AND AT THE LOCATION(S) OF THE SYSTEM DISCONNECT(S) FOR ALL ELECTRIC POWER PRODUCTION SOURCES CAPABLE OF BEING INTERCONNECTED. THE MARKING SHALL COMPLY WITH 110.21(B).

REVIEWED FOR
CODE COMPLIANCE
3/20/2024
Sean Stephens BLD24-1668
PERMIT SONOMA

RICHARD HEATH & ASSOCIATES C10 ELECTRICAL CONTRACTOR'S LICENSE #608302	PG&E-ESS POWERWALL INSTALLATION RICHARD HEATH & ASSOCIATES		DWG NAME ELECTRICAL SCHEMATIC	
	SULLIVAN WAITS RESIDENCE 425 BOHEMIAN HIGHWAY. SEBASTOPOL, CA. 95472 APN: 073-120-030-000			
David Granda Perales	SIZE B	FSCM NO.	DWG NO.	REV 0
3/19/2024	SCALE NONE		SHEET 2 OF 4	

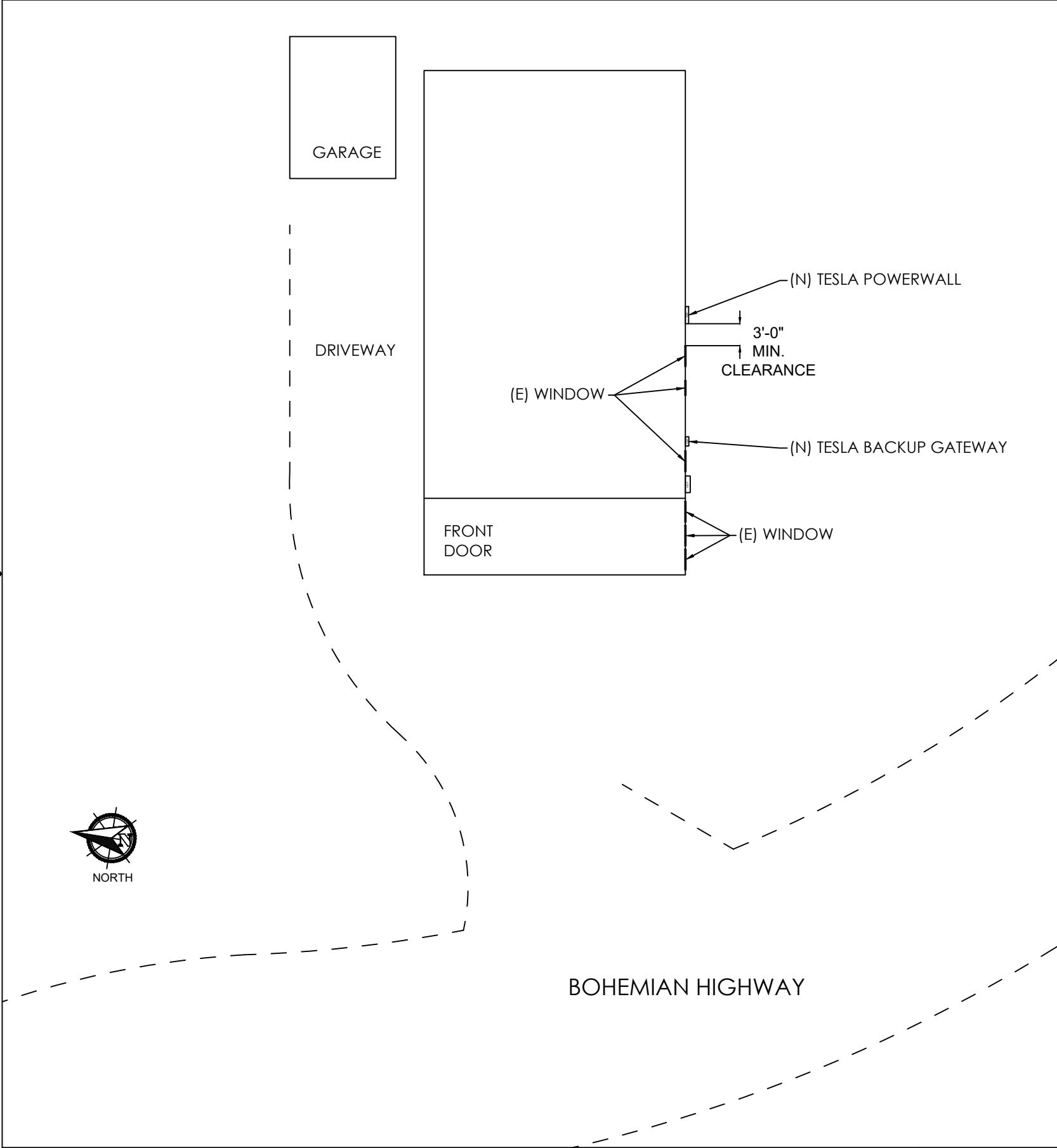

REVISIONS				
ZONE	REV	DESCRIPTION	DATE	APPROVED

- NOTES:
- INSPECTOR TO VERIFY BATTERY IS LOCATED A MINIMUM OF THREE FEET FROM ALL DOORS AND WINDOWS DIRECTLY ENTERING THE DWELLING UNIT.
 - A PERMANENT PLAQUE OR DIRECTORY DENOTING THE LOCATION OF ALL ELECTRIC POWER SOURCE. DISCONNECTING MEANS ON OR IN THE PREMISES SHALL BE INSTALLED AT EACH SERVICE EQUIPMENT LOCATION AND AT THE LOCATION(S) OF THE SYSTEM DISCONNECT(S) FOR ALL ELECTRIC POWER PRODUCTION SOURCES CAPABLE OF BEING INTERCONNECTED. THE MARKING SHALL COMPLY WITH 110.21(B).

REVIEWED FOR
CODE COMPLIANCE

3/20/2024

Sean StephensBLD24-1668

PERMIT SONOMA

RICHARD HEATH & ASSOCIATES C10 ELECTRICAL CONTRACTOR'S LICENSE #608302 <i>David Granda Perales</i>	PG&E-ESS POWERWALL INSTALLATION RICHARD HEATH & ASSOCIATES		DWG NAME PLAN VIEW	
	SULLIVAN WAITS RESIDENCE 425 BOHEMIAN HIGHWAY. SEBASTOPOL, CA. 95472 APN: 073-120-030-000			
David Granda Perales	SIZE B	FSCM NO.	DWG NO.	REV 0
3/19/2024	SCALE 1/4"=1'		SHEET 3 OF 4	

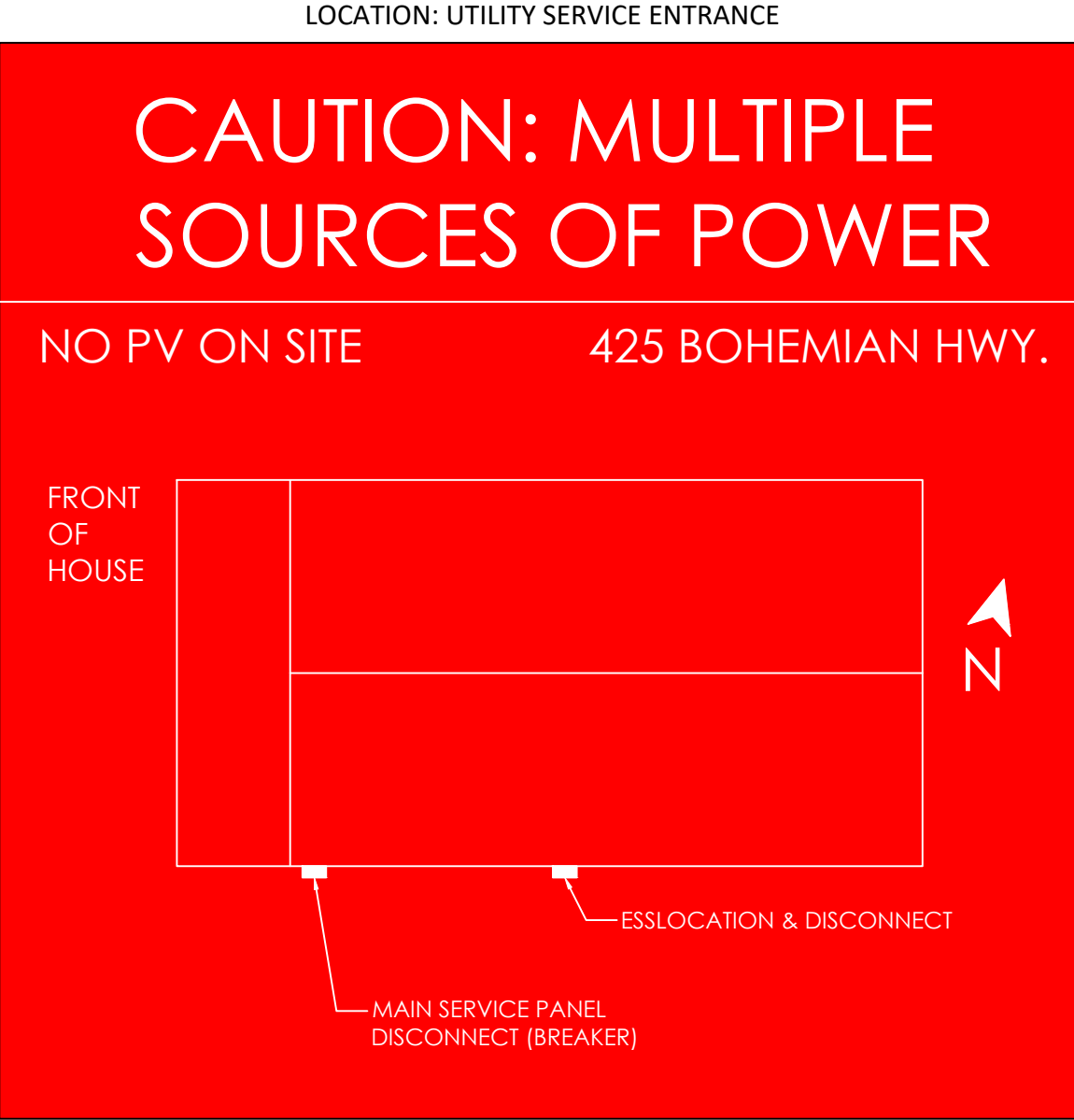

6" X 6" PLACARD WITH WHITE TEXT ON RED BACKGROUND

- NOTES:
- SIGNS SHALL BE RED BACKGROUND WITH WHITE LETTERING
 - SIGNS SHALL BE WEATHERPROOF AND SUITABLE FOR THE ENVIRONMENT THEY ARE INSTALLED.
 - LETTERING SHALL BE A MINIMUM LETTER HEIGHT OF 3/8" PERMANENTLY AFFIXED.
 - A PERMANENT PLAQUE DENOTING THE LOCATION OF ALL ELECTRIC POWER SOURCE. DISCONNECTING MEANS ON OR IN THE PREMISES SHALL BE INSTALLED AT EACH SERVICE EQUIPMENT LOCATION AND AT THE LOCATION(S) OF THE SYSTEM DISCONNECT(S) FOR ALL ELECTRIC POWER PRODUCTION SOURCES CAPABLE OF BEING INTERCONNECTED. THE MARKING SHALL COMPLY WITH 110.21(B).
 - PLACARDS SHALL INCLUDE EFFECTIVE COLORS FOR SAFETY SIGNS AND LABELS AS DICTATED BY Z535.4-2011

REVISIONS				
ZONE	REV	DESCRIPTION	DATE	APPROVED

WARNING

DUAL POWER SOURCES

SECOND SOURCE IS ENERGY STORAGE

WARNING

POWER SOURCE OUTPUT CONNECTION.

DO NOT RELOCATE THIS OVERCURRENT DEVICE

DISCONNECT INSIDE

ENERGY STORAGE SYSTEM DISCONNECT

PCS CONTROLLED CURRENT SETTING: 200A

THE MAXIMUM OUTPUT CURRENT FROM THIS SYSTEM TOWARDS THE MAIN PANEL IS CONTROLLED ELECTRONICALLY. REFER TO MANUFACTURER'S INSTRUCTIONS FOR MORE INFORMATION.

WARNING: THIS SENSOR IS PART OF POWER CONTROL SYSTEM. DO NOT REMOVE. REPLACE ONLY WITH THE SAME TYPE AND RATING

REVIEWED FOR CODE COMPLIANCE

3/20/2024

Sean StephensBLD24-1668

PERMIT SONOMA

RICHARD HEATH & ASSOCIATES C10 ELECTRICAL CONTRACTOR'S LICENSE #608302 <i>David Granda Perales</i>	PG&E-ESS POWERWALL INSTALLATION RICHARD HEATH & ASSOCIATES		DWG NAME PLACARDS	
	SULLIVAN WAITS RESIDENCE 425 BOHEMIAN HIGHWAY, SEBASTOPOL, CA. 95472 APN: 073-120-030-000			
David Granda Perales	SIZE B	FSCM NO.	DWG NO.	REV 0
3/19/2024	SCALE	NONE		SHEET 4 OF 4