



County of Sonoma
Permit and Resource Management Department
 2550 Ventura Avenue Santa Rosa, CA 95403-2829
 Phone: (707) 565-1900 Fax: (707) 565-1103

Permit Number
ENC24-0228

To request an inspection, call (707) 565-3551 (5 days advance notice recommended)

Refunds will not be authorized unless circumstances comply with established PRMD refund policy provisions.

Project Address: 17132 Bodega Ln Bodega Bay [BBY] **Issue Date:** 8/14/2024
APN: 103-120-019 **To Expire:** 8/14/2027
Description: Traffic control while exterior renovations (BLD23 -6524) are completed on existing house near ROW.
County Road: Bodega Ln **Road Nbr:** 60007 **Postmile:** 10.08

Applicant:
 Enguerrand Guilloux & Jennifer Cash
 17132 Bodega Ln
 Bodega, CA 94922
 707-710-0287

Contractor:
 GARY HOWARD CONSTRUCTION
 10400 DEBLYN LANE
 SEBASTOPOL, CA 95472
 707-829-8307 Lic#: 654420

Fee Item	Fee Description	Account Code	Total Fee
0140-000	Technology Enhancement	26010104-45321-10005	\$5.86
0706-000	Office Review - Engineering Permit Clearance	26010111-45061-10005	\$115.00
0420-100	Encroachment Inspection - Minor Work within ROW	26010111-45171_3323-	\$278.00
0740-000	NPDES - Encroachment	26010112-45061-10005	\$58.00
Total Fees:			\$456.86
Total Paid:			\$456.86
Balance Due:			\$0.00

Permittee agrees to accept all responsibility for loss or damage to any person or entity and to indemnify, hold harmless, and defend and release County of Sonoma, its agents, and employees from and against any and all liability actions, claims, damages, costs, or expenses which may be asserted by any person or entity, including Permittee, arising out of or in connection with the willful act or negligence of Permittee performing the work associated with this Encroachment Permit, whether or not there is concurrent negligence on the part of the County, but excluding liability due to the sole active negligence or sole willful misconduct of County.

PERMITTEE AGREES THAT THE WORK ACTIVITY OR EVENT WILL BE CONDUCTED IN ACCORDANCE WITH AND SUBJECT TO THIS PERMIT'S TERMS AND CONDITIONS, THE STATE VEHICLE CODE, THE STATE STREETS AND HIGHWAYS CODE AND IS SUBJECT TO INSPECTION AND APPROVAL.

This permit is to be strictly construed and no work other than that specifically monitored below is authorized hereby. County of Sonoma reserves the right to revoke permit should they conclude the work does not comply with the provisions of this permit. Subject to all the terms, conditions and restrictions written hereon or attached hereto, permission is hereby granted Permittee to:

- ATTACHMENTS: Standard Conditions Signing
 Standard Drawings Permit Plans
 Driveway Provisions Traffic Control Plans
 Backfill Rock from Approved Source

PLAN CHECK APPROVED

By: Susan Milliron
 Susan Milliron Date
 Engineering Technician

**APPROVED FOR
 ENCROACHMENT**
 August 14, 2024

Susan Milliron
 STAFF

SONOMA PUBLIC INFRASTRUCTURE

ENCROACHMENT PERMIT – SUPPLEMENTAL CONDITIONS

1. Work performed on County maintained roads will be conducted by the permit holder named on the issued permit documentation or their subcontractor.
2. During working hours, one lane of traffic shall be maintained in all directions. Adequate flagger control is required. Directional traffic needs to alternate every 3 minutes, max. All emergency vehicles have the right-of-way. Delays lasting longer than 20 minutes require notification to RedCom (707) 568-5933. At all other times all traffic lanes shall be kept open.
3. No new or recently overlaid streets (within the last five years) shall not be open cut without prior permission from the Sonoma Public Infrastructure (SPI). Pavement Cut Moratorium Map
4. No opening or entering of any Sonoma Water sanitation sewers or maintenance holes is allowed without first contacting Sonoma Water two (2) days prior to entering maintenance holes. A separate traffic control plan must be provided to Permit Sonoma when entering any sanitation sewer or maintenance holes.
 - Contact Danny Colvin - Danny.Colvin@scwa.ca.gov
5. Any trench plating in the public right-of-way, must include the use of CA MUTCD sign W8-24, “Steel Plate Ahead” for traffic control.
6. Permanent paving shall be completed no later than **five working days** after backfill. Unless an extension has been granted in conformance with the Sonoma Public Infrastructure approved "Pavement Restoration Schedule" 219A - Pavement Cut Policy, 219B – Trench Backfill and Paving Details, and 219C Pavement Cut Policy at intersections. All fill must be obtained from approved source list (attached).
 - SPI - Soils Material Lab must be notified of work site location and confirm pavement mix, five (5) days prior to paving restoration.
 - Contact Victor Hayes (707) 565 - 2025
7. All work within 500ft of traffic signals or traffic loop are subject to notification and approval from SPI Traffic Division. The work shall be coordinated at least five (5) days in advance of the start of work by calling (707) 565- 3620. After normal working hours shall be coordinated by calling the Sonoma County Sheriff dispatch at (707) 565-2121 and requesting the on-call SPI foreman be contacted.
8. *Conservation of Survey Monumentation*: The permittee shall upon completion of construction activity insure that any survey monuments that have been destroyed, damaged, covered, disturbed, or otherwise obliterated are reset, or a witness monument or monuments set to perpetuate that original location of the effected monuments as stated in Section 8771(c) of the California Professional Land Surveyors Act.



Standards for Construction Activity Within the County Road Right-of-Way

Note: Approval from PRMD Engineering Construction Inspection Staff must be granted prior to commencing any work in the County Right-of-Way. Approval shall be requested by scheduling a “Start Work Notice (Item 240)” using the automated inspection system at (707) 565-3551. Failure to obtain approval to start work will result in penalty fees and/or permit revocation.

I. General

- a. *Acceptance of the terms of the encroachment permit:* It is understood and agreed by the Permittee that performance of any work authorized by the encroachment permit shall constitute acceptance of all of the terms, provisions, and conditions of the permit and its attachments. Failure to comply with any of terms, provisions, or conditions of the permit and its attachments may result in penalty fees, permit revocation, and/or direction to immediately cease work and vacate the County Road Right-of-Way.
- b. *Standards:* Work shall comply with the latest edition of the State Specifications of the State of California Department of Transportation, County of Sonoma Transportation and Public Works Standards, or other standards and specifications as approved by the permit or its attachments.
- c. *Control of Work:* All work and all materials used to complete the work authorized by the encroachment permit shall be subject to the inspection and approval of the Inspector. Such inspection and approval of the work and materials shall not relieve the Permittee of any of their obligations to complete the work in conformance with all applicable specifications. Work and materials not meeting these requirements shall be rejected. If determined to be unsuitable, work and materials may be rejected even if previously inspected and approved by the Inspector.
- d. *Access to Work:* The Inspector shall have access to the work at all times to determine that the methods, materials and workmanship are in accordance with the terms of the encroachment permits and all applicable specifications. The Inspector may reject defective work and shall require its repair, replacement, or removal by the Permittee.
- e. *Permit On-Site:* The encroachment permit and all of its attachments shall be kept at the job site and must be made immediately available to the Inspector or any law enforcement officer upon demand.
- f. *Trench Permit:* The Permittee shall obtain a trench permit from the California Division of Industrial Safety prior to the excavation of any trench over five feet in depth.
- g. *Other Authorization:* When required, it is the Permittee’s responsibility to ensure that all approval(s) have been obtained by other required jurisdictions.
- h. *Restoration of Right-of-Way:* Upon completion of the construction activity, the right-of-way shall be restored to as good as or better than its pre-construction condition. The permit shall not be finalized until the Inspector is satisfied that the right-of-way has been adequately restored. It is the responsibility of the Permittee to photograph and/or video the right-of-way affected by the work prior to beginning construction, and to make available said photograph(s) and/or video(s) to the Inspector before commencing work. If no such photograph(s) and/or videos are available, the right-of-way shall be assumed to have been in good condition and shall be restored as directed by the Inspector.

- i. *Storage of Material and Equipment:* Unless allowed by the Inspector, no material or equipment shall be stored within ten (10) feet from the edge of the traveled way.
- j. *Approval of Work:* The inspector shall approve all work at the completion of each of the following stages of work and such approval must be obtained before subsequent stages of work may be commenced. The Permittee shall call the automated inspection system at (707) 565-3551 and use the codes provided on the green Engineering Division Permit Inspection Record (job card) to request inspection and/or approval to proceed.
 - 1. Earthwork:
 - Construction of embankments, excavations.
 - Excavation for storm drains and culverts.
 - Preparation of subgrade
 - Back-filling of structures and pipes and public utilities.
 - 2. Concrete work:
 - Construction of forms, for all concrete structures, including curbs, gutters, and sidewalks.
 - Placing of concrete in structures, including curbs, gutters, and sidewalks.
 - 3. Drainage facilities:
 - Placing of storm drains and culvert pipes.
 - Construction of roadside ditches and other drainage ways
 - 4. Roadway construction:
 - Placing and compacting of base material. If more than one course or type of base or sub-base is to be used, approval shall be necessary for each course and/or type.
 - Placing of pavement or surfacing.
 - 5. Final clean-up.
- k. *Additional Work or Facilities:* The Inspector may require additional work or facilities in the course of the construction of the project in order for the improvements to reasonably provide for the intended function or for public safety.
- l. *Maintenance and Repair:* The Permittee agrees by the acceptance of the encroachment permit to exercise reasonable care in properly maintaining any encroachment placed by the Permittee. The Permittee shall exercise reasonable care in inspecting and immediately repairing any damage to any portion of the road right-of-way which occurs as a result of the work done under the encroachment permit. If the Permittee does not repair existing road facilities, County crews may perform the repair work at their cost plus 100% for administration and overhead. The Permittee is responsible for paying the County for these costs within 30 days of receipt of invoice from the County.
- m. *Permit Revocation:* All encroachment permits are subject to revocation for failure to comply with the any of the conditions contained herein, or as deemed necessary by the Inspector for the protection of public safety or the protection of the County road right-of-way.
- n. *Future Removal or Relocation:* In the event of the future improvement of the County road right-of-way necessitating the relocation or removal of the encroachment(s) permitted herein, the permittee shall relocate or remove the same at their sole expense. In such event, written notice shall be served on the permittee specifying the work required and specifying a time within which the work of relocation or removal shall be commenced and completed.
- o. *Conflicting Construction:* When this permit authorizes work that occurs in the vicinity of a County

project, the work conducted under this permit shall be coordinated with the Sonoma County Department of Transportation and Public Works so as not to cause any conflict with said County project, or the encroachment permit shall be revoked.

- p. *Ownership of Land in County Road Right-of-Way:* In many instances, the County does not own the underlying fee of the land in the County road right-of-way; its interest is limited to an easement only. In all such cases, it is the responsibility of the Permittee to obtain the consent of the owner or owners of the underlying fee before undertaking any below surface operations. (Note: Public Utility companies are afforded certain underground rights in the public road right-of-way by State law.)
- q. *Underground Service Alert (U.S.A.) Notification:* The Permittee shall be responsible for notifying U.S.A. Call toll-free (800) 642-2444 at least two working days prior to excavation. The Permittee shall uncover existing buried utilities with utility owner to verify locations and elevations of utilities. Buried utilities include but are not limited to: water, sewer, electrical, gas, cable, and telephone.
- r. *Cultural Resources:* In the event cultural resources (i.e., historical, archaeological, and paleontological resources and human remains) are discovered during grading or other construction activities, work shall be halted within a 100 foot radius of the find. The Northwest Information Center shall be notified at (707) 664-0880. A qualified archeologist shall be consulted for an on-site evaluation. Additional mitigation may be required by the County per the archeologist's recommendations. If human burials or human remains are encountered, the contractor shall also notify the County Coroner at (707) 565-5070.
- s. *Hazardous Materials:* Should hazardous materials, or apparent hazardous materials, be discovered during the course of work, work in the affected area shall be stopped immediately. Emergency Services, or the appropriate agency, and the Inspector shall be immediately notified.
- t. *Existing Striping and Pavement Markings:* All existing striping and pavement markings disturbed by construction activity shall be replaced in kind and shall be approved by the Encroachment Inspector or by the Sonoma County Traffic Engineering Department Inspector.
- u. *Existing Public Signs:* Relocation or removal of existing public signs shall not occur until approval has been obtained by the Inspector.
- v. *Precedent:* This permit is granted with the understanding that this action is not to be considered as establishing any precedent on the expediency of permitting or establishing any precedence on the permitting of a certain kind of encroachment within the County road right-of-way.
- w. *Conflict with Approved Plans:* If this permit contains a set of approved Encroachment plans and a conflict exists between the approved plans and these notes, the more restrictive shall prevail, or the Inspector may determine which is appropriate.

II. Liability

- a. *Liability for Damages:* Permittee agrees to accept all responsibility for loss or damage to any person or entity and to indemnify, hold harmless, and defend and release the County of Sonoma, its agents and employees of and against any and all liability, actions, claims, damages, costs or expenses which may be asserted by any person or entity, including Permittee, arising out of or in connection with the willful act or negligence of Permittee performing the work associated with this Encroachment Permit, whether or not there is concurrent negligence on the part of the County.

III. Traffic Control

- a. *Traffic Control Plan:* Permittee shall provide and install all traffic control devices per the CA Supplement to the Manual of Uniform Traffic Control Devices (CA MUTCD) Typical Applications, or as otherwise required on the approved traffic control plan issued as an attachment to the encroachment permit.
- b. *Traffic Control Approval:* No construction activity shall commence until traffic control at the job site has been approved by the Inspector.
- c. *Other Authorization:* Where applicable, the Permittee shall obtain approval from any other jurisdictions necessary to place traffic control devices in their rights-of-way, or shall obtain permission from any applicable entity for the placement of traffic control devices outside of the County of Sonoma's right-of-way.
- d. *Lane of Travel:* One ten foot (10') wide lane shall be kept open at all times, unless otherwise approved by the Inspector or permitted by the approved traffic control plan.
- e. *Flaggers:* Flaggers shall be required per the CA MUTCD, the approved traffic control plan, or at the Inspector's discretion as necessary to protect public safety.
- f. *Pedestrians and Cyclists:* Permittee shall provide for and protect pedestrian and cyclist traffic per the CA MUTCD Typical Applications, the approved traffic control plan, or per the Inspector's direction. Where pedestrian or cyclist traffic is permitted to pass through the work zone, the Permittee shall provide them an appropriate escort.

IV. Backfill and Paving

- a. *Trench Backfill and Paving:* All trenching in the right-of-way shall conform to Sonoma County Transportation and Public Works Standard Drawing 219, unless otherwise specified on the encroachment permit, the attached approved plans, or as otherwise approved by the Inspector.
- b. *Trench Stability:* If the trench is not stable, remedial work may be required and the Permittee shall be responsible for submitting a proposal to address any unstable trench conditions.
- c. *Compaction Testing:* The Permittee shall hire individuals certified to perform testing in accordance with Caltrans' test method No. 216 Part II or ASTM 1557, and shall provide those test results to the Inspector. As an alternative to testing, the use of the County approved cement backfill (also known as CDF or CLSM) shall be used.
- d. *Compaction Requirements:* The subgrade, Class II Aggregate Base, and AC shall be compacted to 95% relative compaction.
- e. *Minimum Depths:* Underground utilities shall be located per the utility company or agency's standards, but in no case shall they be located any shallower than is allowed by Sonoma County Transportation and Public Works Standard Drawing 219.
- f. *Driveway Trench Crossings:* Trench backfill within driveway crossings shall conform to Sonoma County Transportation and Public Works Standard Drawing 804.

- g. *Temporary Patching*: Any trench within the paved roadway left without final paving shall have cold patch material added at the end of each day. The Permittee, at their expense, shall continually maintain the cold patch, as directed by the Inspector, until the final pavement is placed. Temporary paving shall be completely removed prior to the final paving.
- h. *Paving Provisions*: Permittee shall restore the roadway to as good as or better than its pre-construction condition, as noted in the following:
 - 1. The Permittee shall restore the roadway to its pre-construction condition. Any pavement cracked, broken or damaged by the Permittee during construction shall be replaced or repaired to the satisfaction of the Inspector. This requirement does not preclude the overlaying (in kind) of the entire roadway if deemed necessary by the Inspector.
 - 2. The Permittee shall remove a minimum of 18 inches of existing asphalt between the edge of the trench and the existing edge of pavement or between the edge of the trench and existing lip of the gutter before placing the new asphalt.
- i. *Liquid Anti-Stripping Agent (LAS)*: LAS shall be added to the asphalt binder at a rate of 0.5% by weight of asphalt binder. The LAS shall be AD-here LOF 65-00 or equivalent, and shall be stored, measured, and blended with the asphalt binder in accordance with the anti-stripping agent manufacturer's recommended practice. The LAS can be added at the asphalt plant or at the refinery. When added at the asphalt plant, the equipment shall indicate and record the amount of LAS added. If added at the refinery, the shipping ticket from the refinery shall certify the type and amount of LAS added.
- j. *Final Paving*: Unless otherwise approved by the Inspector, final paving shall be applied no later than ten (10) working days after traffic is allowed to pass over the work area.

V. Work Hours

- a. *Work Hours*: Work shall generally be permitted from 7:00AM - 7:00PM, but shall not begin earlier than one half hour after sunrise or end later than one half hour before sunset, unless otherwise noted in the special conditions of the encroachment permit or as approved by the Inspector.
- b. *Weekends, Nights, and Holidays*: No work shall be performed during weekends, nights, or holidays unless authorized by the Inspector or the special conditions of the encroachment permit.

VI. Public Safety

- a. *Excavations*: In addition to any other measures taken by the Permittee pursuant to the provisions of the Standard Specifications, Section 7-1.09, "Public Safety", the Contractor shall install temporary K-railing between any lane carrying public traffic and any excavation when the near edge of the excavation is 12 feet (12') or less from the edge of the lane, except for:
 - 1. Excavations covered with non-skid steel plates of adequate thickness to prevent accidental entry by traffic or the public.
 - 2. Excavations less than one foot (1') deep.
 - 3. Trenches less than one foot (1') wide for irrigation pipe or electrical conduit or excavations less than one foot (1') in diameter.
 - 4. Excavations in side slopes where the slope is less than 4:1.
 - 5. Excavations protected by an existing barrier or K-railing.

- b. *Elevation of Pavement:* At the end of each working day if a difference in excess of 0.15 feet exists between the elevation of the existing pavement and the elevation of any excavation within 8 feet of the traveled way, material shall be placed and compacted against the vertical cuts adjacent to the existing pavement at a maximum 4:1 slope.
- c. *Trench Plates:* Trench plates placed in areas whereupon vehicles will travel shall be non-skid steel plates and shall be secured with temporary asphaltic concrete and/or pins as necessary to the Inspector's satisfaction.

VIII. Drainage

- a. *Care of Drainage:* Drainage shall not be impaired. If the work permitted herein interferes with drainage, the Permittee shall make ample accommodations as necessary to satisfy the Inspector.
- b. *Maintenance of Drainage:* The Permittee shall maintain drainage throughout the work area. Such maintenance shall include, but is not limited to, keeping all culverts and inlets clean and open.

IX. Removal or Trimming of Roadside Trees

- a. *Removal of Trees:* When a permit is issued for removal of a tree, as part of the project, the entire stump shall be taken out to a depth of at least two feet (2') below the ground surface, unless otherwise specified in the permit. The hole left by the stump shall be backfilled, and compacted. The site shall be approved by the Inspector.
- b. *Trimming of Trees:* Tree trimming shall be limited to branches up to two inches (2") in diameter unless otherwise specified by the permit. Scars resulting from trimming shall be appropriately treated.

X. Erosion Prevention and Sediment Control

- a. Perform erosion prevention and sediment control in accordance with Chapter 11 Grading, Drainage, and Vineyard and Orchard Site Development.
- b. Work shall conform to the erosion prevention and sediment control best management practices contained in the latest editions of the following publications or an equivalent best management practice:

Erosion and Sediment Control Field Manual, San Francisco Bay Regional Water Quality Control Board
Manual of Standards for Erosion & Sediment Control Measures, Association of Bay Area Governments
Construction Site Best Management Practices Manual, Caltrans
Stormwater Best Management Practice Handbook, CA Stormwater Quality Association.
- c. If discrepancies occur between these notes, material referenced herein or manufacturer's recommendations, then the most protective shall apply.
- d. The Permittee is responsible for obtaining and complying with the National Pollutant Discharge Elimination System (NPDES) General Permit No. Cas000002 Waste Discharge Requirements for discharges of storm water runoff associated with construction activity disturbing land equal to or greater than one acre. Construction activities include but are not limited to clearing, grading, excavation, stockpiling, and reconstruction of existing facilities involving removal and replacement.
- e. Preservation of existing vegetation shall occur to the maximum extent practicable.

- f. The Permittee is responsible for preventing storm water pollution generated from the construction site year round. The owner must implement an effective combination of erosion prevention and sediment control on all disturbed areas during the rainy season (October 15 - April 15).
- g. Erosion prevention and sediment control measures shall be inspected by the Permittee before forecasted storm events and after actual storm events to ensure measures are functioning properly. Storm events produce at least 1 inch of precipitation in a 24 hour period. Erosion prevention and sediment control measures that have failed or are no longer effective shall be promptly replaced. Erosion prevention and sediment control measures shall be maintained until disturbed areas are stabilized.
- h. Changes to the erosion prevention and sediment control plan may be made to respond to field conditions. Changes shall be noted on the plan when made.
- i. Discharges of potential pollutants from construction sites shall be prevented using source controls to the maximum extent practicable. Potential pollutants include but are not limited to: sediment, trash, nutrients, pathogens, petroleum hydrocarbons, metals, concrete, cement, asphalt, lime, paint, stains, glues, wood products, pesticides, herbicides, chemicals, hazardous waste, sanitary waste, vehicle or equipment wash water and chlorinated water.
- j. Entrance(s) to the construction site shall be maintained in a condition that will prevent tracking or flowing of potential pollutants offsite. Potential pollutants deposited on paved areas within the County road right-of-way, such as roadways and sidewalks, shall be properly disposed of at the end of each working day or more frequently as necessary.
- k. Exposed slopes shall be protected by using erosion prevention measures to the maximum extent practicable, such as establishing 70% vegetation coverage, hydroseeding, straw mulch, geotextiles, plastic covers, blankets or mats.
- l. Hydroseeding shall be conducted in a three step process. First, evenly apply seed mix and fertilizer to the exposed slope. Second, evenly apply mulch over the seed and fertilizer. Third, stabilize the mulch in place.

Applications shall be broadcasted mechanically or manually at the rates specified below. Seed mix and fertilizer shall be worked into the soil by rolling or tamping. If straw is used as mulch, straw shall be derived from wheat, rice or barley and be approximately 6 to 8 inches in length. Stabilization of mulch shall be done hydraulically by applying an emulsion or mechanically by crimping or punching the mulch into the soil. Equivalent methods and materials may be used only if they adequately promote vegetation growth and protect exposed slopes.

Materials	Application Rate (Pounds per Acre)
Seed Mix	
Bromus mollis (Blando Brome)	40
Trifolium hirtum (Hykon Rose Clover)	20
Fertilizer	
16-20-0 & 15% Sulphur	500
Mulch	
Straw	4000
Hydraulic Stabilizing (Non-asphaltic, derived from plants)	
M-binder or Sentinel	75-100
Equivalent Material	Per Manufacturer

- m. Whenever it is not possible to utilize erosion prevention measures, exposed slopes shall employ sediment control devices, such as fiber rolls and silt fences. Fiber rolls and silt fences shall be trenched and keyed into the soil and installed on contour. Silt fences shall be installed approximately 2 to 5 feet from toe of slope.
- n. The Permittee shall protect storm drain inlets from potential pollutants until drainage conveyance systems are functional and construction has been completed.
- o. Energy dissipaters shall be installed at storm drain outlets which may convey storm water flow leading to soil erosion.
- p. Soil and material stockpiles shall be properly protected to minimize sediment and pollutant transport from the construction site.
- q. Solid waste, such as trash, discarded building materials and debris, shall be placed in designated collection areas or containers. The construction site shall be cleared of solid waste daily, or as necessary, and regular removal and proper disposal shall be arranged.
- r. A concrete washout area, such as a temporary pit, shall be designated to clean concrete trucks and tools. At no time shall concrete products and waste be allowed to enter county waterways such as creeks or storm drains.
- s. Proper application, cleaning and storage of potentially hazardous materials, such as paints and chemicals, shall be conducted to prevent the discharge of pollutants.
- t. When utilized, temporary restrooms and sanitary facilities shall be located and maintained to prevent the discharge of pollutants.
- u. Appropriate vehicle storage, fueling, maintenance and cleaning areas shall be designated and maintained to prevent discharge of pollutants.

Traffic Control Plan

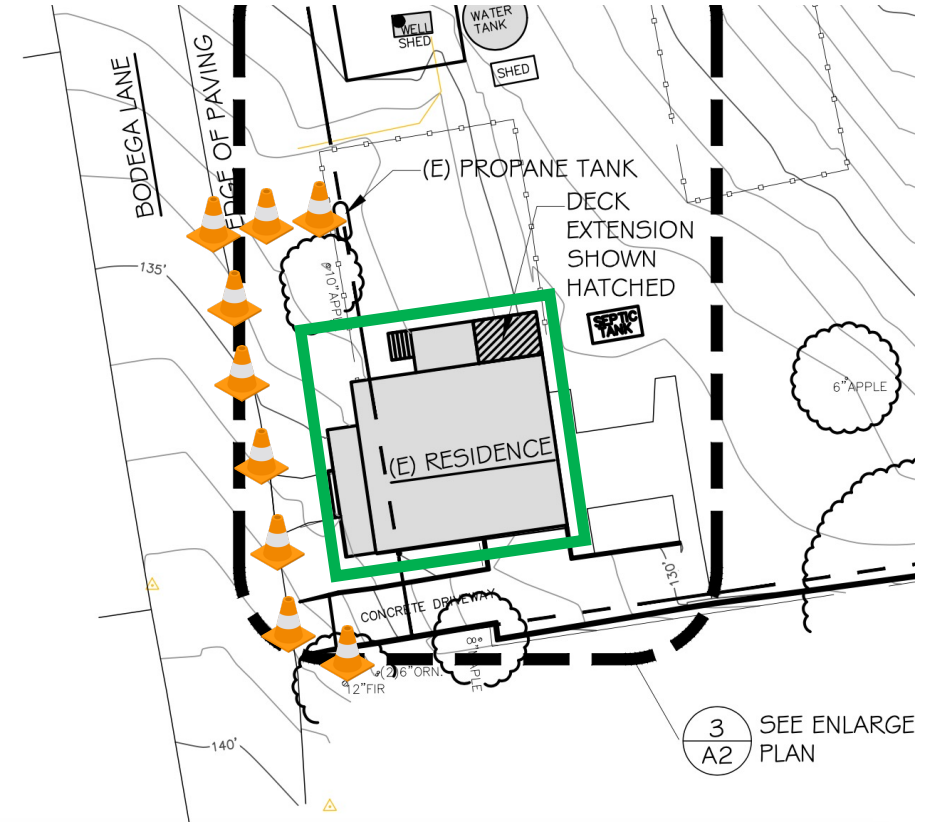

Notes:

- Traffic cones shall be placed along the edge of the road from the corner of the property to the apple tree located on the edge of the property line.
- Traffic cone to remain in place until the new foundations have been poured

Legend:

APPROVED FOR
ENCROACHMENT
August 14, 2024
Susan Milliron
STAFF

Traffic Cones



Working area

