

State of California
Well Completion Report
Form DWR 188 Submitted 07/16/2025
WCR2025-007206

Owner's Well Number: WW2

Date Work Began: 06/16/2025

Date Work Ended: 06/19/2025

Local Permit Agency: Sonoma County Permit & Resource Management Department

County: Sonoma

Secondary Permit Agency:

Permit Number: WEL24-0451

Permit Date: 02/19/2025

Well Owner (must remain confidential pursuant to Water Code 13752)	Planned Use and Activity
Name: <u>Dylan Morris</u>	Activity: <u>New Production or Monitoring Well</u>
Address: <u>126 Brush Street</u>	Planned Use: <u>Water Supply</u>
City: <u>Graton</u> State: <u>California</u> Zip: <u>95444</u>	Water Supply: <u>Domestic</u>

Well Location		
Address: <u>126 Brush ST</u>		APN: <u>130-161-007</u>
City: <u>Graton</u> Zip: <u>95444</u>		Township: <u>07N</u> Range: <u>09W</u>
Latitude: <u>38 Deg. 26 Min. 8.1744 Sec. N</u>	Longitude: <u>-122 Deg. 52 Min. 0.66 Sec. W</u>	Section: <u>21</u> BM: <u>Mount Diablo</u>
Dec. Lat. : <u>38.435604</u>	Dec. Long. : <u>-122.86685</u>	Ground Surface Elevation:
Vertical Datum:	Horizontal Datum:	Elevation Accuracy:
Location Accuracy: <u>5 Ft</u>	Location Determination Method:	Elevation Determination Method:

Borehole Information	Water Level and Yield of Completed Well
Orientation: <u>Vertical</u> # of casings (Specify): <u>1</u>	Depth to first water: <u>(Feet below surface)</u>
Drilling Method: <u>Direct Rotary</u> Drilling Fluid: <u>Bentonite</u>	Depth to Static Water Level: <u>20 (Feet)</u>
Total Depth of Boring: <u>165 Feet</u>	Date Measured: <u>06/19/2025</u>
Total Depth of Completed Well: <u>160 Feet</u>	Estimated Yield*: <u>25 (GPM)</u> Test Type: <u>Air Lift</u>
	Test Length*: <u>3 (Hours)</u> Total Drawdown: <u>110 (Feet)</u>
	*May not be representative of a well's long term yield.

Geologic Log - Free Form		
Depth from Surface (Feet to Feet)		Description
0	3	Topsoil
3	8	Orange clayey sand
3	8	Orange clayey sand
8	40	Dense blue clayey sand
40	165	Blue sandstone, fractured with some blue sand

Casings										
Casing #	Depth from Surface (Feet to Feet)		Casing Type	Material	Casings Specifications	Wall Thickness (inches)	Outside Diameter (inches)	Screen Type	Slot Size if any (inches)	Description
1	0	95	Blank	PVC	OD: 5.563 in. SDR: 21 Thickness: 0.265 in.	0.265	5.563			
1	95	155	Screen	PVC	OD: 5.563 in. SDR: 21 Thickness: 0.265 in.	0.265	5.563	Milled Slots	0.02	
1	155	160	Blank	PVC	OD: 5.563 in. SDR: 21 Thickness: 0.265 in.	0.265	5.563			

Annular Material					
Depth from Surface (Feet to Feet)		Fill	Fill Type Details	Filter Pack Size	Description
0	6	Bentonite	Non Hydrated Bentonite		Seal
6	52	Bentonite	High Solids		Seal
52	165	Filter Pack	12 x 20		Sand

Other Observations:

Borehole Specifications		
Depth from Surface (Feet to Feet)		Borehole Diameter (inches)
0	165	11

Certification Statement			
I, the undersigned, certify that this report is complete and accurate to the best of my knowledge and belief.			
Name:		<u>WEEKS DRILLING AND PUMP CO</u>	
Person, Firm or Corporation			
<u>PO BOX 176</u>	<u>SEBASTOPOL</u>	<u>California</u>	<u>94573-0176</u>
Address	City	State	Zip
Signed: <u>electronic signature received</u>		<u>07/16/2025</u>	<u>177681</u>
C-57 Licensed Water Well Contractor		Date Signed	License Number

DWR Use Only

CSG #	State Well Number	Site Code	Local Well Number
N	W		
Latitude Deg/Min/Sec		Longitude Deg/Min/Sec	

TRS:

APN:

Attachments

- **130-161-012.pdf** - Location Map

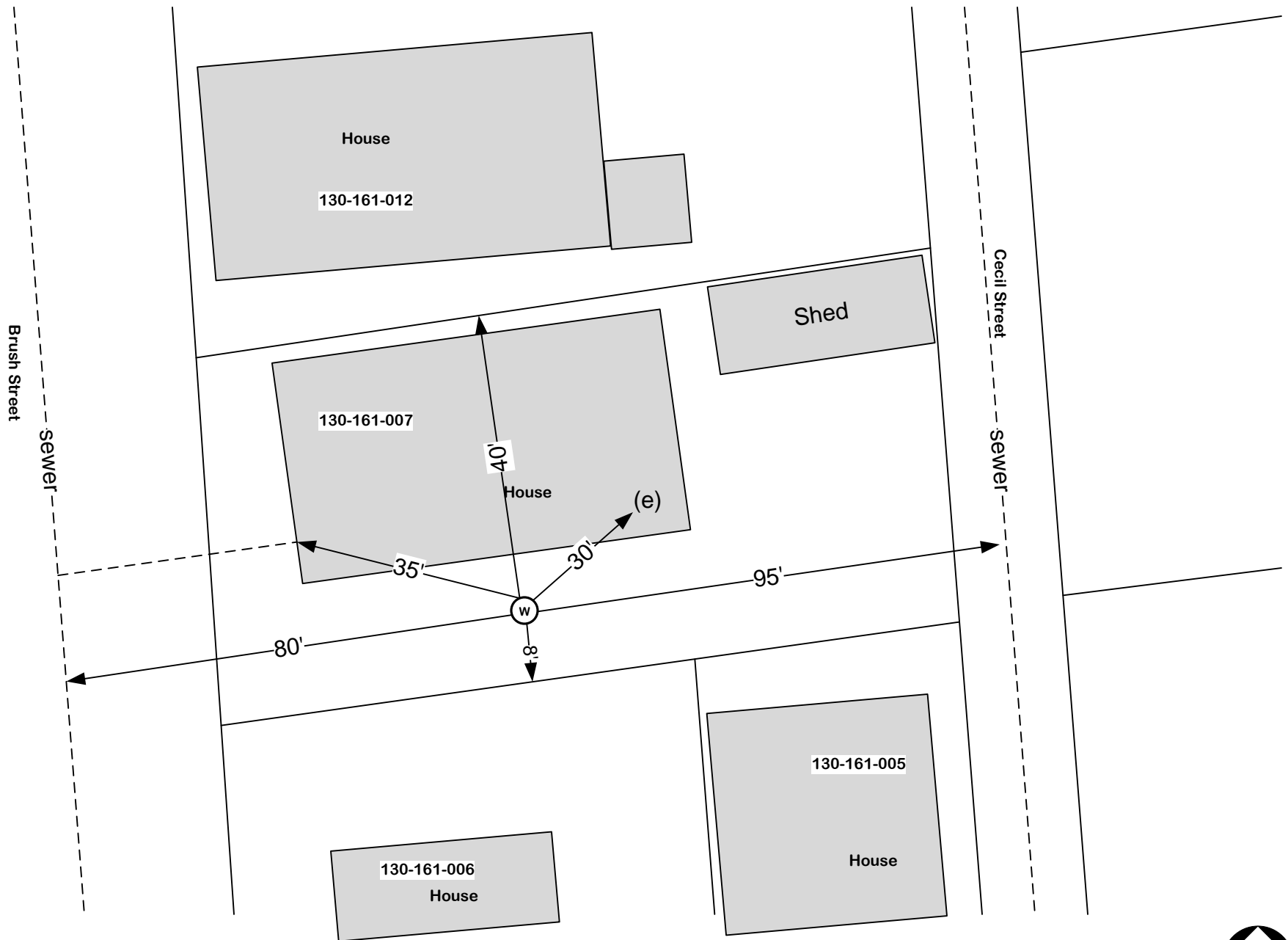

Project: New Well for primary water use on property
Existing well: to remain in place as backup
Owner: Dylan Morris
Contact: 707-536-7974

- Ⓢ New Well
- (e) Existing Well
- ▨ Leach Area
- ⊞ Septic Tank
- Sewer

New Well 38° 26.136'N 122° 52.012'W



TITLE	126 BRUSH ST GRATON, CA 95444	DESCRIPTION	North
DATE	December 16, 2024	PAGE	New Well
		Page 1	