

State of California
Well Completion Report
Form DWR 188 Submitted 09/18/2025
WCR2025-009352

Owner's Well Number: WW2 **Date Work Began:** 09/02/2025 **Date Work Ended:** 09/09/2025
Local Permit Agency: Sonoma County Permit & Resource Management Department **County:** Sonoma
Secondary Permit Agency: **Permit Number:** WEL25-0050 **Permit Date:** 02/21/2025

Well Owner (must remain confidential pursuant to Water Code 13752)	Planned Use and Activity
Name: <u>Bloomfield Ranch Estates LLC</u> Address: <u>P.O. Box 318205</u> City: <u>San Francisco</u> State: <u>California</u> Zip: <u>94127</u>	Activity: <u>New Production or Monitoring Well</u> Planned Use: <u>Water Supply</u> Water Supply: <u>Domestic</u>

Well Location		
Address: <u>6400 Cockrill ST</u> City: <u>Petaluma</u> Zip: <u>94952</u>	APN: <u>027-100-026</u>	Township: <u>06N</u> Range: <u>09W</u>
Latitude: <u>38 Deg. 19 Min. 2.8344 Sec. N</u> Dec. Lat. : <u>38.317454</u>	Longitude: <u>-122 Deg. 51 Min. 10.4688 Sec. W</u> Dec. Long. : <u>-122.852908</u>	Section: <u>33</u> BM: <u>Mount Diablo</u> Ground Surface Elevation: Elevation Accuracy: Elevation Determination Method:
Vertical Datum: Location Accuracy:	Horizontal Datum: Location Determination Method:	

Borehole Information	Water Level and Yield of Completed Well
Orientation: <u>Vertical</u> # of casings (Specify): <u>1</u> Drilling Method: <u>Direct Rotary</u> Drilling Fluid: <u>Bentonite</u> Total Depth of Boring: <u>300 Feet</u> Total Depth of Completed Well: <u>300 Feet</u>	Depth to first water: <u>(Feet below surface)</u> Depth to Static Water Level: <u>10 (Feet)</u> Date Measured: <u>09/08/2025</u> Estimated Yield*: <u>30 (GPM)</u> Test Type: <u>Air Lift</u> Test Length*: <u>3 (Hours)</u> Total Drawdown: <u>285 (Feet)</u> *May not be representative of a well's long term yield.

Geologic Log - Free Form		
Depth from Surface (Feet to Feet)		Description
0	4	Soft brown soil
4	12	Brown silty sand, clayey
12	17	Tan sandy clay
17	24	Blue green clayey sand
24	55	Dense silty sandstone
55	70	Dense silty sandstone with occasional hard zones

Depth from Surface (Feet to Feet)		Description
70	75	Hard sandstone with petrified wood
75	114	Blue sand sandstone
114	118	Sandstone ledge with shells
118	190	Blue sandstone with occasional ledges of harder sandstone
190	225	Blue green clayey sandstone
225	230	Harder ledges
230	300	Dense blue sandstone with harder ledges

Casings										
Casing #	Depth from Surface (Feet to Feet)		Casing Type	Material	Casings Specifications	Wall Thickness (inches)	Outside Diameter (inches)	Screen Type	Slot Size if any (inches)	Description
1	0	250	Blank	PVC	OD: 5.563 in. SDR: 21 Thickness: 0.265 in.	0.265	5.563			
1	250	290	Screen	PVC	OD: 5.563 in. SDR: 21 Thickness: 0.265 in.	0.265	5.563	Milled Slots	0.032	
1	290	300	Blank	PVC	OD: 5.563 in. SDR: 21 Thickness: 0.265 in.	0.265	5.563			

Annular Material					
Depth from Surface (Feet to Feet)		Fill	Fill Type Details	Filter Pack Size	Description
0	30	Bentonite	Non Hydrated Bentonite		Seal
30	300	Filter Pack	12 x 20		Sand & 3/8 Pea Gravel

Other Observations:

Borehole Specifications		
Depth from Surface (Feet to Feet)		Borehole Diameter (inches)
0	20	14
20	300	11

Certification Statement			
I, the undersigned, certify that this report is complete and accurate to the best of my knowledge and belief.			
<u>WEEKS DRILLING AND PUMP CO</u>			
Name: Person, Firm or Corporation			
<u>PO BOX 176</u>	<u>SEBASTOPOL</u>	<u>California</u>	<u>94573-0176</u>
Address	City	State	Zip
Signed: <u>electronic signature received</u>		<u>09/18/2025</u>	<u>177681</u>
C-57 Licensed Water Well Contractor		Date Signed	License Number

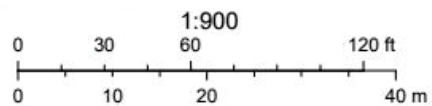
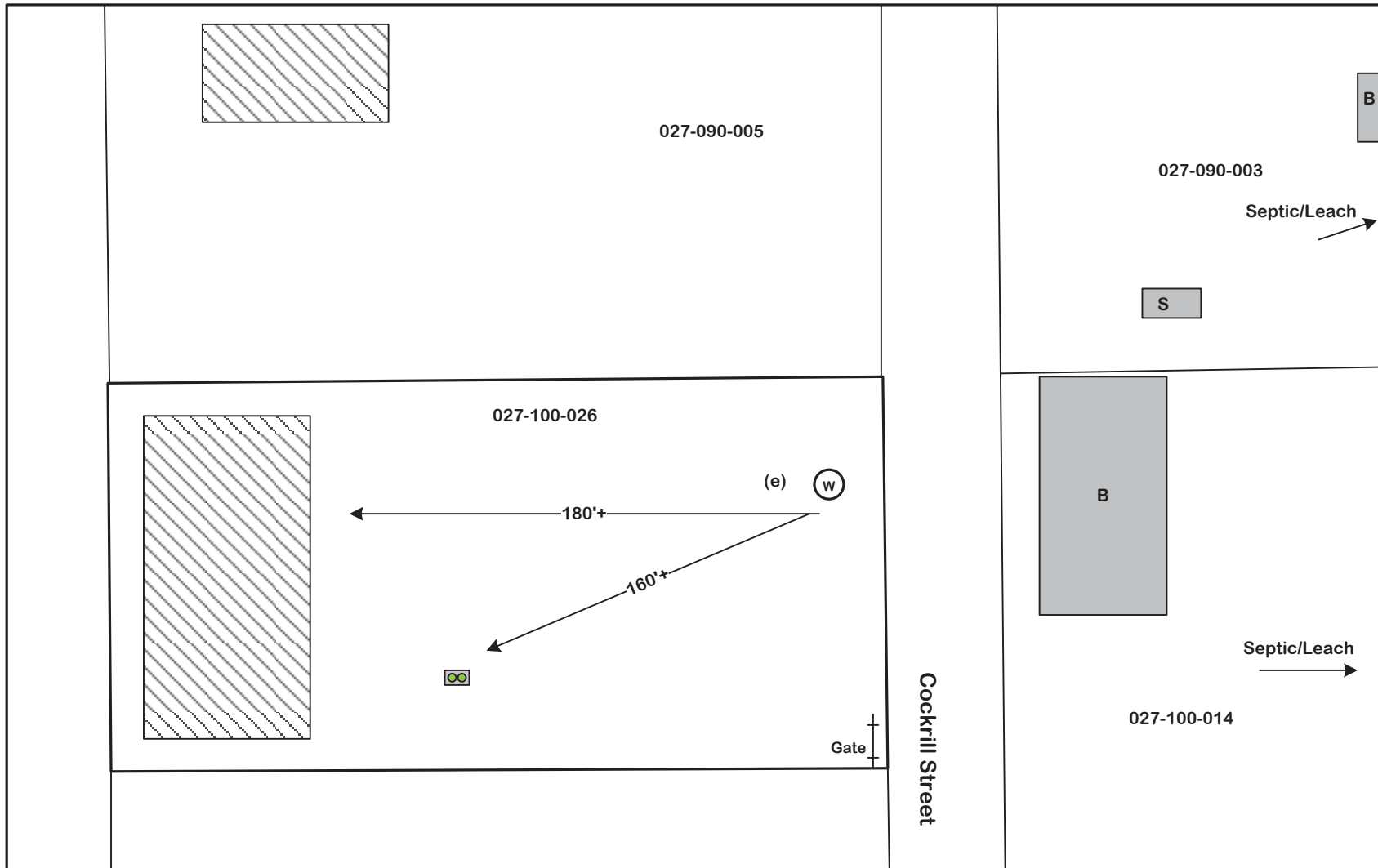

Well Site
 - 24' in from East PL
 - 45' in from North PL
 - 18' from existing well

GPS:

New Well 38.317454° / -122.852908°

(e) Well 38.317453° / -122.852977°

- New Well
- Existing Well
- Leach Area
- Septic Tank



WEEKS
 Drilling & Pump Company
 CL #177681 (707) 823-3184

TITLE 6400 Cockrill Street Petaluma, Ca	DESCRIPTION New Domestic Well
DATE February 20, 2025	PAGE 1 of 1